

3M™ Crimplok™+ Connector 8700 APC SM 250/900 μm

Quick Reference Guide

Safety Precautions

| Protective Eyewear | Chemical Precautions | Bare Fiber Handling |
|--|--|---|
| ⚠ CAUTION | ⚠ CAUTION | ⚠ CAUTION |
| Safety glasses should be worn when handling chemicals and cleaving the optical fiber. | Storage, use and disposal of isopropyl alcohol and methanol-water solution should be per your company health, safety and environmental instructions. Refer to Safety Data Sheet (SDS) for health hazards, safe handling, proper use and control measures. | Cleaved glass fibers are sharp and can pierce the skin. Use tweezers when handling shards and dispose of them properly per your company health and safety instructions. |
| Fiber Cable Handling | Laser Safety | |
| NOTICE | ⚠ CAUTION | |
| Optical fiber can be damaged by excessive tensile, compressive and bending forces. Consult the manufacturer's specifications for proper handling instructions. | Take the proper precautions when working with optical fiber because invisible laser light may be present. The principal laser hazard when working with fiber optics is injury to the eye. Never look directly into the end of a fiber or connector using the naked eye, a view scope or a microscope when connected to a laser source. | |

1 Use new lapping film only for every connector.

Apply and center lapping film to orange pad.



2

Spray distilled water 2X on lapping film

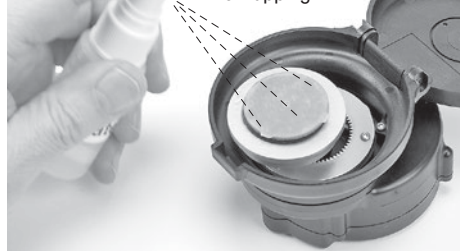

3

Tool shown is set for 900 μ m fiber. For 250 μ m fiber rotate fiber holder pad to the 250 mark.



4

Insert 3M™ Crimplok™+ Connector with cap faced up.



5

Hold Crimplok+ connector in place with thumb and rotate lever back down to seat connector and set cap to right.

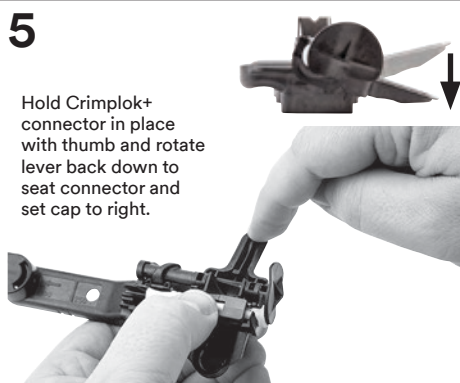

6

Ensure cap is aligned all the way to the right

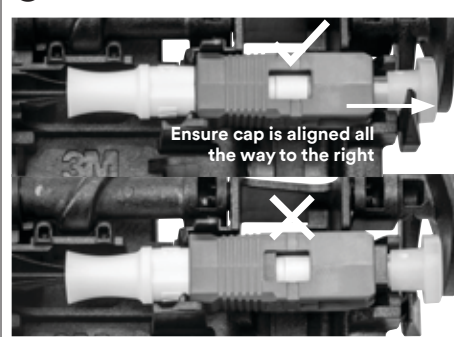

7

Strip fiber 40 mm

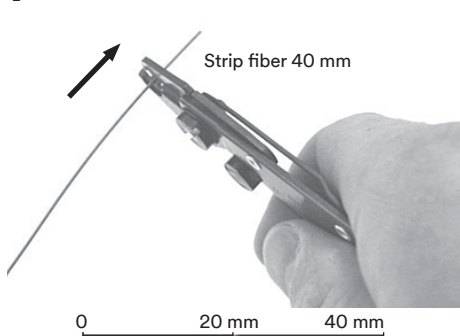

8

Test fiber to ensure no nick damage.

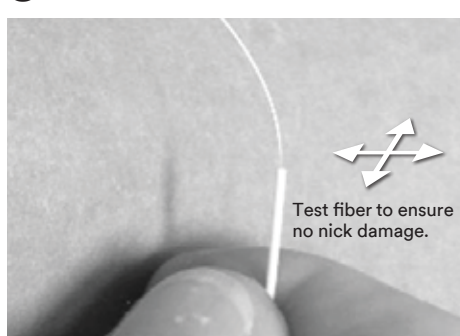

9

IPA or cleaner

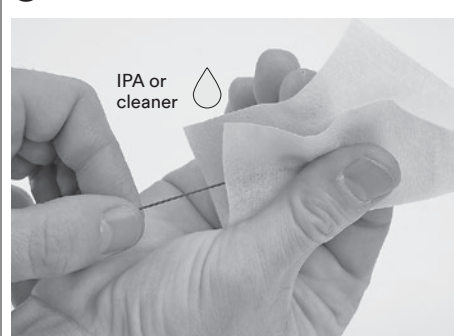

10

(Upper groove) 900 μ m coating edge, 24 mm cleave length

(Lower groove) 250 μ m coating edge, 19 mm cleave length

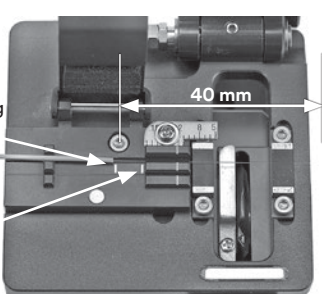

11

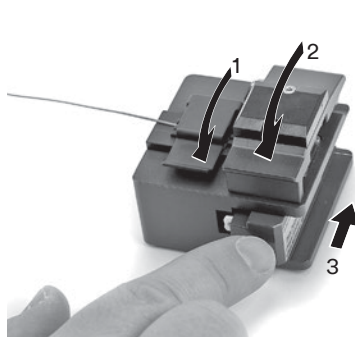

12

Optional - place mark on buffer at edge of cleaver.

Refer to next page if Non-Isintech Cleaver is used.

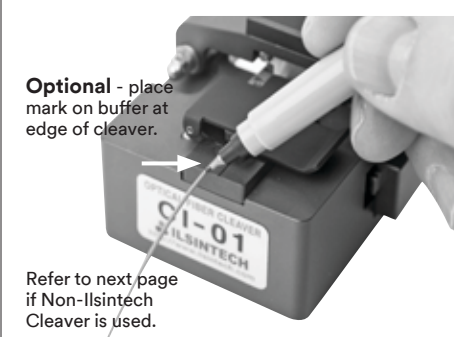

13

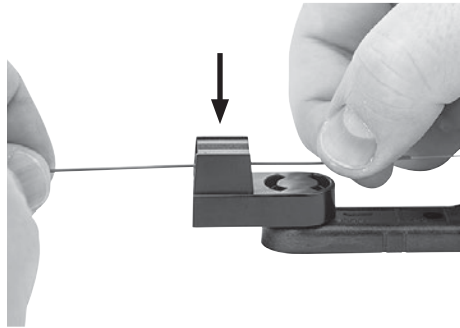

14

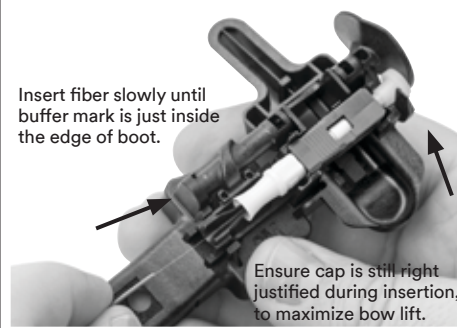

15

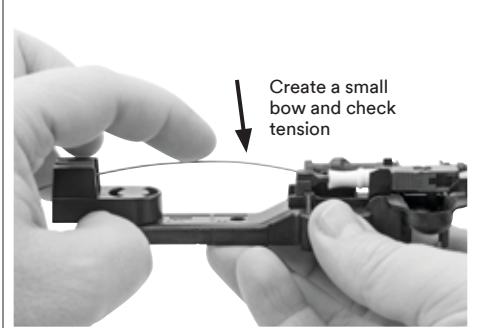

16

If bow lift or mark movement has not occurred by this position, remove fiber, check fiber cleaver length.



17a

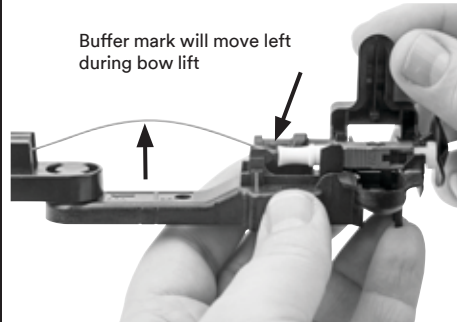

17b

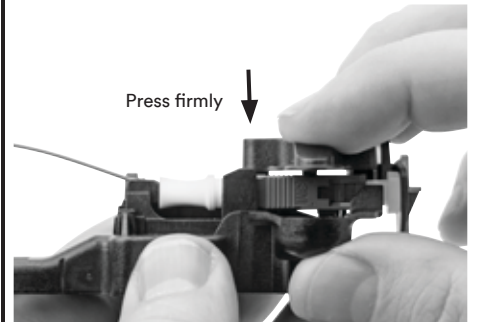

18

Top image activated, bottom image not activated

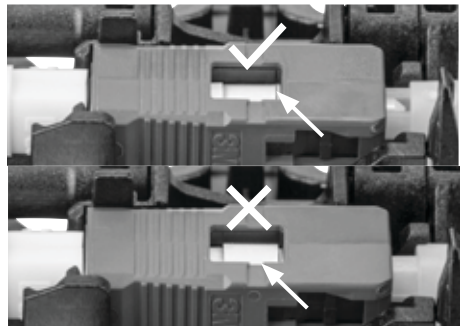

19

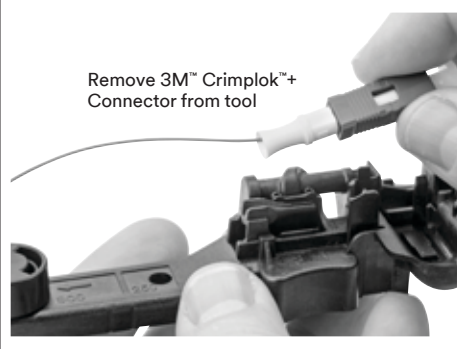

20

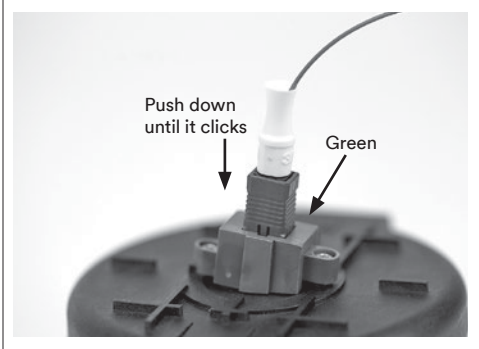

21

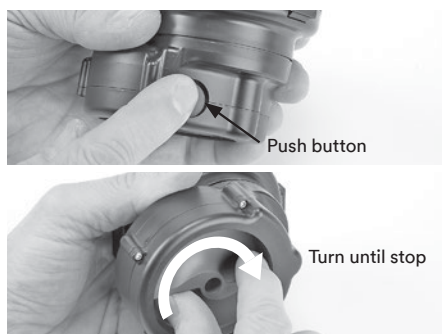

22

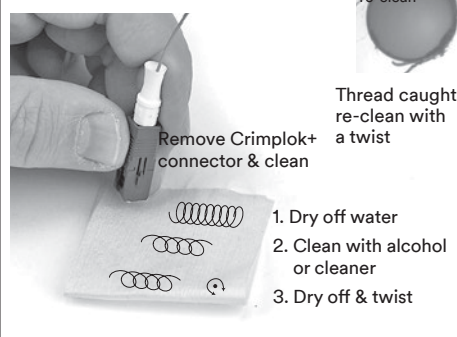

23

When using "one click" style cleaners, dry water off connector end face to absorb water.

Cleaning connector end face "AFTER" nano-finishing is critical to good performance.

Caution reminder: Never look directly into the end of a fiber or connector when connected to a laser light source using the naked eye or a microscope.



Ideal clean fiber end face



Fiber is missing, cut off connector. Go to step 3 with new connector and restart the termination process.

Allowable residual cleaver nick is 1/4 the fiber diameter (towards the center) after nano-finishing.

When using a non Ilseintech cleaver – an additional mark should be placed on cleaver beyond the 24 mm cleave mark. This mark should be 21 mm after the 24 mm mark as shown.

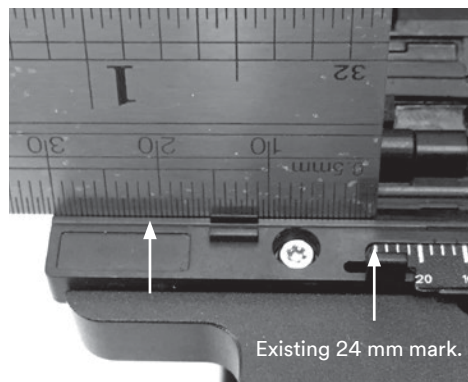

Measure an additional 21 mm away from the existing 24 mm mark.

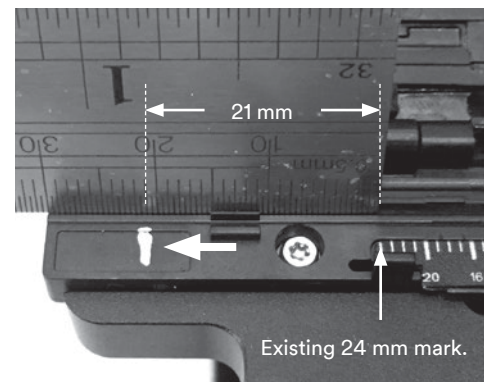

Place mark on cleaver as shown.

3M and Crimplok are trademarks of 3M Company.

Important Notice

All statements, technical information, and recommendations related to 3M's products are based on information believed to be reliable, but the accuracy or completeness is not guaranteed. Before using this product, you must evaluate it and determine if it is suitable for your intended application. You assume all risks and liability associated with such use. Any statements related to the product which are not contained in 3M's current publications, or any contrary statements contained on your purchase order shall have no force or effect unless expressly agreed upon, in writing, by an authorized officer of 3M.

Warranty; Limited Remedy; Limited Liability.

This product will be free from defects in material and manufacture for a period of one (1) year from the time of purchase. **3M MAKES NO OTHER WARRANTIES INCLUDING, BUT NOT LIMITED TO, ANY IMPLIED WARRANTY OF MERCHANTABILITY OR FITNESS FOR A PARTICULAR PURPOSE.** If this product is defective within the warranty period stated above, your exclusive remedy shall be, at 3M's option, to replace or repair the 3M product or refund the purchase price of the 3M product. Except where prohibited by law, 3M will not be liable for any direct, indirect, special, incidental or consequential loss or damage arising from this 3M product, regardless of the legal theory asserted.

3M

Communication Markets Division

6801 River Place Blvd.
Austin, TX 78726-9000

Phone 1-800-426-8688
Web www.3M.com/Telecom

Please recycle. Printed in USA © 3M 2017.
All rights reserved. 78-0015-3873-1-C