

RelyX™ Unicem 2 Automix

(en) Self-adhesive Resin Cement

(de) Selbstadhäsiver Composite-Befestigungszement

Please refer to the Instructions for Use – especially for Adhesive Bridges.
Bitte Gebrauchsinformation beachten – speziell bei Adhäsivbrücken.



Metal – Composite – Ceramic

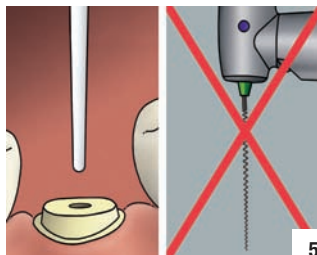
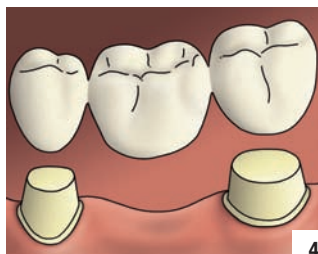

Cementation of a Restoration

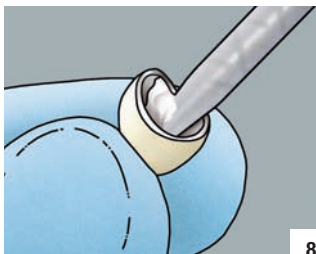
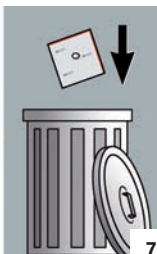
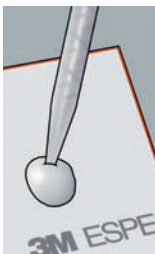
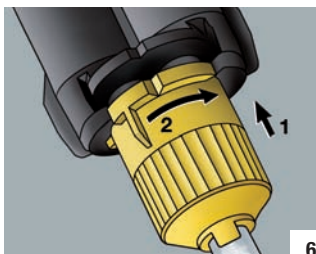
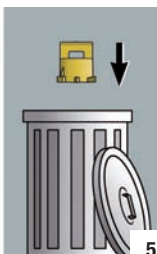
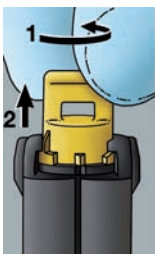
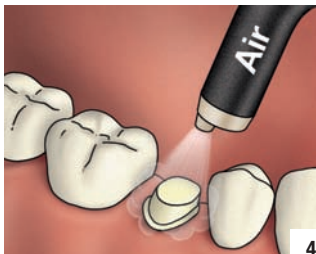
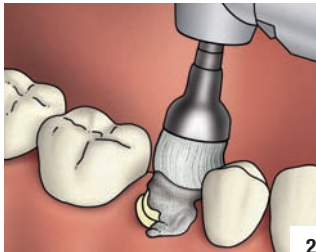
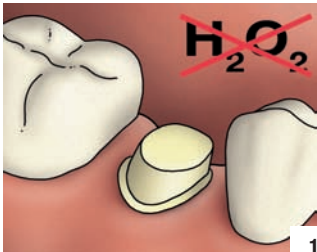

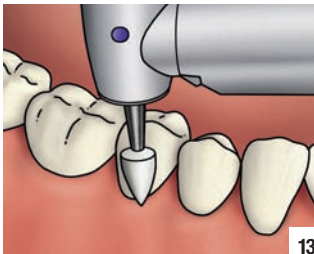
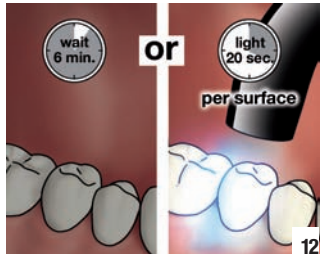
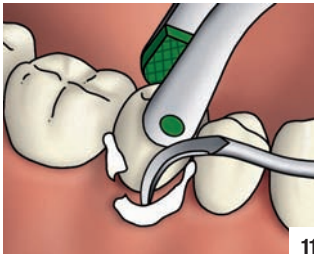
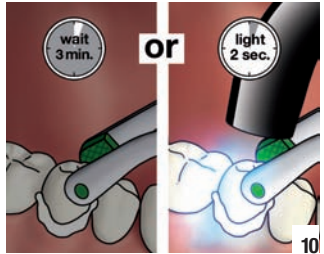
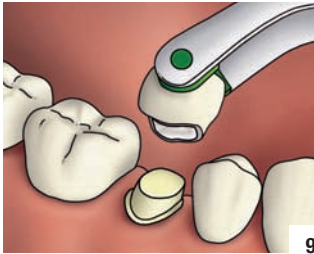

Fiber Post Cementation

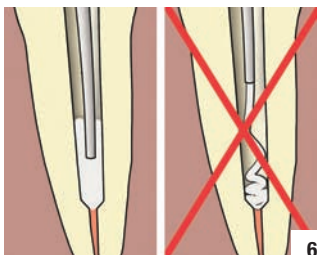
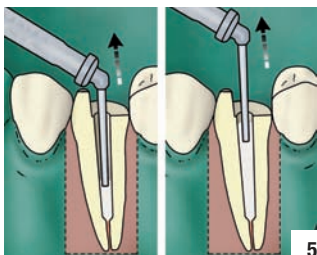
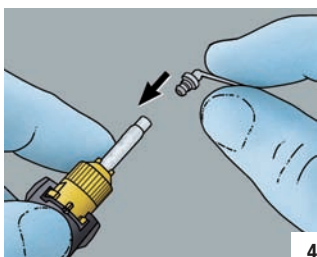
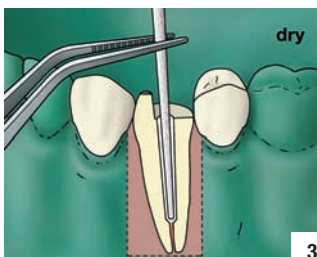
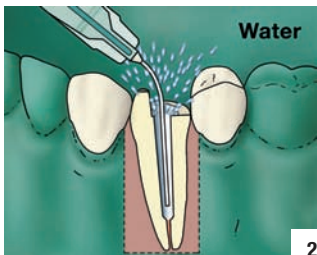
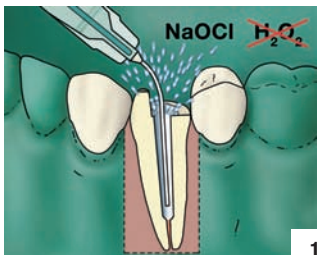

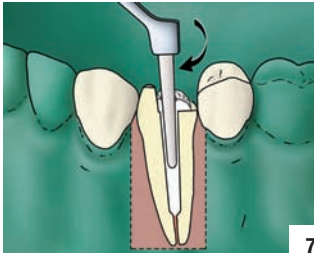

7

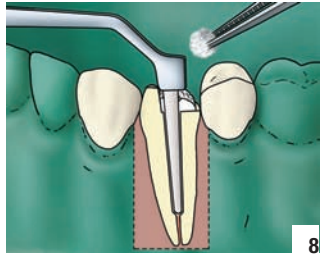

8

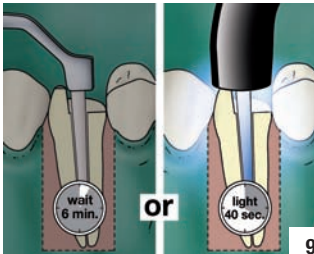

9

3M ESPE



3M ESPE AG
Dental Products
82229 Seefeld – Germany

3M ESPE
Dental Products
St. Paul, MN U.S.A. 55144-1000



44000759140/01
(February 2010)