



Scotch-Weld™ Polyurethane Reactive Adhesive Applicator Replacement Part Installation Guide

Description:	ON/OFF SWITCH KIT
Product ID/Stock No.:	62-9895-0024-4
For use with:	3M™ Scotch-Weld™ Polyurethane Reactive Adhesive Applicator Serial Nos. US 00100 and above Serial Nos. JA 00100 and above

Important Safety Instructions

⚠ WARNING

Avoid contact with the insulation wrap surrounding the heat tube. Avoid any acts that would generate dust particles. The ceramic fiber material may be harmful if inhaled. May cause skin, eye and respiratory tract irritation.

⚠ WARNING

Disconnect air and electrical power and make sure applicator has cooled to room temperature before servicing. Failure to follow these precautions **may cause electrical shock or burns.**

IMPORTANT

The service procedure shown in this installation guide should be performed only by qualified electrician or service person.

Refer to 3M™ Scotch-Weld™ Polyurethane Reactive Adhesive Applicator User's Manual for more information.

Read the manual completely before servicing the applicator.

Installation Guide

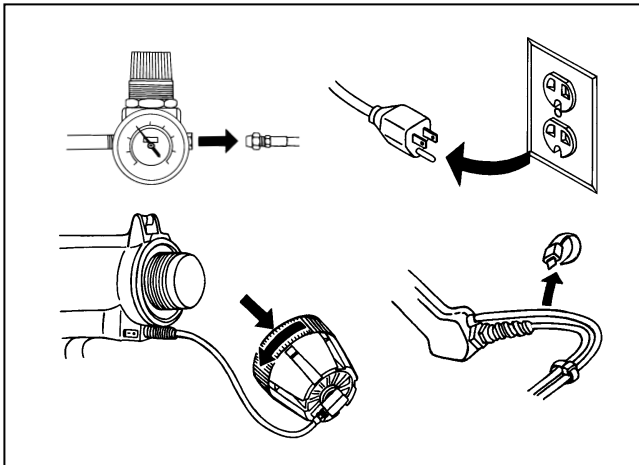

1. Disconnect air and electrical power and allow the applicator to cool to room temperature before disassembly.

Cut and discard the plastic tie wrap located closest to the applicator that holds power cord and air hose together.

Unscrew the endcap from the heat tube.

NOTE: If the endcap cannot be unscrewed, disassembly may not be possible. Contact your Scotch-Weld distributor for assistance.

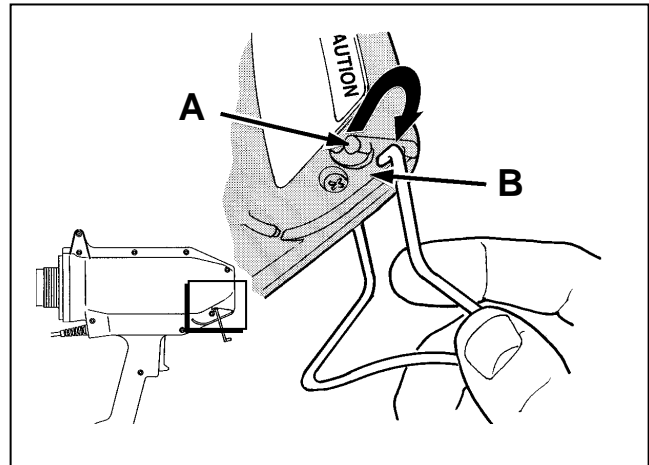

2. Pull one side of the wirestand out of the pivot hole (A) and allow it to spring down into the recessed area (B).

NOTE: Do not attempt to pull the end completely out in this step or binding may occur on the other side. For best results, follow steps 2 and 3 to reduce possible damage to wirestand or applicator.

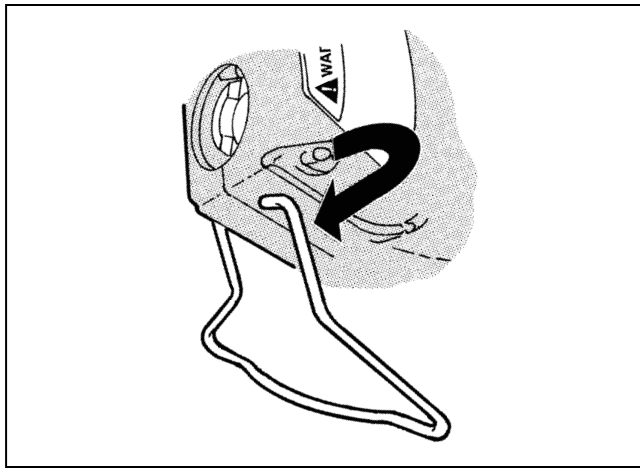

3. Turn the applicator over and pull the other side of the wirestand out of the other pivot hole and over the edge of the applicator.

The wirestand can now be removed completely.
Save the wirestand for reassembly.

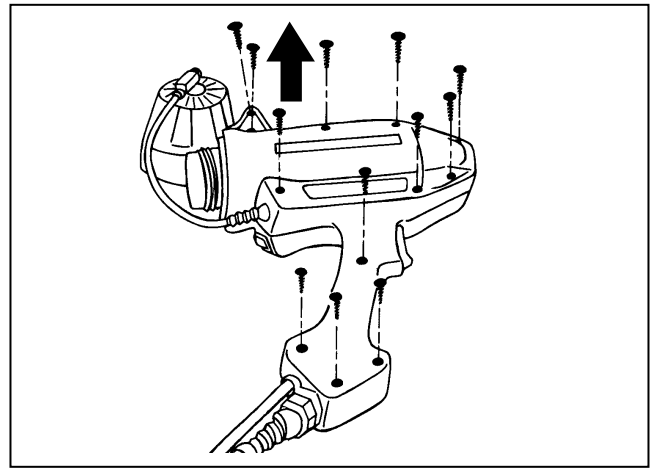

4. Remove the 12 screws that hold the housing halves together and save them for reassembly.

NOTE: A long, magnetized Phillips bit (P2) is recommended because it will pull screws out of the deeper recesses.

If a non-magnetized bit is used, it may be necessary to hold the housing halves together and turn the applicator over to allow the screws to drop out.

It is recommended that all the screws be removed before separating housings. This ensures that a partially loosened screw will not cause problems in steps 5 and 6.

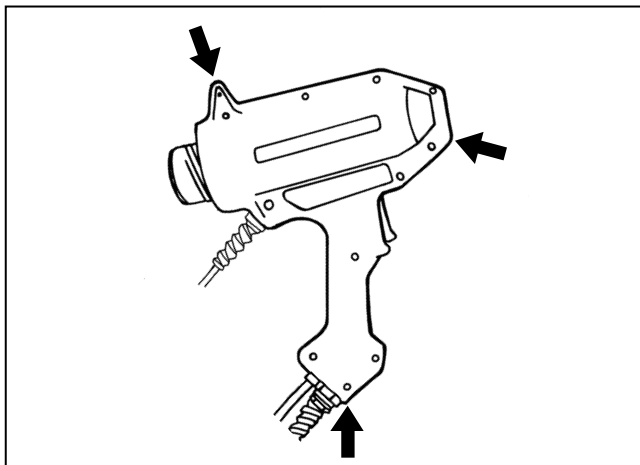

5. To make sure the upper housing will lift off cleanly, just **slightly** separate the two halves at the locations shown.

Clear an area to the left of the applicator to allow both housings to lie side by side.

HINT: To prevent the weight of the power cord and air hose from pulling the applicator off the work surface, they can be taped, tied, or put in a drawer just beneath the work surface, if available.

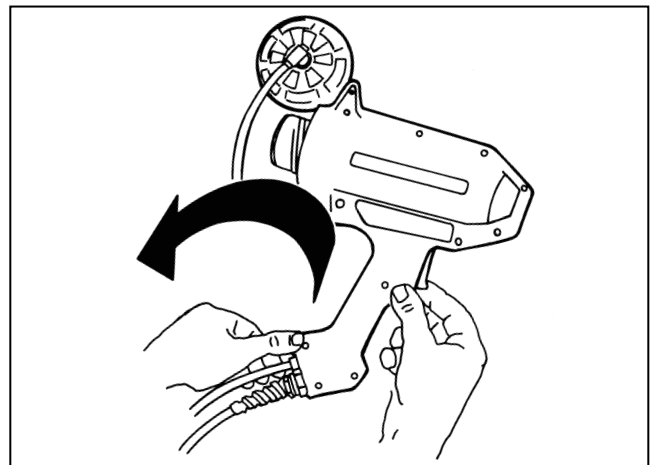

6. Hold the trigger and the air hose up into the upper housing and lift off – at the same time flipping it over so the interior is visible – and lay it next to the lower housing.

NOTE: If adhesive contamination prevents separation of the housings, contact your Scotch-Weld distributor for assistance. **Do not** attempt to remove Scotch-Weld adhesives with heat, flame, or solvent. **This may cause hazardous vapors or fire.**

HINT: Position the endcap above the rear portion of the applicator as shown so it will not interfere when laying the upper housing down.

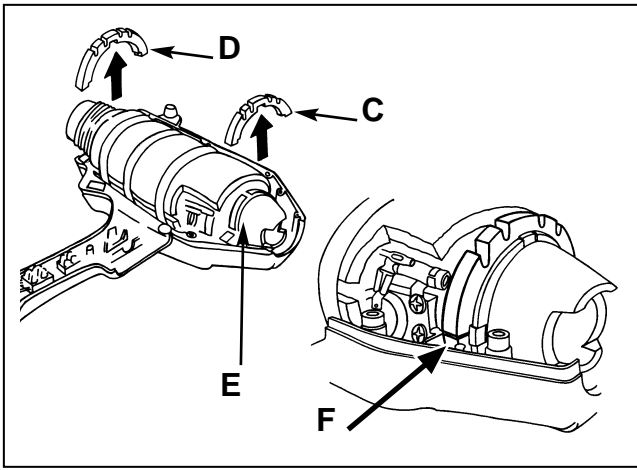

7. If the front standoff (C) or the rear standoff (D) is dislodged in any way, replace them on the heat tube (E). Upper and lower sets of standoffs should be in contact with no visible gaps between them at all four locations (F).

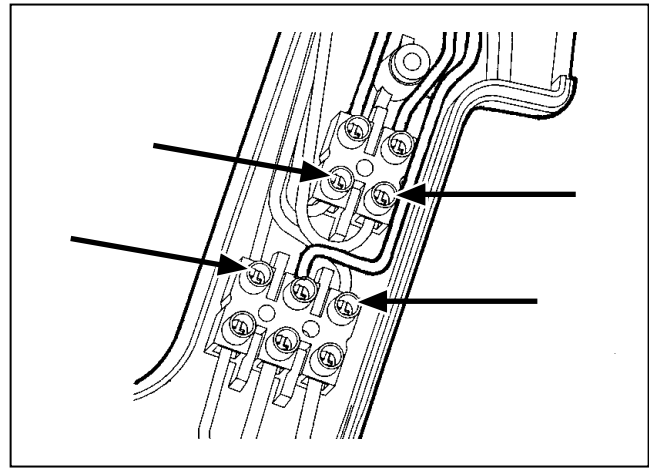

8. Loosen the three terminal block screws indicated by arrows about 3-4 turns. Either a 1/8 in. slotted blade screwdriver or a Phillips (P1) screwdriver can be used. Use a needle-nosed pliers and pull each wire out of the terminal blocks.

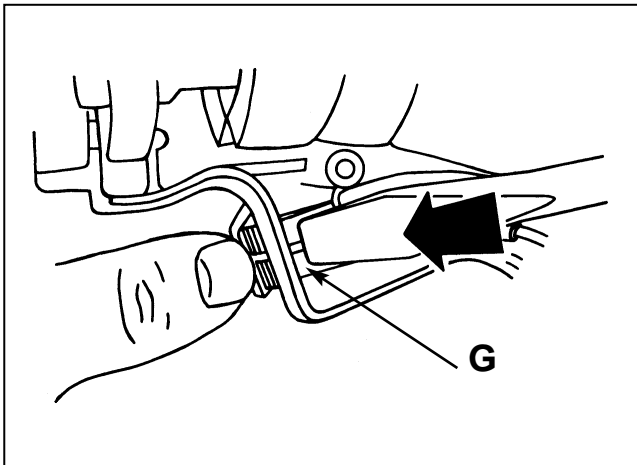

9. Press a large straight blade screwdriver - or other flat tool - down against both flexible retention springs (G). At the same time rotate the near side of the switch out of the opening in the housing.

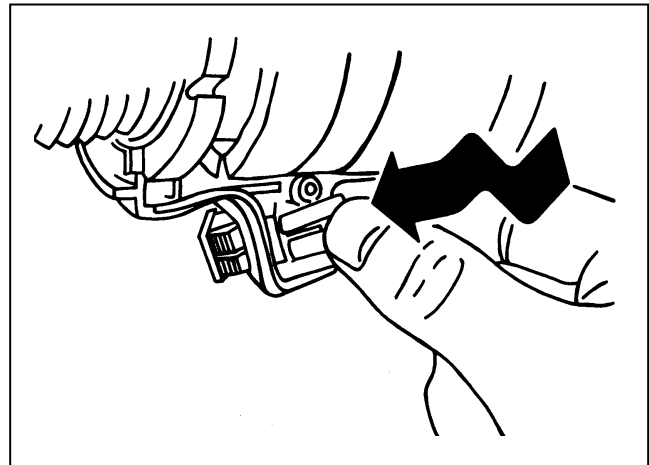

10. Grasp the switch and rock it back and forth while pushing it out of the hole in the housing

 WARNING	<p>Avoid contact with the insulation wrap surrounding the heat tube. Avoid any acts that would generate dust particles. The ceramic fiber material may be harmful if inhaled. May cause skin, eye, and respiratory tract irritation.</p>
--------------------	--

NOTE: If there is silicone rubber deposited along the wall of the housing near the switch opening, leave it in place. This will help to support the replacement switch.

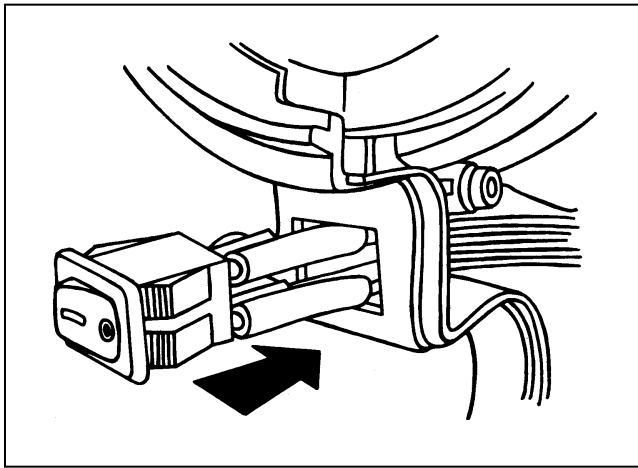

11. Feed the wire leads of the replacement switch through the opening of the housing. Position the switch so the leads with the red, silicone rubber sleeving are towards you.

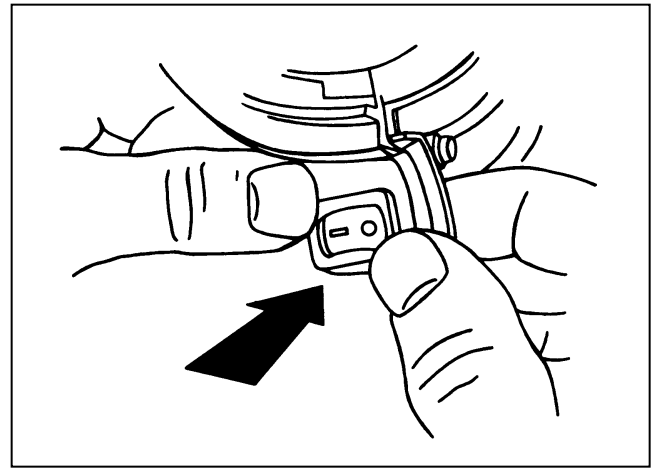

12. Push both sides of the switch bezel firmly until the switch snaps into place and is flush against the housing.

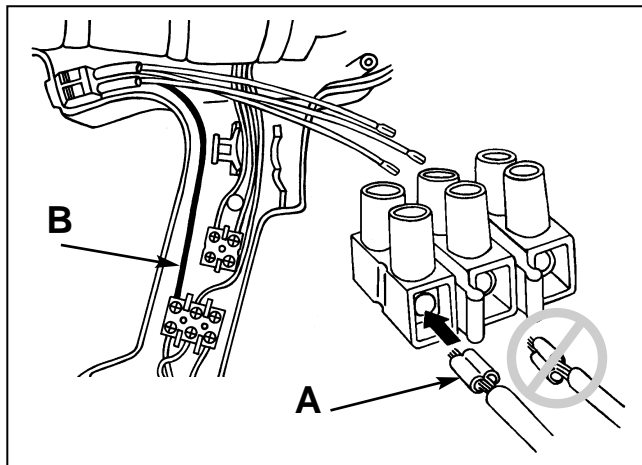

13. Route the black switch wire (B) as shown. Twist the end connector (A) on the wire so the wide sides are horizontal. Insert the wire about 1/4 in. (6.4 mm) into the hole on the left side of the of the 3-pole terminal block and tighten the screw firmly.

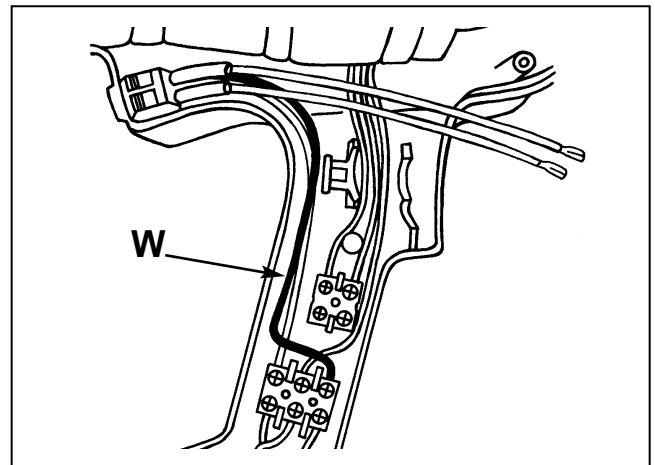

14. Bend the white wire (W) and route as shown. (The white wire is shown darker for clarity.) Twist the end connector (A) on the wire so the wide sides are horizontal as shown in step 13. Insert the wire about 1/4 in. (6.4 mm) into the hole on the right side of the 3-pole terminal block and tighten the screw firmly.

NOTE: If desired, the terminal block can be pried upward **slightly** to make it easier to insert the wire. Make sure the terminal block is pushed back into place if this is done.

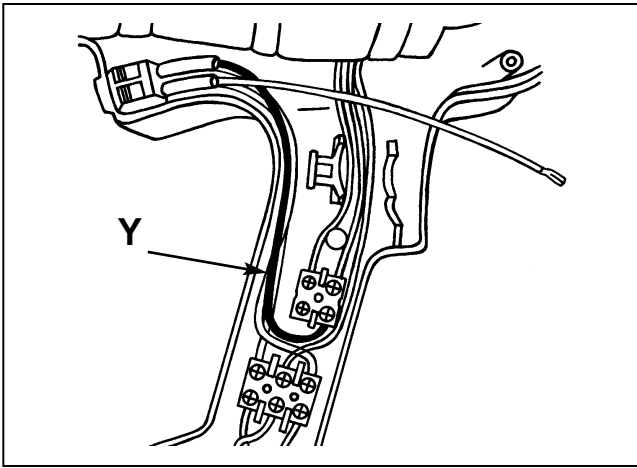

- 15.** Bend the yellow wire (Y) and route as shown. (The yellow wire is shown darker for clarity.)
- Twist the end connector (A) on the wire so the wide sides are horizontal as shown in step 13.
- Insert the wire about 1/4 in. (6.4 mm) into the hole on the right side of the 2-pole terminal block and tighten the screw firmly.

NOTE: If desired, the terminal block can be pried upward *slightly* to make it easier to insert the yellow and red wires.

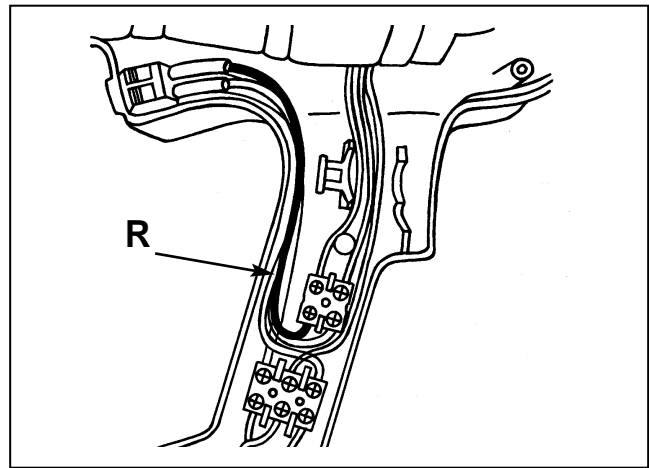

- 16.** Bend the red wire (R) and route as shown. (The red wire is shown darker for clarity.)
- Twist the end connector (A) on the wire so the wide sides are horizontal as shown in step 13.
- Insert the wire about 1/4 in. (6.4 mm) into the left side of the 2-pole terminal block and tighten the screw firmly.

If the terminal block has been pried up from its original position, make sure it is pushed back down into place.

Recheck all the screws in both terminal blocks to make sure they are tightened securely.

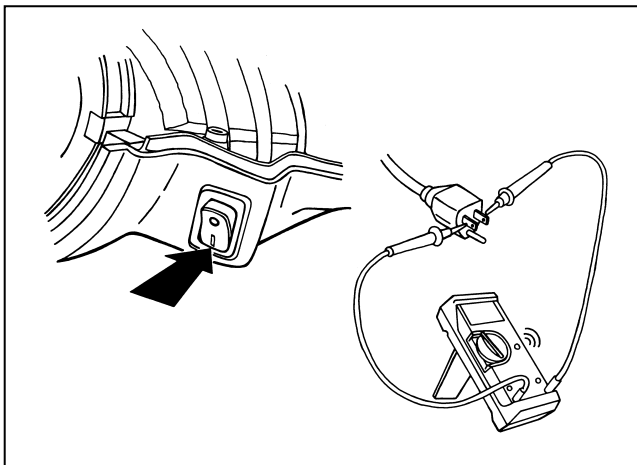

- 17.** Check for proper electrical installation by connecting a multimeter or continuity tester across the power cord plug blades. Continuity should exist when the switch is pushed to the on position.
- If continuity is not obtained, check wires to make sure they are firmly fastened into terminal blocks. If problem persists, see owner's manual for applicator and repeat troubleshooting procedures.

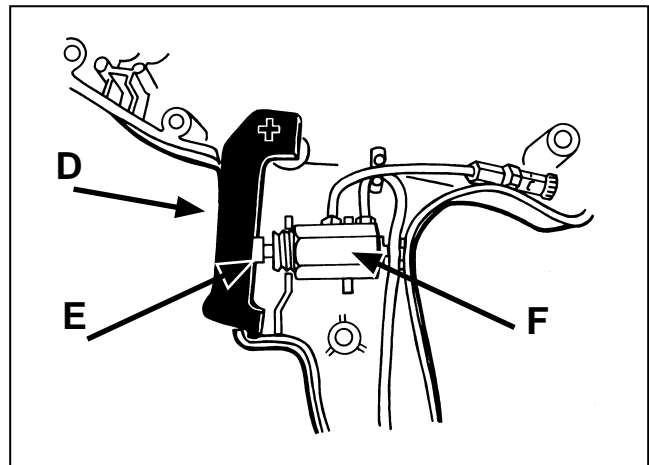

- 18.** On the upper housing, make sure the trigger (D) is engaged on the valve button (E) and the trigger is positioned properly in its bearing.
- Push the valve (F) down so it is positioned as shown and make sure the air tubes are held in the grooved rib as illustrated. This will help to keep the valve in position when the housing is inverted in step 16.
- When properly positioned, the top flat of the hexagonal valve body will be horizontal and the tube fittings will be directed away from you and down along the inside surface of the housing.

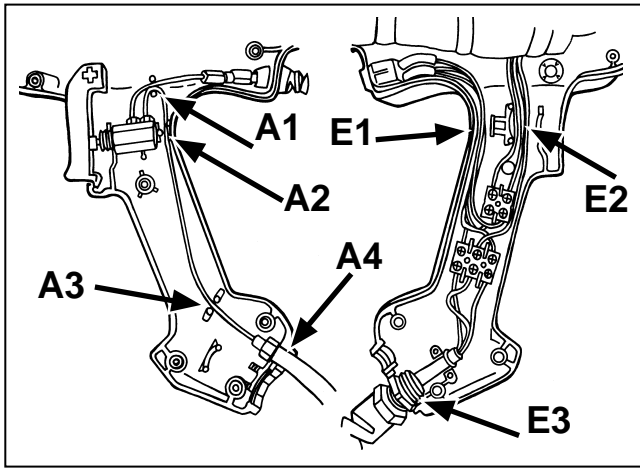

- 19.** Check the locations indicated by arrows above to make sure all components are positioned properly.
- Wires at E1 and E2 should be down into positions so the upper housing and air valve will not pinch them during reassembly.
- Air tubing at A1, A2 and A3 should be positioned in grooved ribs so the valve will be held in position.
- The power cord strain relief at E3 needs to be in approximate position - final adjustment can be made in step 17 - along with readjustment of air hose at A4.

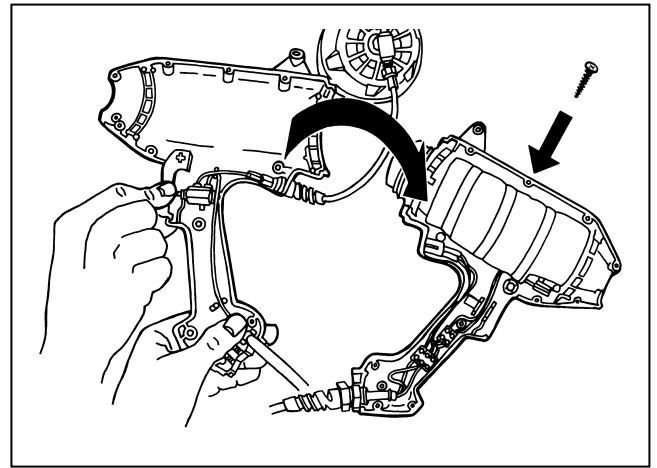

- 20.** Hold trigger and the air hose in position in the upper housing and lift and turn the upper housing over onto the lower housing. Crossing the hands as shown will make it easier to hold the components in position while turning the housing over.
- Make sure both housings are aligned and press them together.
- Attach one housing screw along the top of the applicator where shown, but do not fully tighten. This will hold the housing halves together during final adjustment of power cord and air hose.

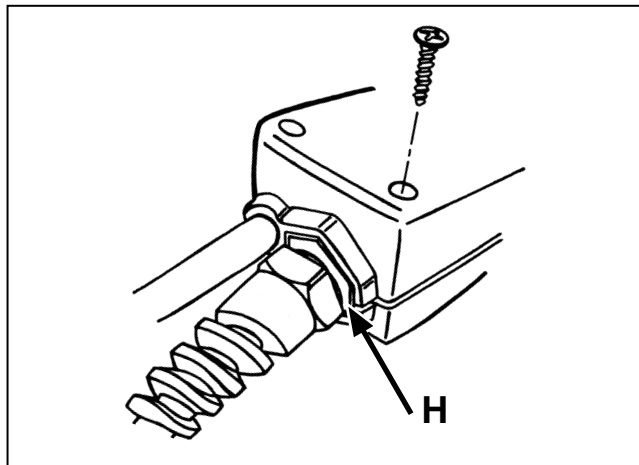

- 21.** Separate the housing halves at the bottom of the handle just enough to adjust the position of the power cord strain relief. The hex (H) should be aligned and fully engaged with the matching hex-shaped recess in the housings. If necessary, rotate the strain relief hex one flat in either direction to obtain good fit.
- If necessary, adjust the position of the air supply hose so it is located properly in the circular recesses.
- While holding the housings halves together, insert a housing screw into the lowest hole and tighten just snugly.

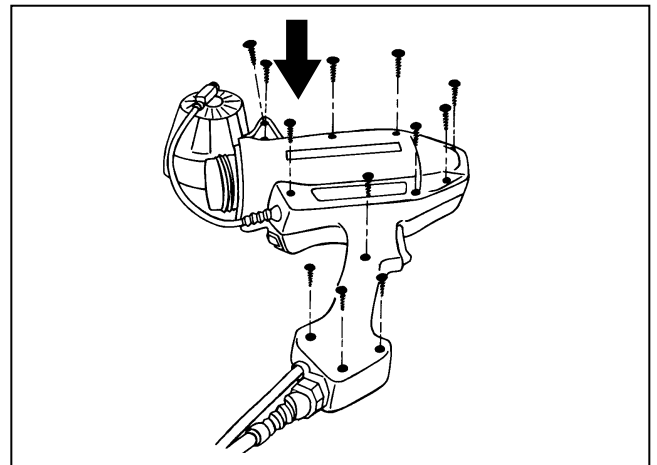

- 22.** Recheck proper fit and alignment between the housing halves and make sure the trigger pivots freely.
- Insert the other 10 housing screws and tighten all the screws firmly but not too tightly.

IMPORTANT: Do not use a large screwdriver or a power driver at a high torque setting. Overtightening the housing screws could cause the threads to strip out and damage the lower housing.

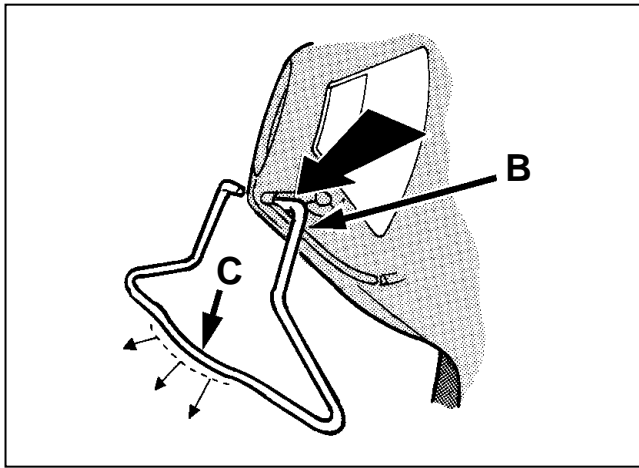

23. Hold the wirestand so the rounded part (C) curves away from the applicator and temporarily hook one end of the wirestand so the end rests down in the bottom of the recess (B) as shown.

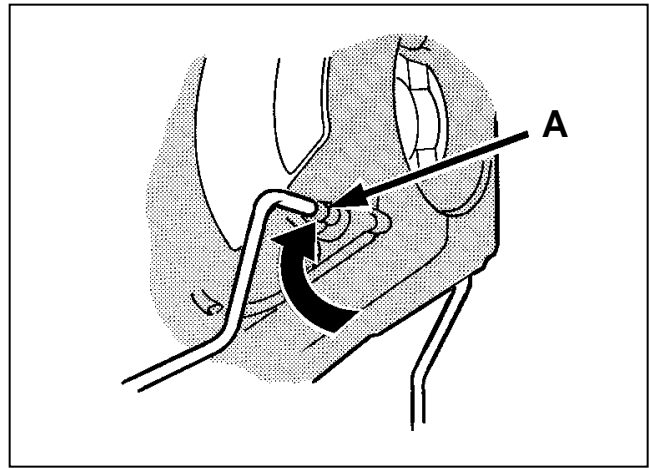

24. Pull the other end of the wirestand just enough to go over the edge of the applicator and position it into the pivot hole (A). The spring action of the wirestand will pull itself down into place.

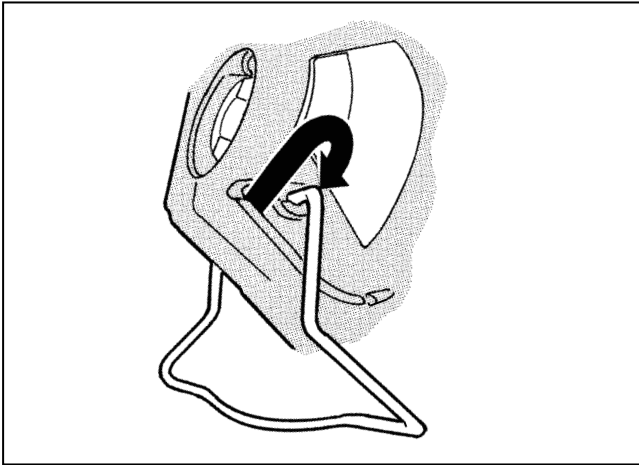

25. Pull the first end of the wirestand – from step 23 – out of the recess and position it over its pivot hole. The spring action of the wirestand will pull itself down into place.

LIMITED WARRANTY: 3M warrants for a period of 30 days from the date of purchase or use, whichever occurs first, that the 3M™ Scotch-Weld™ ON/OFF SWITCH KIT will be free of defects in material and manufacture. 3M MAKES NO OTHER WARRANTIES, EXPRESS OR IMPLIED, WITH RESPECT TO THE SCOTCH-WELD ON/OFF SWITCH KIT INCLUDING, BUT NOT LIMITED TO, ANY IMPLIED WARRANTY OF MERCHANTABILITY OR FITNESS FOR A PARTICULAR PURPOSE. This limited warranty does not cover damage resulting from accident, misuse or abuse, lack of reasonable care, service performed by an unauthorized repair service, use of unauthorized replacement parts, operation or maintenance not in accordance with 3M recommended procedures, or the use of adhesive cartridges not manufactured by 3M or not subject to 3M finished product standards.

LIMITATION OF REMEDIES: If the Scotch-Weld ON/OFF SWITCH KIT is proved to be defective within the warranty period stated above. THE EXCLUSIVE REMEDY AND SOLE OBLIGATION OF 3M SHALL BE, AT 3M'S OPTION, THE REFUND OF THE PURCHASE PRICE, REPAIR OR REPLACEMENT OF THE DEFECTIVE SCOTCH-WELD ON/OFF SWITCH KIT.

LIMITATION OF LIABILITY: Except for the exclusive remedy stated above, 3M shall not otherwise be liable for any loss or damages, whether direct, indirect, special, incidental, or consequential, regardless of the legal theory asserted, including negligence, warranty, or strict liability.

3M

Industrial Business
Industrial Adhesives and Tapes Division

3M Center, Building 220-5E-06
St. Paul, MN 55144-1000



Recycled Paper
40% pre-consumer
10% post-consumer

Printed in U.S.A.
©3M 2005 78-6900-7024-4 (1/05)