

# The heart of the smart home.

Smart speakers and smart displays are the beating heart of the modern, connected home. They manage multiple devices and keep us connected as we work, cook and do just about everything else. These devices include curved surfaces with complex and low-surface-energy substrates. They need flexible, versatile bonding solutions to help strike a balance of functionality and aesthetics. And they require effective EMI shielding and grounding solutions to boost signal-to-noise ratios.

## Smart speaker and smart display applications:

- **Lens bonding** solutions that help provide good impact resistance and protection from water and chemicals
- **Display bonding** solutions that help provide high-strength bonding of plastics to glass
- **Speaker foam bonding** solutions that help deliver good bonding strength to a variety of foam substrates
- Excellent bonding strength for **silicone foot bonding**
- **Camera grounding solutions** provide grounding where needed without virtually inhibiting adjacent circuitry
- **Shield can lid solutions** with comparable effectiveness to metal components while minimizing height and weight

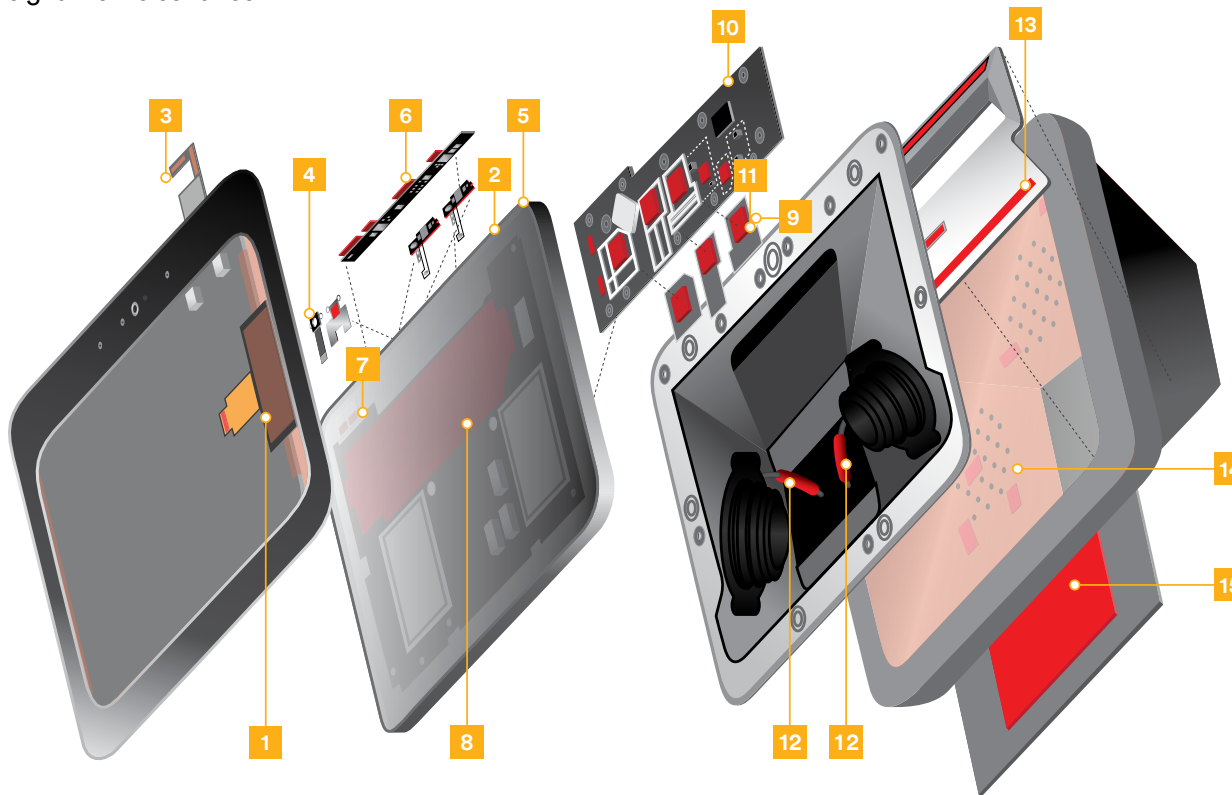

## Smart Speaker Applications

No.	Application description
1	COF shielding
2	Lens bonding
3	Display FPC grounding
4	Camera grounding
5	Side key grounding
6	Microphone mesh bonding
7	FPC antenna bonding
8	Display frame bonding
9	FPC grounding
10	PCB grounding
11	PCB bonding
12	Outer shell foam bonding
13	Power port bonding
14	Back cover foam bonding
15	Silicone base bonding

	Number	Application	Featured Products	Product Type	Color	Thickness (µm)	Features
Smart Speaker	1	COF Shielding	5113SFT	Single Sided Conductive Fabric Tape	Grey	50/100	<ul style="list-style-type: none"> <li>• XYZ-axis conductivity through the adhesive</li> <li>• Excellent EMI shielding in bond line gap</li> <li>• Excellent electrical contact to small size areas</li> <li>• Long shelf-life and stable in humid environments</li> </ul>
			7750BF	Single Sided Conductive Fabric Tape	Black	50	<ul style="list-style-type: none"> <li>• XYZ-conductivity through the tape</li> <li>• Excellent conformability and quick bonding</li> <li>• Good EMI shielding in bond line gap</li> <li>• Improved electrical contact to small size areas</li> <li>• Good handling and workability</li> </ul>
	2	Lens bonding	VHB™ 5980	Acrylic Foam Tape	Black	150/200/250/300	<ul style="list-style-type: none"> <li>• Drop, shock and impact resistance</li> <li>• Conformable</li> <li>• Seal against water and moisture</li> </ul>
			VHB™ 590x	Acrylic Foam Tape	Black	150/200/250/300/350	<ul style="list-style-type: none"> <li>• High bonding strength and durability</li> <li>• Conformable</li> <li>• Seal against water ingress</li> </ul>
			VHB™ 934xx	Conformable Double Coated Tape	Black	200/250/300	<ul style="list-style-type: none"> <li>• Bonding to low surface energy substrates</li> <li>• Anti-lifting at room and elevated temperature</li> <li>• Great chemical resistance</li> </ul>
	3	Display FPC grounding	9701H	Double Sided Non-woven Conductive Tape	Grey	50	<ul style="list-style-type: none"> <li>• XYZ-conductivity</li> <li>• Good electrical contact to small area</li> <li>• Nickel/copper-coated conductive non-woven fabric carrier</li> </ul>
	4	Camera grounding	5113DFT	Double Sided Conductive Fabric Tape	Grey	50/100	<ul style="list-style-type: none"> <li>• XYZ-axis conductivity through the adhesive</li> <li>• Excellent EMI shielding in bond line gap</li> <li>• Excellent electrical contact to small size areas</li> <li>• Long shelf-life and stable in humid environments</li> </ul>
			9711S	Double Sided Conductive Fabric Tape	Grey	30/50/80/100/120/130/150/170/200/210/220/250/300	<ul style="list-style-type: none"> <li>• XYZ-conductivity</li> <li>• Excellent conformability, quick bonding</li> <li>• Deadsoft copper foil backing</li> </ul>
	5	Side key grounding	5113DFT	Double Sided Conductive Fabric Tape	Grey	50/100	<ul style="list-style-type: none"> <li>• XYZ-axis conductivity through the adhesive</li> <li>• Excellent EMI shielding in bond line gap</li> <li>• Excellent electrical contact to small size areas</li> <li>• Long shelf-life and stable in humid environments</li> </ul>
			9711S	Double Sided Conductive Fabric Tape	Grey	30/50/80/100/120/130/150/170/200/210/220/250/300	<ul style="list-style-type: none"> <li>• XYZ-conductivity</li> <li>• Excellent conformability, quick bonding</li> <li>• Deadsoft copper foil backing</li> </ul>

Chart continued on next page

	Number	Application	Featured Products	Product Type	Color	Thickness (µm)	Features
Smart Speaker	6	Microphone mesh bonding	930xxLE	Double Coated PET Tape	Clear	50/100/150/200	<ul style="list-style-type: none"> <li>Bonding to low surface energy substrates</li> <li>Adhesion to oily surface</li> <li>Dimensional stability, ease of die cutting</li> <li>Good resistance to industrial and consumer chemicals</li> </ul>
			DP100 Plus LH	2K Epoxy Adhesive	Clear	-	<ul style="list-style-type: none"> <li>High peel and shear strength</li> <li>2-4 min worklife</li> </ul>
	7	FPC antenna bonding	9471LE	Adhesive Transfer Tape	Clear	58	<ul style="list-style-type: none"> <li>Bonding to low surface energy substrates</li> <li>Anti-lifting</li> <li>Resistance to chemicals, moisture and humidity</li> </ul>
	8	Display frame bonding	552xxP	Double Coated PET Tape	Clear, Black	50/75/100/120	<ul style="list-style-type: none"> <li>High initial adhesion</li> <li>Up to 150°C short-term heat resistance</li> <li>Easily converted</li> </ul>
			VHB™ 934xx	Conformable Double Coated Tape	Black	200/250/300	<ul style="list-style-type: none"> <li>Bonding to low surface energy substrates</li> <li>Anti-lifting at room and elevated temperature</li> <li>Great chemical resistance</li> </ul>
			DP100 Plus LH	2K Epoxy Adhesive	Clear	-	<ul style="list-style-type: none"> <li>High peel and shear strength</li> <li>2-4 min worklife</li> </ul>
	9	FPC grounding	5113DFT	Double Sided Conductive Fabric Tape	Grey	50/100	<ul style="list-style-type: none"> <li>XYZ-axis conductivity through the adhesive</li> <li>Excellent EMI shielding in bond line gap</li> <li>Excellent electrical contact to small size areas</li> <li>Long shelf-life and stable in humid environments</li> </ul>
			9701H-50	Double-sided Non-woven Conductive Tape	Grey	50	<ul style="list-style-type: none"> <li>XYZ-conductivity</li> <li>Good electrical contact to small area</li> <li>Nickel/copper-coated conductive non-woven fabric carrier</li> </ul>
	10	PCB grounding	5113DFT	Double Sided Conductive Fabric Tape	Grey	50/100	<ul style="list-style-type: none"> <li>XYZ-conductivity, quick bonding</li> <li>Conformable, good EMI shielding in bond line gap</li> <li>Conductive fabric coated with conductive adhesive"</li> </ul>
			9711S	Double Sided Conductive Fabric Tape	Grey	30/50/80/100/120/130/150/170/200/210/220/250/300	<ul style="list-style-type: none"> <li>XYZ-conductivity</li> <li>Excellent conformability, quick bonding</li> <li>Deadsoft copper foil backing</li> </ul>
MSG7000SDX			Conductive Gasket	Grey	300/650/1000/1500/2000/2500	<ul style="list-style-type: none"> <li>High compression for wide range gap filling</li> <li>Excellent contact resistance and reliable adhesion</li> <li>Low resistance even at a slight compression</li> </ul>	

Chart continued on next page

	Number	Application	Featured Products	Product Type	Color	Thickness (µm)	Features
Smart Speaker	11	PCB bonding	552xxP	Double Coated PET Tape	Clear, Black	50/75/100/120	<ul style="list-style-type: none"> <li>• High initial adhesion</li> <li>• Up to 150°C short-term heat resistance</li> <li>• Easily converted</li> </ul>
	12	Outer shell foam bonding	9448A	Double Coated Tissue Tape	White, Clear	150	<ul style="list-style-type: none"> <li>• High initial adhesion</li> <li>• Up to 150°C short-term heat resistance</li> <li>• Easily converted</li> </ul>
			9080A				
	13	Power port bonding	930xxLE	Double Coated PET Tape	Clear	50/100/150/200	<ul style="list-style-type: none"> <li>• Bonding to low surface energy substrates</li> <li>• Adhesion to oily surface</li> <li>• Dimensional stability, ease of die cutting</li> <li>• Good resistance to industrial and consumer chemicals</li> </ul>
			DP100 Plus LH	2K Epoxy Adhesive	Clear	-	<ul style="list-style-type: none"> <li>• High peel and shear strength</li> <li>• 2-4 min worklife</li> </ul>
	14	Back cover foam bonding	552xxP	Double Coated PET Tape	Clear, Black	50/75/100/120	<ul style="list-style-type: none"> <li>• High initial adhesion</li> <li>• Up to 150°C short-term heat resistance</li> <li>• Easily converted</li> </ul>
			VHB™ 934xx	Conformable Double Coated Tape	Black	200/250/300	<ul style="list-style-type: none"> <li>• Bonding to low surface energy substrates</li> <li>• Anti-lifting at room and elevated temperature</li> <li>• Great chemical resistance</li> </ul>
	15	Silicone base bonding	9119	Double Coated PET Tape	Clear	50/85/100/140	<ul style="list-style-type: none"> <li>• Bonding to silicone substrates</li> <li>• Good shear holding power</li> <li>• Easily converted</li> </ul>
			9731	Double Coated PET Tape	Clear	50/100/140	<ul style="list-style-type: none"> <li>• Bonding to silicone substrates</li> <li>• High temperature and chemical resistance</li> </ul>

*Many factors beyond 3M's control and uniquely within user's knowledge and control can affect the use and performance of a 3M product in a particular application. Given the variety of factors that can affect the use and performance of a 3M product, user is solely responsible for evaluating the 3M product and determining whether it is fit for a particular purpose and suitable for user's method of application, including any necessary safety or toxicological assessments.*

**Safety Data Sheet:** Consult Safety Data Sheet before use.

**Regulatory:** For regulatory information about this product, contact your 3M representative.

**Technical Information:** The technical information, recommendations and other statements contained in this document are based upon tests or experience that 3M believes are reliable, but the accuracy or completeness of such information is not guaranteed.

**Product Use:** Many factors beyond 3M's control and uniquely within user's knowledge and control can affect the use and performance of a 3M product in a particular application. Given the variety of factors that can affect the use and performance of a 3M product, user is solely responsible for evaluating the 3M product and determining whether it is fit for a particular purpose and suitable for user's method of application.

**Warranty, Limited Remedy, and Disclaimer:** Unless a different warranty is specifically stated on the applicable 3M product packaging or product literature, 3M warrants that each 3M product meets the applicable 3M product specifications on the Certificate of Analysis, which is established when the product is manufactured and deemed commercially available and is provided at the time 3M ships the product. **3M MAKES NO OTHER WARRANTIES OR CONDITIONS, EXPRESS OR IMPLIED, INCLUDING, BUT NOT LIMITED TO, ANY IMPLIED WARRANTY OR CONDITION OF MERCHANTABILITY OR FITNESS FOR A PARTICULAR PURPOSE OR ANY IMPLIED WARRANTY OR CONDITION ARISING OUT OF A COURSE OF DEALING, CUSTOM, OR USAGE OF TRADE.** If a 3M product does not conform to this warranty, then the sole and exclusive remedy is, at 3M's option, replacement or repair of the 3M product or refund of the purchase price.

**Limitation of Liability:** Except where prohibited by law, 3M will not be liable for any loss or damage arising from the 3M product, whether direct, indirect, special, incidental, or consequential, regardless of the legal or equitable theory asserted, including, but not limited to, warranty, contract, negligence, or strict liability.

**Disclaimer:** For industrial use only. Not intended, labeled or packaged for consumer sale or use.



**Electronics Device Bonding**  
3M Center, Building 223-3S-32  
St. Paul, MN 55144-1000

Phone 1-800-362-3550  
Web [www.3M.com/electronicbonding](http://www.3M.com/electronicbonding)

3M and VHB are trademarks of 3M Company.  
Please recycle. © 3M 2023. All rights reserved.  
60-5005-0426-5