

**3M** Science.  
Applied to Life.™

## Curing guidelines, according to the Halifax Consensus Statement,\* help to assure a safe and proper cure

3M™ Elipar™ DeepCure  
LED Curing Lights



1

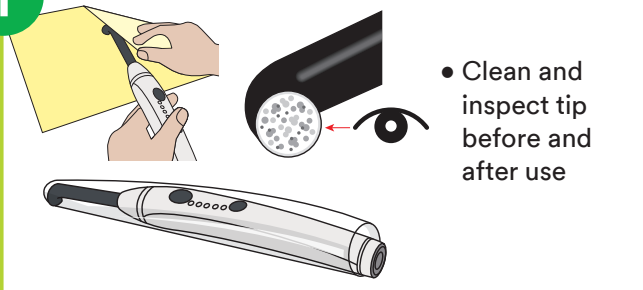

- Clean and inspect tip before and after use

2

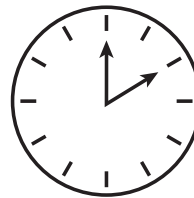

- Set curing time according to manufacturer's instructions

3

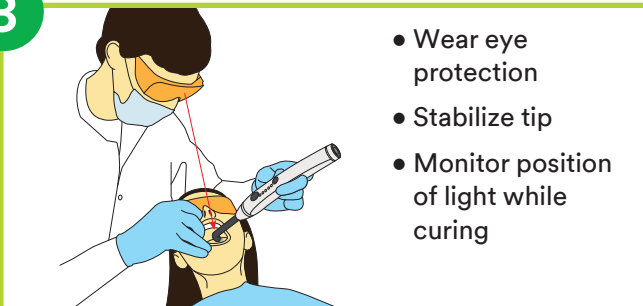

- Wear eye protection
- Stabilize tip
- Monitor position of light while curing

4

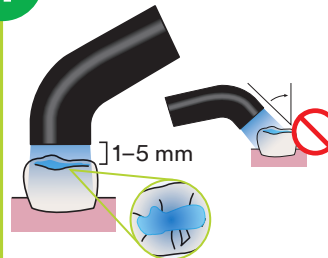

- Cover restoration with tip
- Position tip close and perpendicular to restoration
- Avoid distance > 5 mm and shadows

5

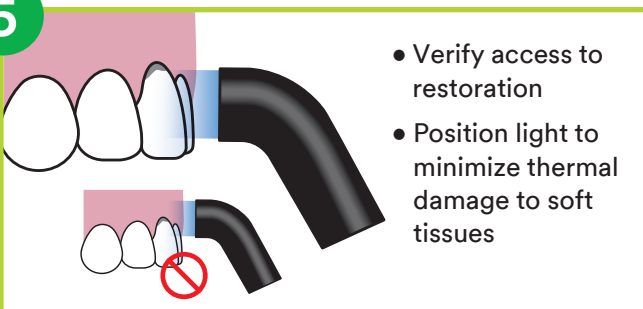

- Verify access to restoration
- Position light to minimize thermal damage to soft tissues

6

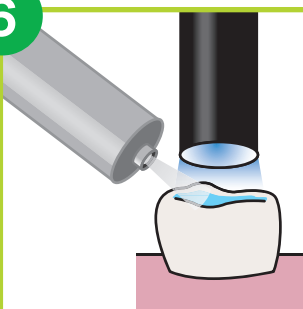

- Manage heat development:
- Air cool: light on, air on
  - Cure in intervals (e.g. 2 × 10 sec. instead of 1 × 20 sec.)

7

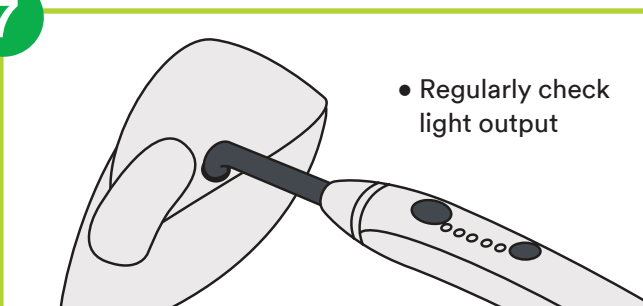

- Regularly check light output

Steps 1 through 7 are general guidelines from the Halifax Consensus Statement and may not be applicable to every curing light. For Elipar DeepCure-S and Elipar DeepCure-L LED Curing Lights, please refer to Instructions for Use.

\*Source: Halifax Consensus Statement from the 2014 Symposium on Light Curing in Dentistry, Dalhousie University, Halifax, Canada

## Choose from two models, both with identical technical performance.

### 3M™ Elipar™ DeepCure-S LED Curing Light

For dentists who enjoy the look, feel and durability of high-quality stainless steel



### 3M™ Elipar™ DeepCure-L LED Curing Light

For dentists who want high performance in a lightweight model

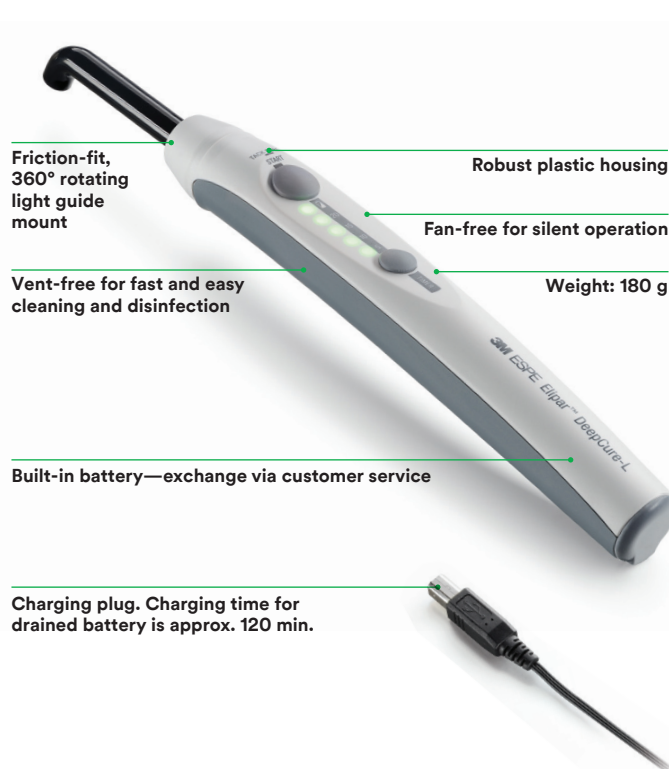

#### Technical Performance Data for Both Models

<b>Wavelength</b>	430–480 nm
<b>Light intensity</b>	1,470 mW/cm <sup>2</sup> (-10%/+20%)
<b>Power supply</b>	Lithium-ion battery Approx. 120 min. battery runtime (~720 10-sec. cures) with constant light output regardless of battery charge
<b>Operation</b>	Intuitive two-button and single-mode operation Pre-set cure times: 5, 10, 15 and 20 seconds, continuous mode (120 sec.) and tack-cure mode
<b>Curing time</b>	Refer to material instructions; 10 sec. for many composites
<b>Light guide</b>	10 mm, black coated, autoclavable, optimal intraoral reach due to user- and patient-friendly geometry

#### Ordering Information—Stainless Steel

Item #	Product Information
76977	<b>3M™ Elipar™ DeepCure-S LED Curing Light</b> Contains: Handpiece (Cordless), Charging Base (230V); Li-ion Battery; 10mm Light Guide; Eye Shield
76981	<b>3M™ Elipar™ DeepCure-S Light Guide, 10mm</b>
76984	<b>3M™ Elipar™ DeepCure Eye Shield</b>
76985	<b>3M™ Elipar™ DeepCure-S Rechargeable Li-ion Battery</b>

#### Ordering Information—Lightweight

Item #	Product Information
76973	<b>3M™ Elipar™ DeepCure-L LED Curing Light</b> Contains: Handpiece (built-in Li-ion battery); Universal Power Supply with 5 adaptors; 10mm Light Guide; Eye Shield; 3 Curing Discs
76983	<b>3M™ Elipar™ DeepCure-L Light Guide, 10mm</b>
76984	<b>3M™ Elipar™ DeepCure Eye Shield</b>
76965	<b>3M™ Elipar™ DeepCure-L Curing Discs (5 pcs.)</b>

[3M.co.uk/Dental](https://3M.co.uk/Dental)



3M Oral Care  
3M United Kingdom PLC  
Charnwood Campus  
10 Bakewell Road  
Loughborough  
Leicestershire LE11 5RB  
+0800 626 578

3M Ireland Ltd  
The Iveagh Building  
Carrickmines Park  
Carrickmines  
Dublin 18  
00 353 (01) 280 3555

3M, Elipar and ESPE are trademarks of 3M company. © 3M 2021. All rights reserved.