

# ABTHERA™

## ACTIVE ABDOMINAL THERAPY

# ABTHERA™ Open Abdomen Negative Pressure Therapy

## Quick Reference Guide

**Important:** This quick reference is provided as a basic overview only. Refer to the ABTHERA™ Dressing Indications for Use and the V.A.C. ULTA™ Therapy Unit user manual for detailed instructions, including important safety information. For medical emergencies, consult treating physician or call emergency services. Carefully read and follow all literature and labeling accompanying product prior to use. Contact Acelyty if you have any questions before initiating therapy.

### Indications for Use

- Temporary bridging of abdominal wall openings where primary closure is not possible and/or repeat abdominal entries are necessary.
- Intended use of this dressing is for use in open abdominal wounds with exposed viscera, including, but not limited to, abdominal compartment syndrome.
- Intended care setting is a closely monitored area within the acute care hospital, such as the Intensive Care Unit. The abdominal dressing will most often be applied in the operating theater.

### ABTHERA™ SENSAT.R.A.C.™ Open Abdomen Dressing



1. Visceral Protective Layer (VPL)
2. Perforated Foam
3. Drape
4. SENSAT.R.A.C.™ Pad and Tubing
5. Negative Pressure Therapy Unit
6. Canister (1000mL)

### V.A.C.ULTA™ Therapy Unit



### Setting up the Therapy Unit

#### 1. Attach the canister



V.A.C.® Therapy: 500 mL or 1000 mL canister (Acute Care only)

#### 2. Connect the Dressing Tubing (after applying the dressing)

Align, Push, and Twist



**NOTE:** Refer to the Instructions for Use for complete details regarding Dressing Application.

### Initiating V.A.C.® Therapy

Press and hold power button until light comes on.

#### Choose Therapy screen



Select V.A.C.® Therapy  
ABTHERA™ Therapy is not for use with VERAFLU™ Therapy instillation option.

#### V.A.C.® Therapy Settings screen

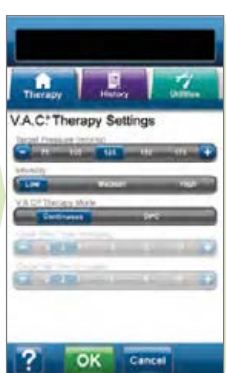

Configure V.A.C.® Therapy as prescribed. Choose **Continuous** (default) setting and select **OK**.

#### Confirm Settings screen

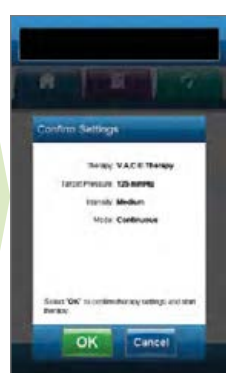

Select **OK** to accept settings

#### SEALCHECK™ Leak Detector screen



V.A.C.® Therapy Begins

### Contraindications

- Patients with open abdominal wounds containing non-enteric unexplored fistulas should not be treated with ABTHERA™ Therapy.
- Protect vital structures with ABTHERA™ Visceral Protective Layer **at all times during therapy**. **Never place exposed foam material directly in contact with exposed bowel, organs, blood vessels or nerves.**

### ABTHERA™ Visceral Protective Layer Application

Sizing the Visceral Protective Layer can be achieved by folding (Option 1) or cutting (Option 2). The front side and back side of the VPL are the same.

**WARNING: The foam is encapsulated for patient safety. Protect vital structures with ABTHERA™ Visceral Protective Layer at all times during therapy. Never place exposed foam material directly in contact with exposed bowel, organs, blood vessels or nerves.**

**WARNING: Hemostasis must be achieved prior to dressing placement.**

Determine the orientation of the dressing for the specific application. If Visceral Protective Layer will be placed around tubes, drains or the falciform ligament, **cut only between the foam extensions, as shown.** (Do not cut near or through foam extensions).

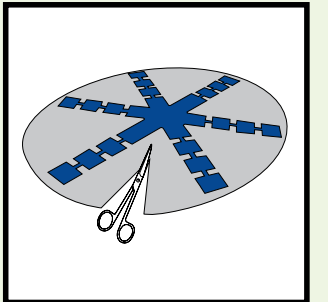

### Option 1: Folding Visceral Protective Layer to Size (Recommended method)

Hold dressing by the edge and slightly lift. Then slowly lower dressing into the pericolic gutter, while using the other hand to gently and evenly work the dressing down. Fold any excess Visceral Protective Layer up and over onto itself.

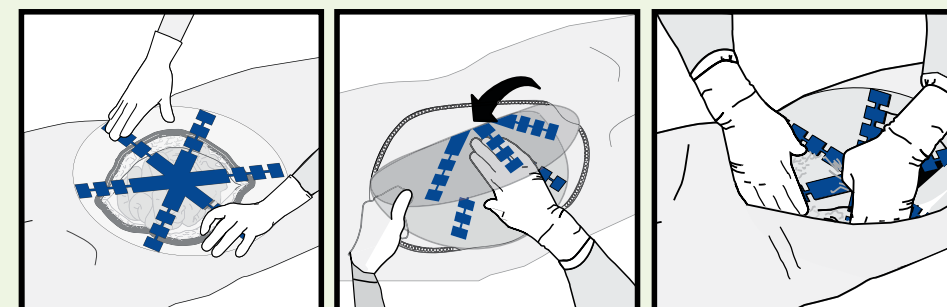

### Option 2: Cutting Visceral Protective Layer (VPL) to Size

**Note:** Since the VPL should be tucked deep into the paracolic gutters, it is often unnecessary to cut VPL. See Option 1 for recommended method.

1. Cut Visceral Protective Layer, away from wound, through center of large foam squares using sterile scissors (Fig. A). Do not cut through the narrow connecting tabs between the large foam squares.
2. Pinch the remaining half of the foam square and its connecting tab and pull. The foam and tab will separate at the next square (Fig. B). This will ensure that edge of Visceral Protective Layer covers exposed foam edge (Fig. C); foam cannot contact organs, see **WARNING** above.

**NOTE:** Document number of foam extensions removed and that each piece has been properly disposed of away from wound cavity.

**CAUTION:** Do not tear the foam over the wound, as fragments may fall into the wound. Rub or trim foam away from the wound, removing any fragments to ensure loose particles will not fall into or be left in the wound upon dressing removal.

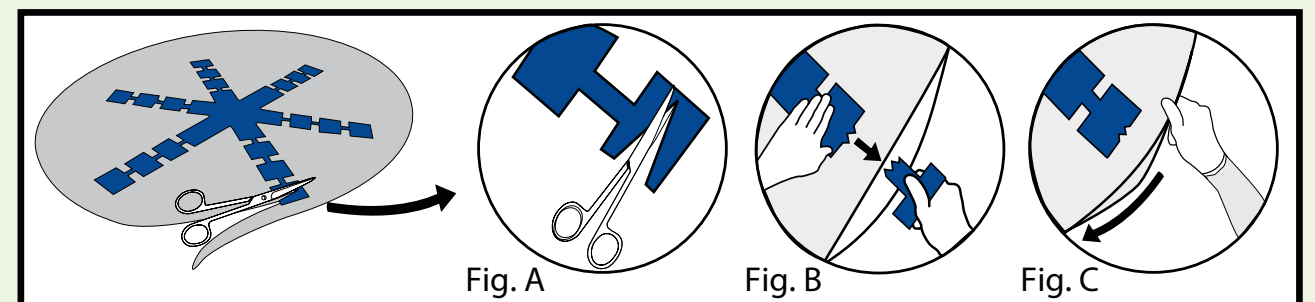

### Perforated Foam and Drape Application

**Note:** Since the VPL should be tucked deep into the paracolic gutters, it is often unnecessary to cut VPL. See Option 1 for recommended method.

Gently place Perforated Foam into wound cavity over the Visceral Protective Layer. Ensure that Perforated Foam does not go below the level of the abdominal incision or wound. Do not force the foam into any area of the wound.

**CAUTION:** Do not tear the foam over the wound, as fragments may fall into the wound. Rub or trim foam away from the wound, removing any fragments to ensure loose particles will not fall into or be left in the wound upon dressing removal.

**NOTE:** To avoid trauma to the periwound skin, do not pull or stretch the Drape over the foam dressing. Minimize wrinkles, as they may be a source of negative pressure leaks (refer to **Precautions, Protect Periwound Skin** section of Instructions for Use).

**NOTE:** When using multiple pieces of Drape, ensure that the edges of the Drape overlap in order to achieve a seal. Cut a **2.5cm** hole in drape for application of SENSAT.R.A.C.™ Pad.

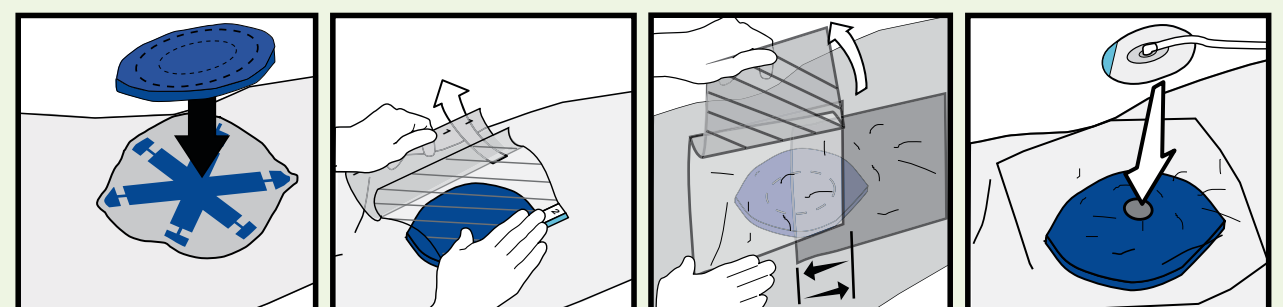

To learn more, please contact your Acelyty Representative, or visit us at [kci-medical.com](http://kci-medical.com)

**NOTE:** Specific indications, contraindications, warnings, precautions and safety information exist for KCI products and therapies. Please consult a clinician and product instructions for use prior to application.

ABTHERA™ SENSAT.R.A.C.™ OA Dressing is designed for use with the negative pressure wound therapy provided by the INFOV.A.C.™ and V.A.C.ULTA™ Therapy Units. When using the V.A.C.ULTA™ Therapy Unit, do not select the V.A.C. VERAFLU™ Instillation Therapy option. See instructions for use. ABTHERA™ OA Dressing is for use only with ABTHERA™ NPT unit.

Copyright 2016, 2018 KCI Licensing, Inc. All rights reserved. Unless otherwise designated, all trademarks are proprietary to KCI Licensing, Inc., its affiliates and/or licensors. PRA-PM-EU-00084 (11/18)