

3M™ Versaflo™ M-Series Headtops* with 3M™ Speedglas™ Welding Attachments

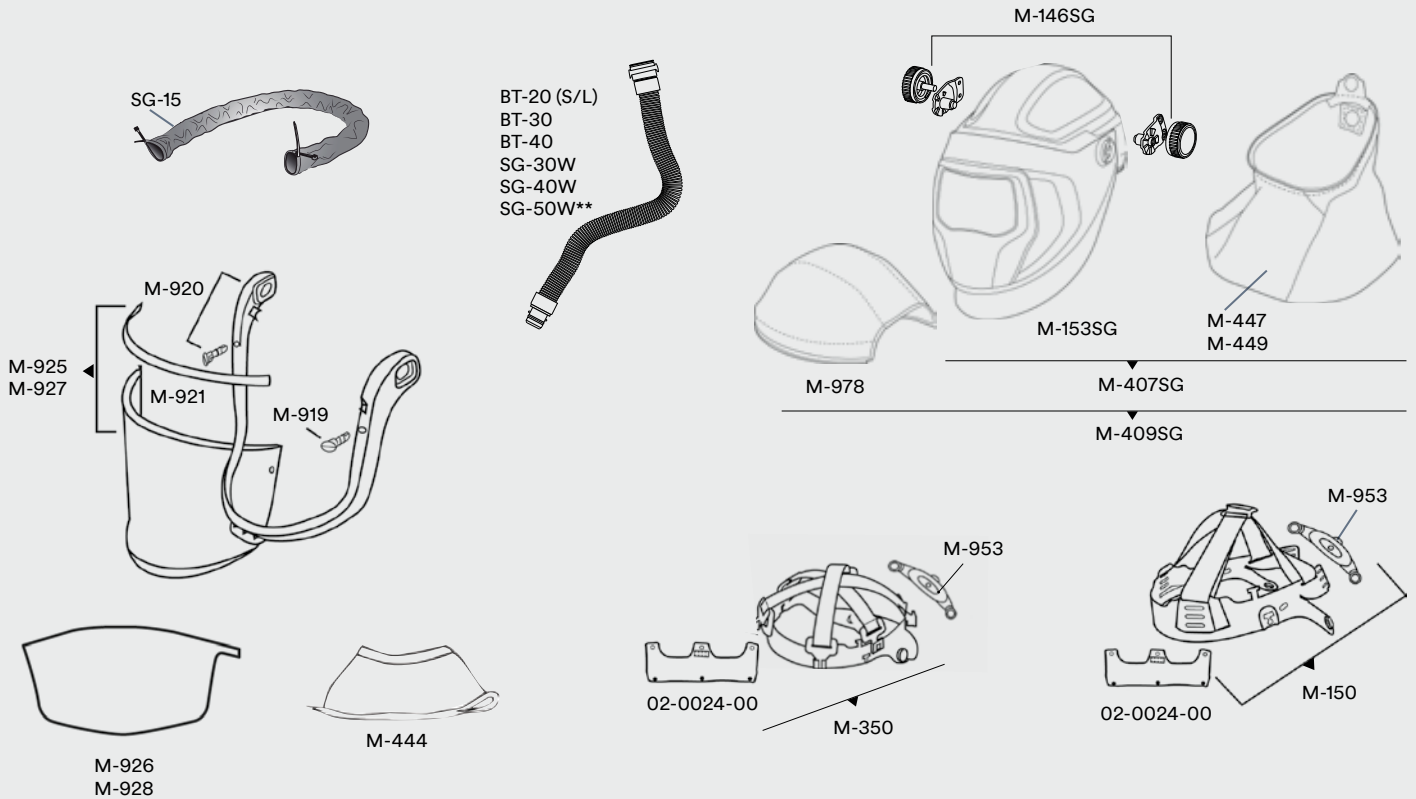

Spare parts & accessories



Part No	Description	Part No	Description	Part No	Description
02-0024-00	Sweatband, fleecy cotton, 2/case	M-153SG	Helmet M-407 with Speedglas welding shield, without welding filter	M-920	Visor frame
38-1101-30iSW	Helmet M-407 with Speedglas welding shield, 9100XXi welding filter and Adflo powered air respirator	M-207	Faceshield assembly M207	M-921	Visor gasket
38-1101-00SW	Helmet M-407 with Speedglas welding shield, without welding filter, with Adflo powered air respirator	M-307	Helmet M-307	M-925	Standard Visor
BT-20L	Breathing tube, polyurethane (size: large), with QRS connection	M-350	Head suspension for headtop series M-300 and M-400	M-926	Peel-off visor cover for M-925
BT-20S	Breathing tube, polyurethane (size: short), with QRS connection	M-407	Helmet M-407 with shroud	M-927	Premium Visor
BT-30	Breathing tube, self-adjusting (20.7" to 33.5"), with QRS connection	M-407SG	Helmet M-407 with flame resistant shroud (M-447) and Speedglas welding shield, without welding filter	M-928	Peel-off visor cover for M-927
BT-40	Breathing tube, heavy-duty rubber, with QRS connection	M-409SG	Helmet M-407 with flame resistant helmet cover, leather shroud (M-449) and Speedglas welding shield, without welding filter	M-956	Ratchet comfort pad
M-146SG	Helmet knobs and pivot kit for welding shield	M-444	Inner shroud	M-978	Helmet cover
M-150	Head suspension (M-207).	M-447	Flame resistant outer shroud	SG-15	Flame resistant breathing tube cover (replaces 17-0099-54)
		M-449	Leather outer shroud	SG-30W	Breathing tube, self-adjusting, with
		M-919	Visor frame buttons	SG-40W	QRS connection
				SG-50W**	Breathing tube, heavy-duty, with QRS connection
					Breathing tube, sound-dampening, with QRS connection

*Only intended for use with M-207, M-307, M-407, M-407SG, and M-409SG

**The 3M™ Speedglas™ Breathing Tube SG-50W is required when used with Adflo™ PAPR and 3M™ Speedglas™ Welding Helmets M-407, M-407SG, and M-409SG.