

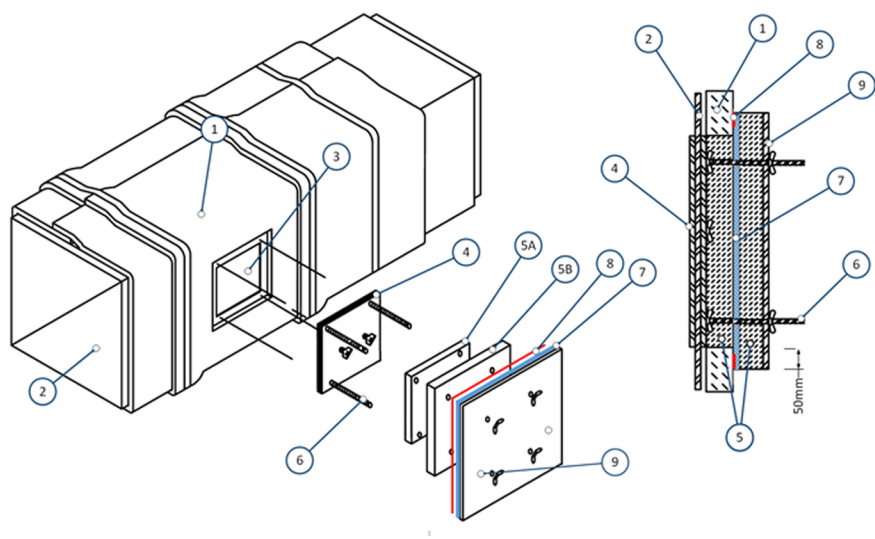

**3M™ Fire Protection**  
**Design Specification Sheet : OC-6001**  
15/05/2018

| Access Door:                            | Construction Type                         | FRL / FRR   | Reference as per                                                |
|-----------------------------------------|-------------------------------------------|-------------|-----------------------------------------------------------------|
| Ducting<br>Internal & External Exposure | Ducting,<br>Minimum pressure Class 1000Pa | 120/120/120 | AS 1530.4 & AS 4072.1<br>Report # FCO-3273<br>BRANZ FAR 4812-TO |

**3M™ Fire Barrier Duct Wrap 615+  
Fire Stopping System**  
**Access Doors**  
**Interface with Single Layer 3M Fire Barrier Duct Wrap 615+**



- ① 3M Duct Wrap 615+, pre-applied to the Duct (1 or 2 layer system).
- ② Ductwork, constructed to AS 4254, pressure class 1000 Pa or higher.
- ③ Opening cut in ductwork to suit appropriate size of access door.
- ④ Pre-fabricated, access door
- ⑤ (A) & (B) 3M Duct Wrap 615+ Inner insulation Door Cover (C) outer door cover.
- ⑥ Duct Mate Ultimate 3M Duct Wrap 615+ extension bolt kit (supplied with Access door insulation kit)
- ⑦ 16mm thick fire resistant plasterboard
- ⑧ 3M Intumescent Strip (20mm minimum width, around perimeter, bonded to ⑦)
- ⑨ Duct Wrap Steel Cover Plate (supplied with Access door insulation kit)



**3M™ Fire Protection**  
**Design Specification Sheet : OC-6001 continued**  
15/05/2018

## 3M™ Fire Barrier Duct Wrap 615+ Fire Stopping System

### Access Doors

#### Interface with Double Layer 3M Fire Barrier Duct Wrap 615+

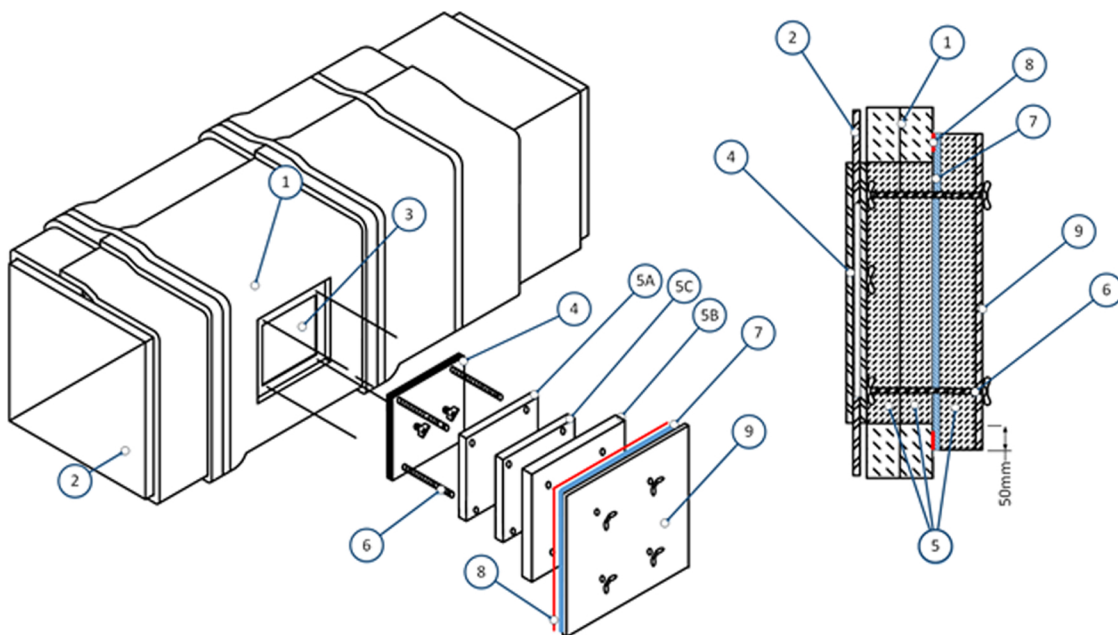

**General Procedure :** Cut hole in the duct using the template supplied with the pre-fabrication access door, and pre-install the door as per the access doors supplied instructions.

The four corner-thumb bolts supplied with the access door are replaced with four 3.75 mm Ø all-thread, steel rods (⑥ supplied in Access Door Insulation Kit), and extend from access door (item ④).

Depending on the duct system; layering two or three layers of 3M Duct Wrap 615+ (⑤ A & B or A,B&C) (are applied) over the pre-fabricated access door.

The 1st piece, ⑤A, is cut to minimum of 12mm larger than the access opening. It is positioned, square, and impaled over the threaded rods ⑥ extending from the access door.

Press the first piece of 3M Duct Wrap 615+ flush over the pre-fabricated access door and compress and abut the cut edges against the edges of the opening

For interface with a 2 layer system, a second piece of 3M Duct Wrap 615+ is cut and installed ⑤c. Cut a piece of 16 mm thick fire resistant plasterboard with a minimum of 50mm larger than the installed piece(s) of 3M Duct Wrap 615+.

⑦ Fire resistant plasterboard

⑧ 3M Intumescent Strip (20 mm minimum width, around perimeter, bonded to ⑦)

Procedure continued on page 3



**3M™ Fire Protection**  
**Design Specification Sheet : OC-6001 continued**  
15/05/2018

## 3M™ Fire Barrier Duct Wrap 615+ Fire Stopping System

### Access Doors

#### Interface with Double Layer 3M Fire Barrier Duct Wrap 615+

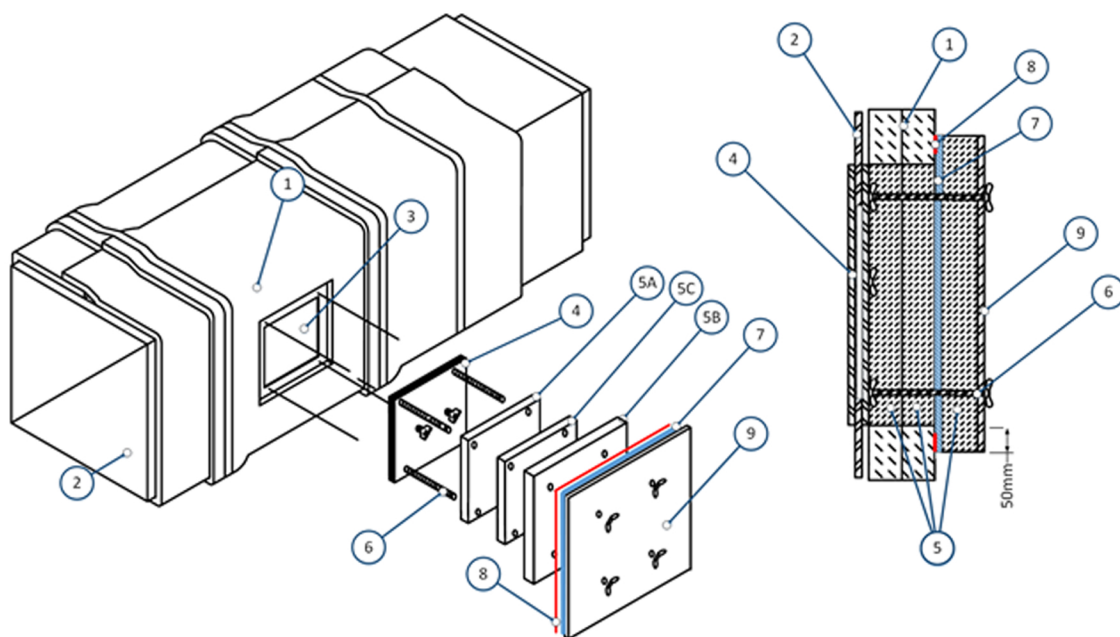

**General Procedure Continued:** Apply 3M Self Adhesive intumescent strip, with a minimum of 20mm width, to the perimeter of the plasterboard, with flush fitting mitre cut corner joints. Drill holes in the plasterboard that match the location of the four all-thread, steel rods and locate the holes so that the plasterboard is squared.

Install the plasterboard over the threaded rod, with the intumescent strip side facing the duct.

Cut a final piece of 3M Duct Wrap 615+ with a minimum of 50mm larger than the installed pieces of 3M Duct Wrap 615+ (the same size as the plasterboard). Seal all cut edges of this layer with 3M Foil Tape 425. Position, square, and impale the final piece of the 3M Duct Wrap 615+ over the threaded rods.

Press the final piece of access insulation flush over the plasterboard. After all layers of access door insulation are impaled over the threaded rods, install the cover plate supplied with the access door insulation kit (item ⑨).

Place washers and wing nuts onto each of the threaded rods and secure the cover plate by tightening the wing nuts.

**3M Australia Pty Ltd**  
**Industrial Adhesives & Tapes Division**  
Phone 136 136 (Option 2)  
3mindustrialau@mmm.com  
www.3m.com.au/fireprotection

**3M New Zealand Ltd**  
**Industrial Adhesives and Tapes Division**  
Phone 0800 474 787  
3mnzibt@mmm.com  
www.3m.co.nz/fireprotection

User is responsible for determining whether the 3M product is fit for a particular purpose and suitable for user's application. Limitation of Liability. Except where prohibited by law, 3M will not be liable for any loss or damage arising from this 3M product, whether direct, indirect, special, incidental or consequential, regardless of the legal theory asserted, including warranty, contract, negligence or strict liability. 3M is a trademark of 3M Company.