

# ADJUSTABLE HEIGHT JIB ASSEMBLY

FOR MODEL #'S  
8530557, 8530558, & 8530559

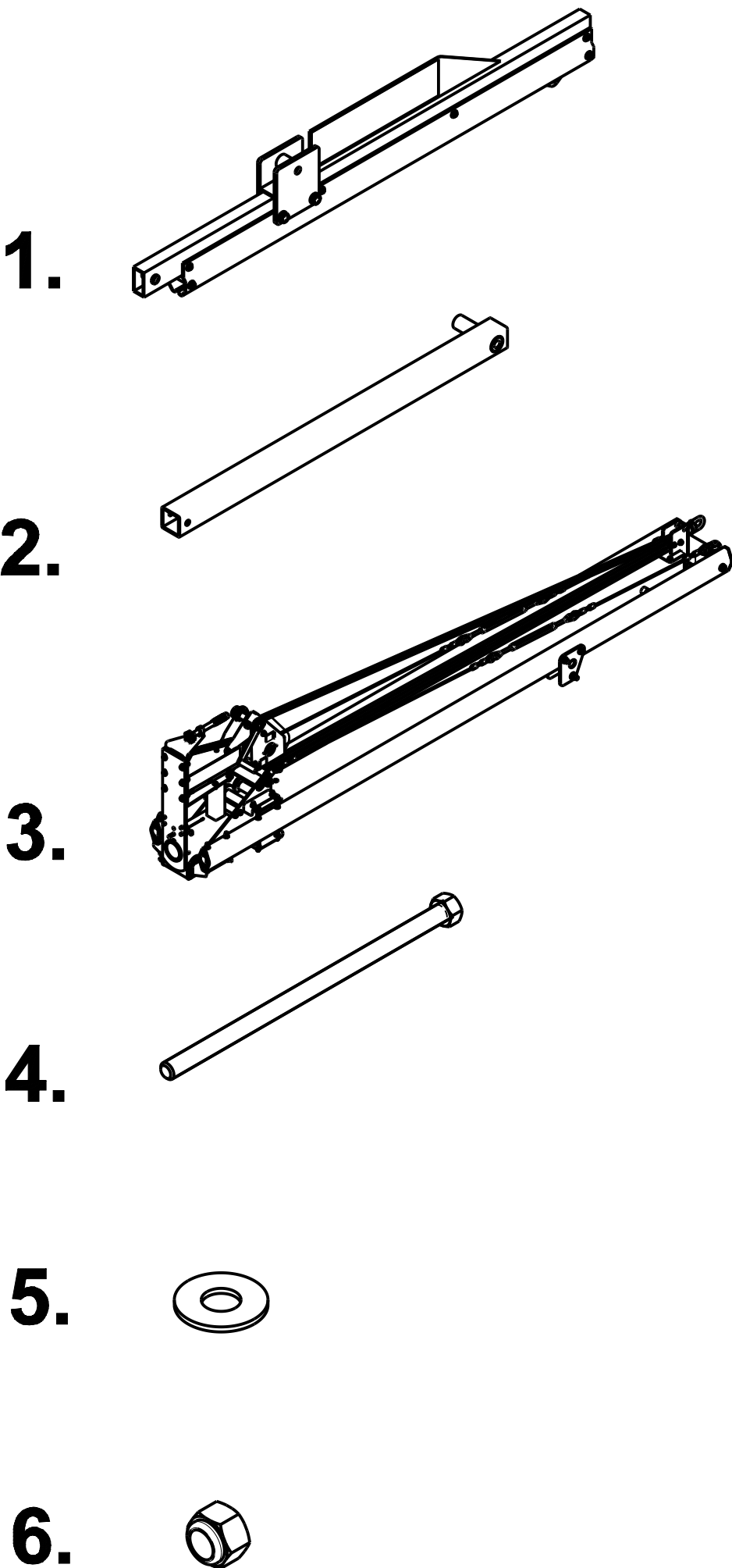

STEP 1 - UNCRATE AND IDENTIFY ALL OF THE COMPONENTS IN THE COMPONENTS LIST.

NOTE: ITEM 3 HAS A LIFTING RING FOR POSITIONING VIA CRANE OR FORKLIFT

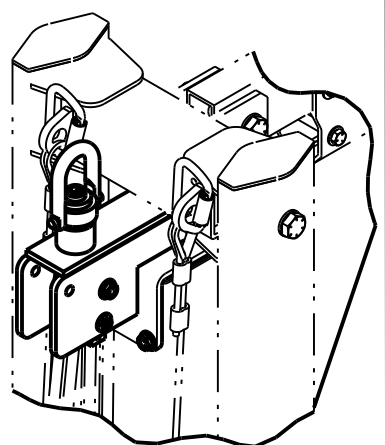

STEP 2 - POSITION ITEM 3 ON ITS SIDE AND SPACE IT OFF THE GROUND WITH A SPACER AS SHOWN.

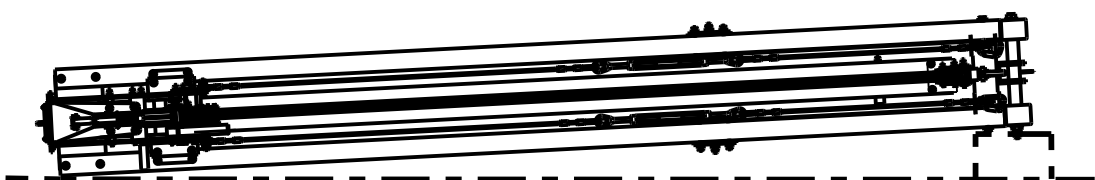

STEP 3 - ATTACH ITEM 1 TO ITEM 3. FINGER TIGHTEN HARDWARE. FINAL TIGHTENING OF HARDWARE IN STEP 5.

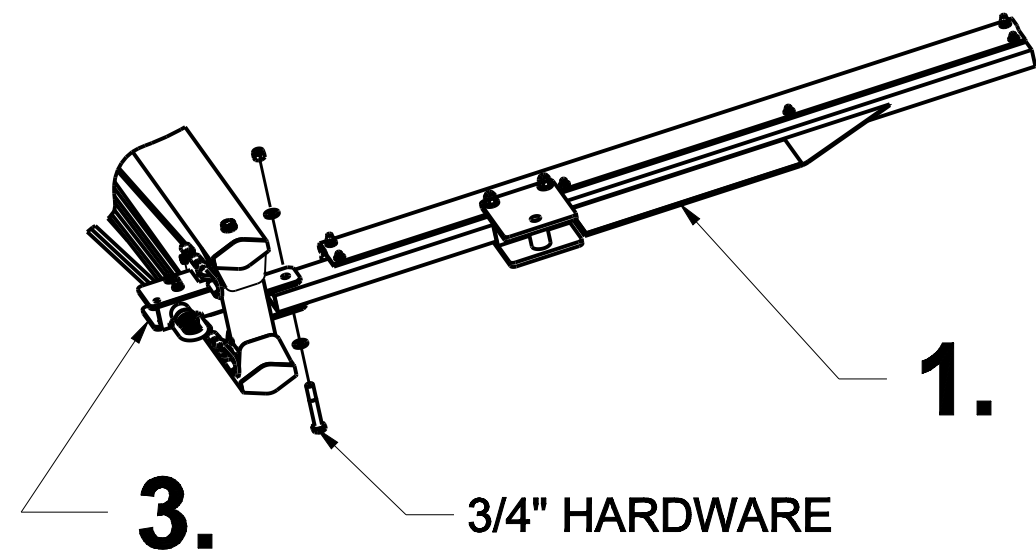

STEP 4 - USE THE ITEM 2'S TO CONNECT THE ITEM 1 TO ITEM 3. FINGER TIGHTEN HARDWARE. FINAL TIGHTENING OF HARDWARE IN STEP 5.

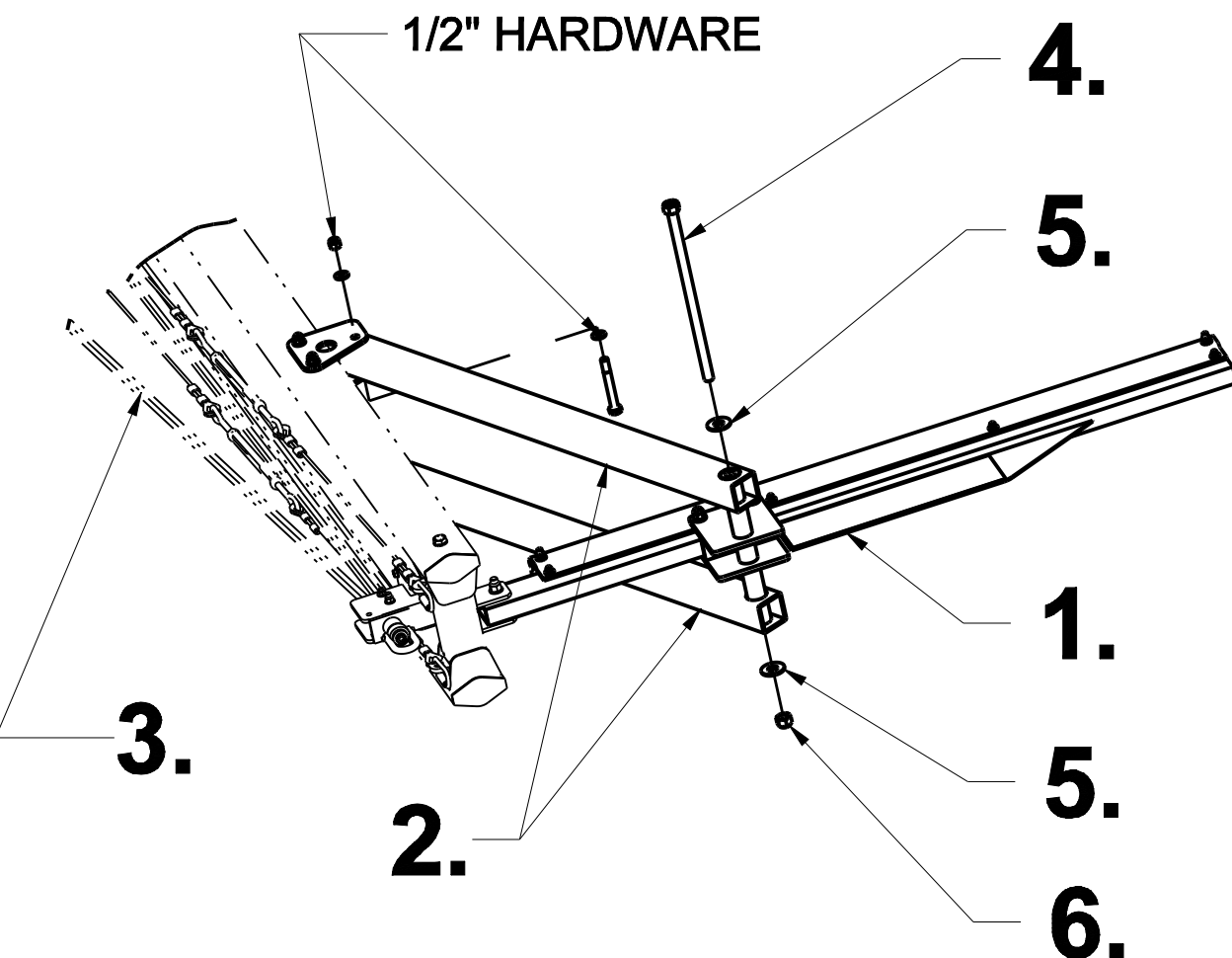

STEP 5 - FINAL TORQUE THE CONNECTING HARDWARE TO THE SPECIFICATIONS BELOW.

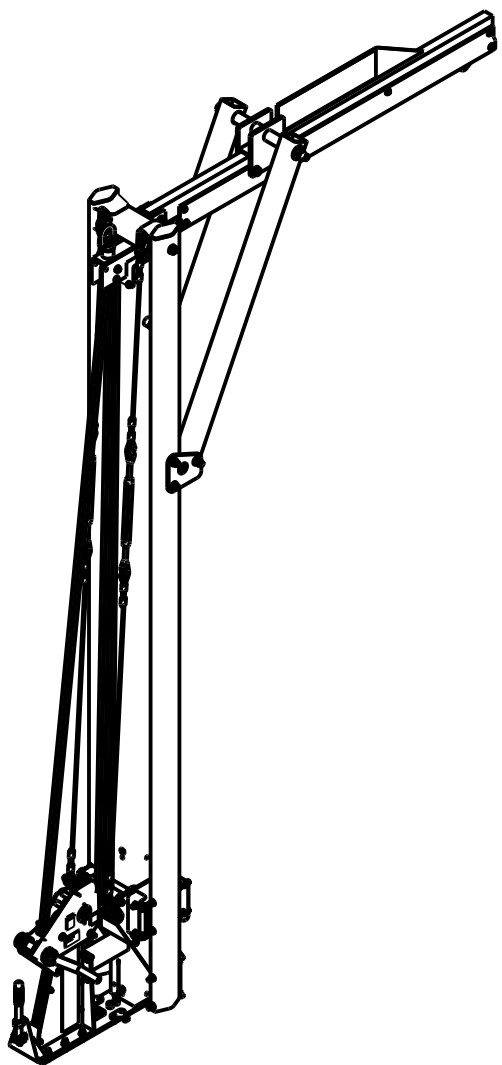
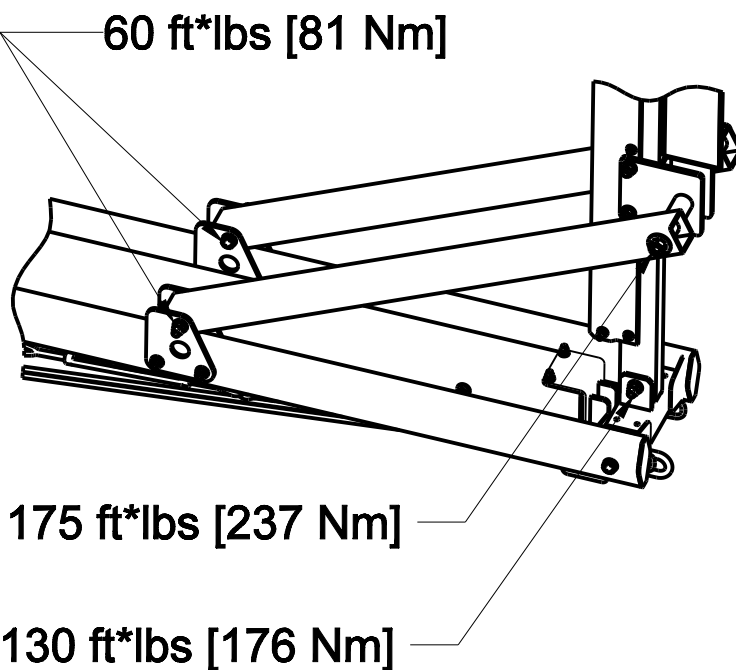

COMPONENTS LIST			
ITEM	QTY	PART NO.	DESCRIPTION
6	1	8522156	NUT, LOCK, 1, NYLONG
5	2	8513789	WASHER, FLAT, 1, W, ZP
4	1	8545007	WELDMENT, BOLT, 1-8X20.75, ZP, GR B7
3	1	-----	UPRIGHT ASSEMBLY
2	2	8544100	WELDMENT, GUSSET, JIB SUPPORT, 6.5' OFFSET
1	1	8544096	GLIDERAIL ASSY6.5', JIB RAIL

## TOOLS REQUIRED

- 1-1/2 SOCKET AND WRENCH
- 1-1/8 SOCKET
- 1-1/16 WRENCH
- 3/4" SOCKET AND WRENCH
- TORQUE WRENCH

THIS DRAWING AND THE INFORMATION CONTAINED HEREIN IS AND SHALL REMAIN THE PROPERTY OF CAPITAL SAFETY, AND CANNOT BE USED OR REPRODUCED WITHOUT PERMISSION. ANY MATERIAL AND/OR PART SUBSTITUTIONS AND/OR CHANGES MUST BE AUTHORIZED IN WRITING BY CAPITAL SAFETY PRIOR TO USE.		Capital Safety 3833 SALA Way RED WING, MN 55066-5005 651-388-8282	capital SAFETY www.capitalsafety.com
SCALE	PROE	TITLE EMU JIB ASSEMBLY INSTRUCTION	
DO NOT SCALE DRAWING	DRAWING NUMBER 5903390	REVISION B	

# FIXED HEIGHT JIB ASSEMBLY

FOR MODEL #'S  
8530571

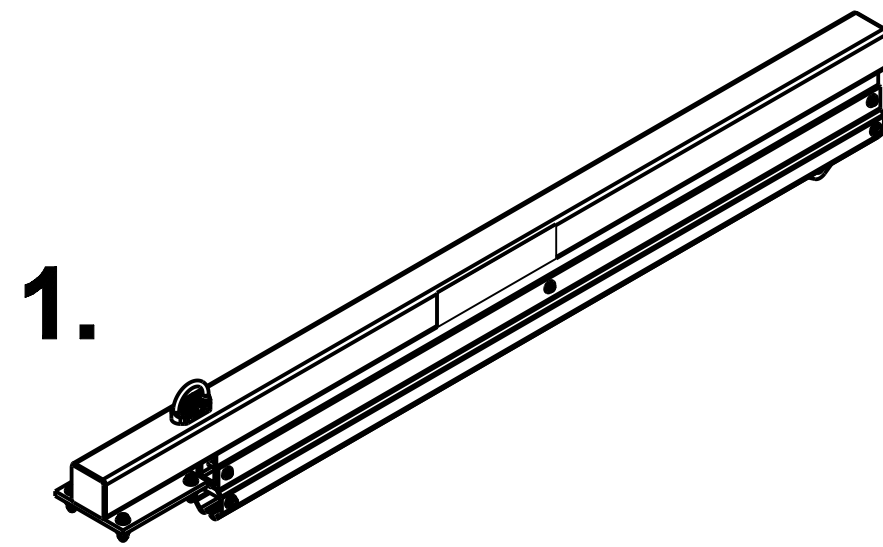

STEP 1 - UNCRATE AND IDENTIFY ALL OF THE COMPONENTS IN THE COMPONENTS LIST.

NOTE: ITEM 1 HAS A LIFTING RING FOR POSITIONING VIA CRANE OR FORKLIFT

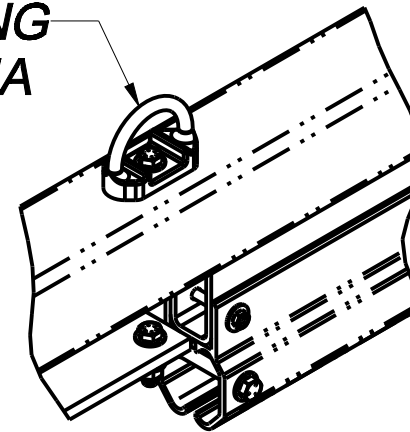

SEE DETAIL A

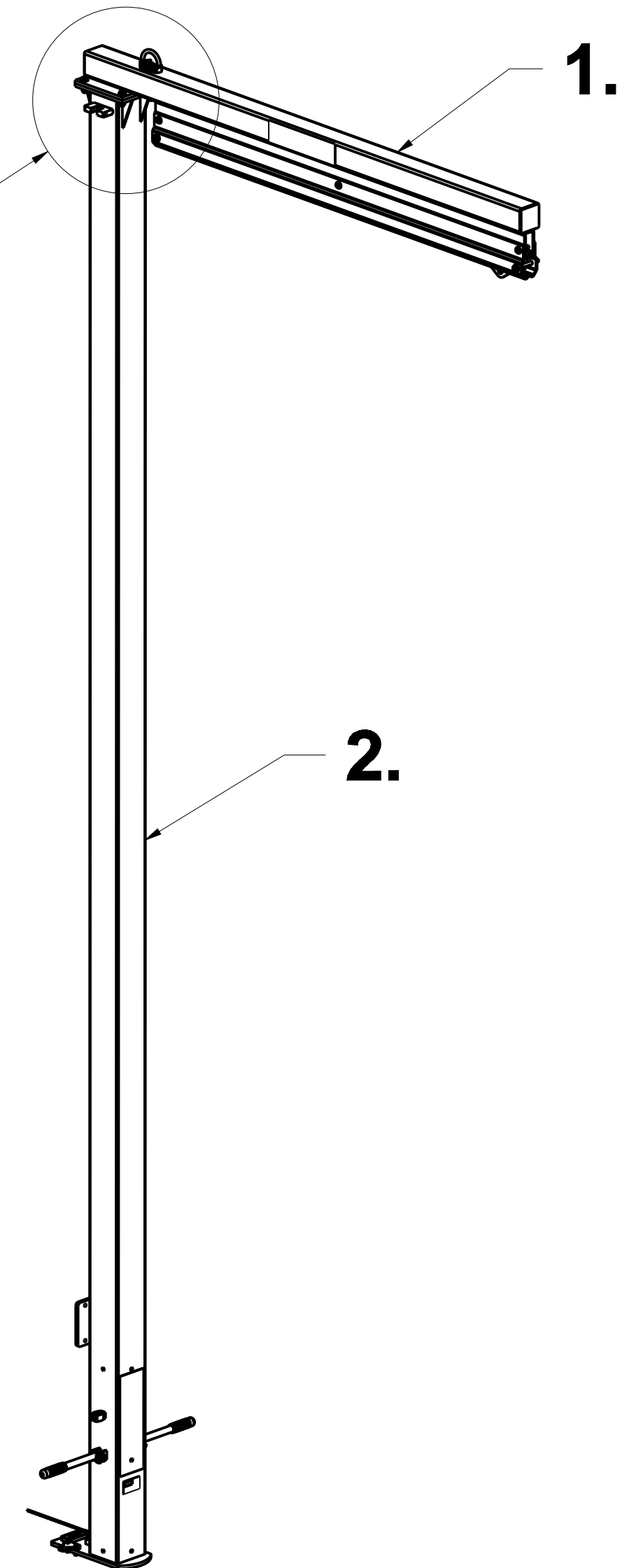

STEP 2 - ATTACH ITEM 1 TO ITEM 2. TORQUE ALL HARDWARE TO 60 FT\*LBS [81 N\*m].

4X 1/2" HARDWARE

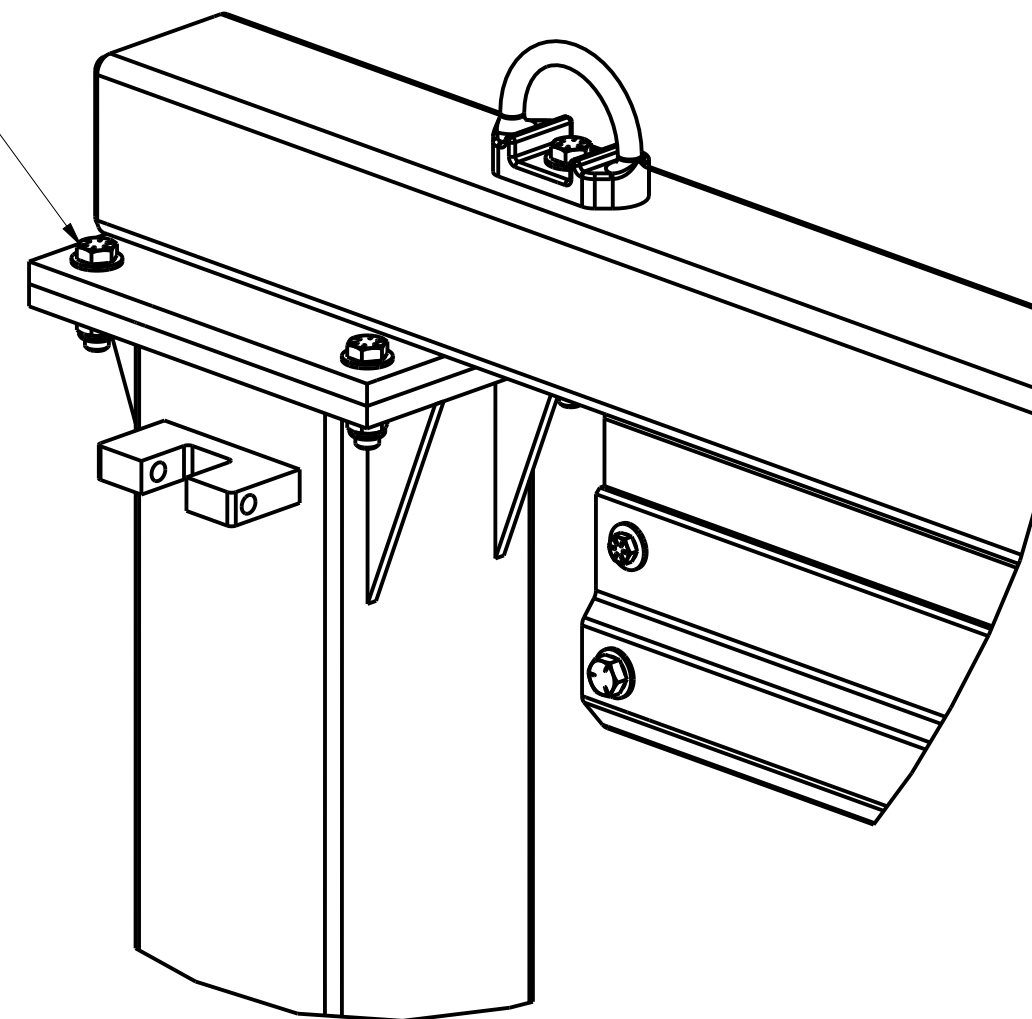

DETAIL A  
SCALE 0.250

## COMPONENTS LIST

ITEM	QTY	PART NO.	DESCRIPTION
2	1	8545774	UPRIGHT,ASSEMBLY,FIXED HEIGHT EMU
1	1	8545771	OFFSET ARM,ASSEMBLY,FIXED HEIGHT EMU

## TOOLS REQUIRED

3/4 SOCKET

3/4 WRENCH

TORQUE WRENCH

THIS DRAWING AND THE INFORMATION CONTAINED HEREIN IS AND SHALL REMAIN THE PROPERTY OF CAPITAL SAFETY, AND CANNOT BE USED OR REPRODUCED WITHOUT PERMISSION. ANY MATERIAL AND/OR PART SUBSTITUTIONS AND/OR CHANGES MUST BE AUTHORIZED IN WRITING BY CAPITAL SAFETY PRIOR TO USE.

Capital Safety  
3833 SALA Way  
RED WING, MN  
55066-5005  
651-388-8282

capital  
SAFETY

SCALE PROE

TITLE EMU JIB ASSEMBLY INSTRUCTION

DRAWING NUMBER

DO NOT SCALE DRAWING

5903390

REVISION

B