



Instructions for the following product:
CONCRETE MOUNTED JIB BASE

Model No: 8530483

USER INSTRUCTION MANUAL:
CONCRETE MOUNTED JIB BASE

WARNING: This product is part of a fall arrest or rescue system. These instructions must be provided to all users and rescuers using this equipment. The user must read and understand these instructions before using this equipment. The user must follow the manufacturer's instructions for each component of the system. Manufacturer's instructions must be followed for proper use and maintenance of this equipment. Alterations or misuse of this equipment, or failure to follow instructions, may result in serious injury or death.

IMPORTANT: If you have questions on the use, care, or suitability of this equipment for your application, contact Capital Safety.

IMPORTANT: Before using this equipment, record the product identification information from the ID label into the inspection and maintenance log on Pages 6-7 of this manual.

IMPORTANT: Systems are designed to be used with Jib Systems manufactured by Capital Safety Group Only.

FIGURE 1

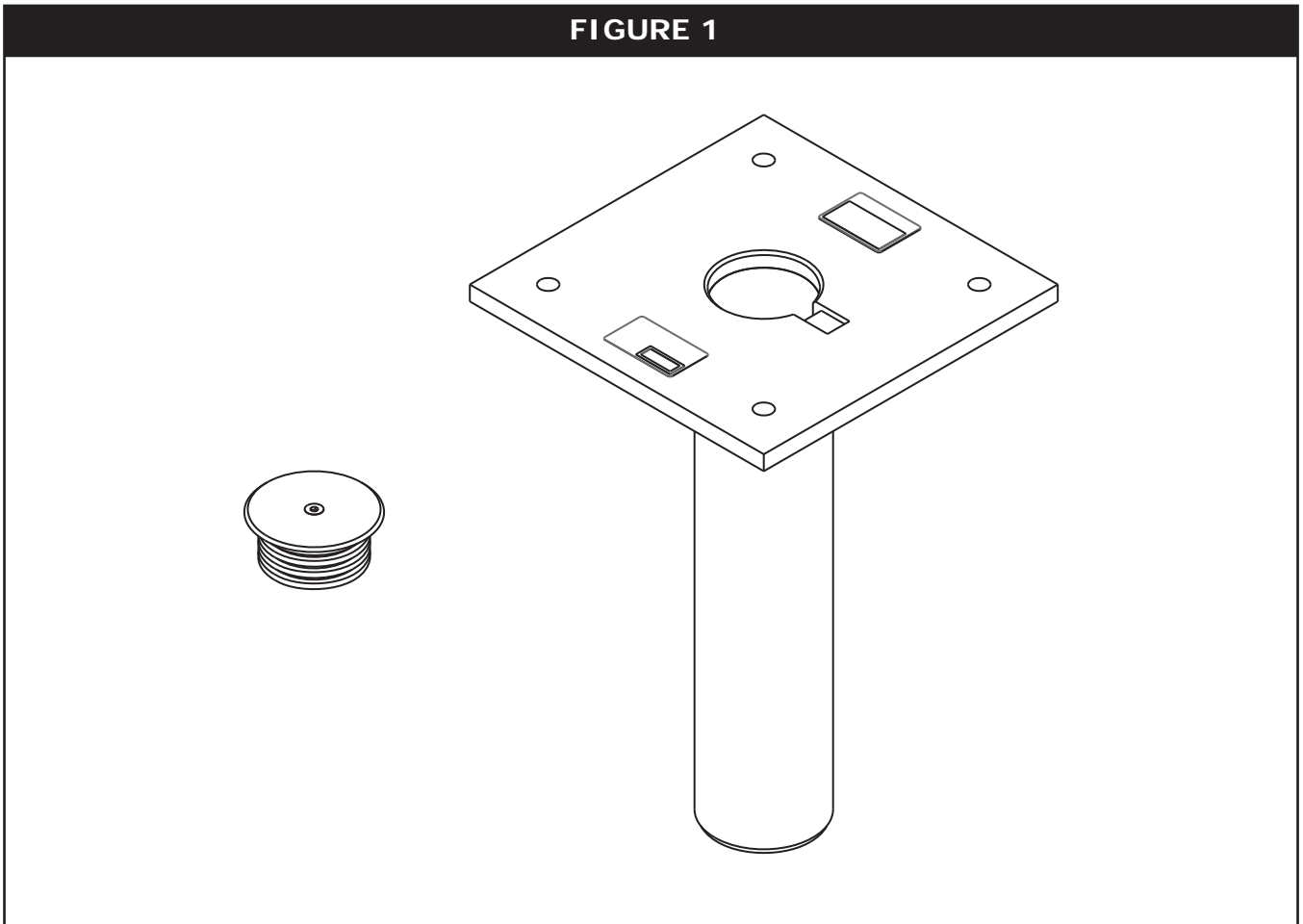

STEP 1- DRILLING CORE AND MOUNTING HOLES INTO CONCRETE:

- Drill a $\text{Ø}5.06$ [129] hole at a depth of 22.75" [578] into the existing concrete.
- Drill the mounting holes into the concrete using the dimensions specified in Figure 2.
- The mounting hardware used must be able to support a minimum moment load of 172,800 in*lbs (19,524 N*m) and a minimum vertical load of 1,800 lb. (816 kg). *Mounting hardware provided by end user.* The mounting hardware must be able to fit through the $\text{Ø}13/16$ " [4.65] mounting holes on the Jib Base.

SEE FIGURE 2 FOR ILLUSTRATION OF STEP 1.

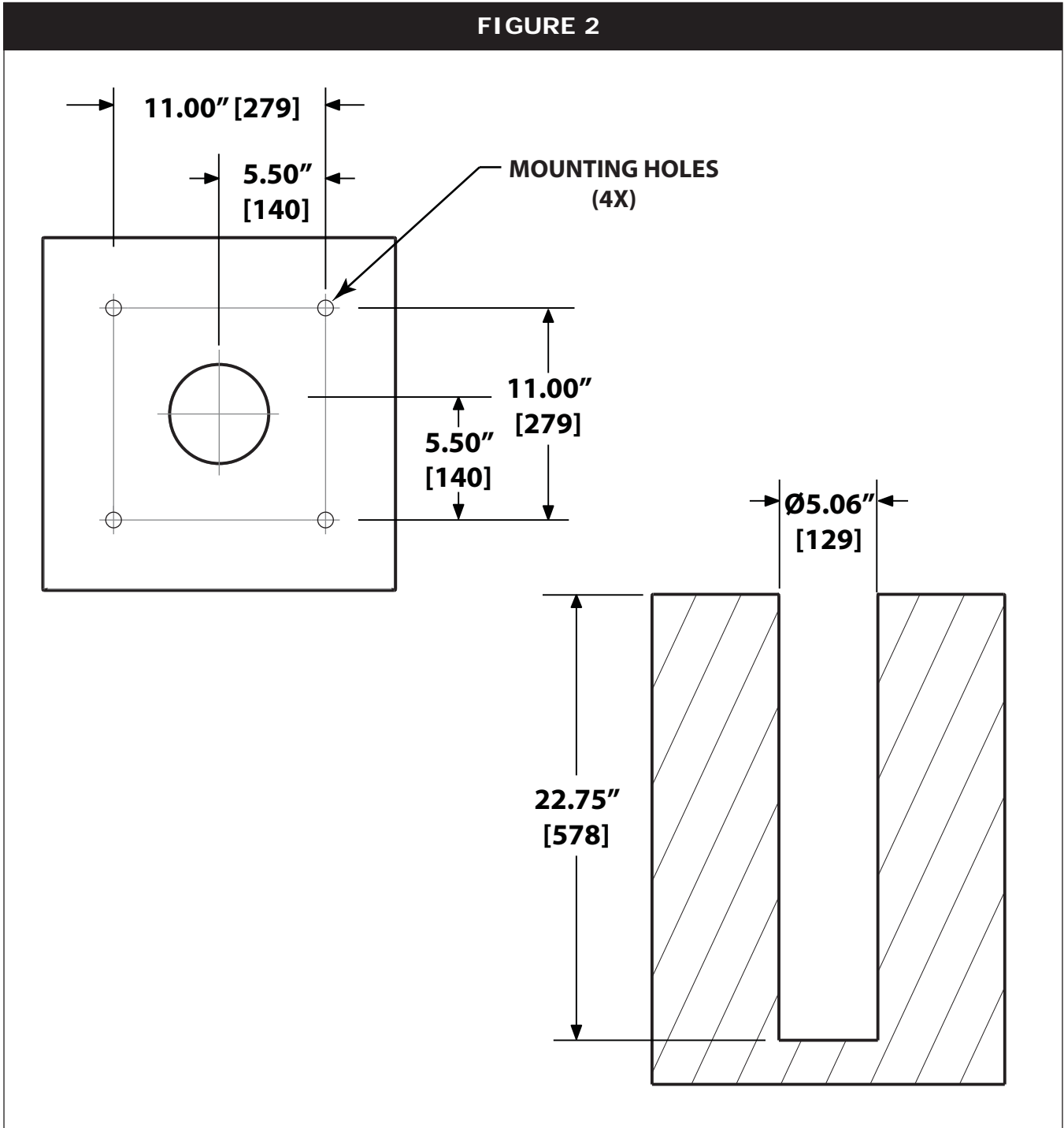

STEP 2- FASTENING THE CONCRETE MOUNTED JIB BASE:

- After the Concrete Anchors have cured over the appropriate time continue onto Step 2.
- Make sure the core hole is clean of any debris before inserting the Jib Base.
- Fasten the Jib Base to the existing concrete by tightening the concrete anchors to the appropriate torque specifications.

SEE FIGURE 3 FOR ILLUSTRATION OF STEP 2.

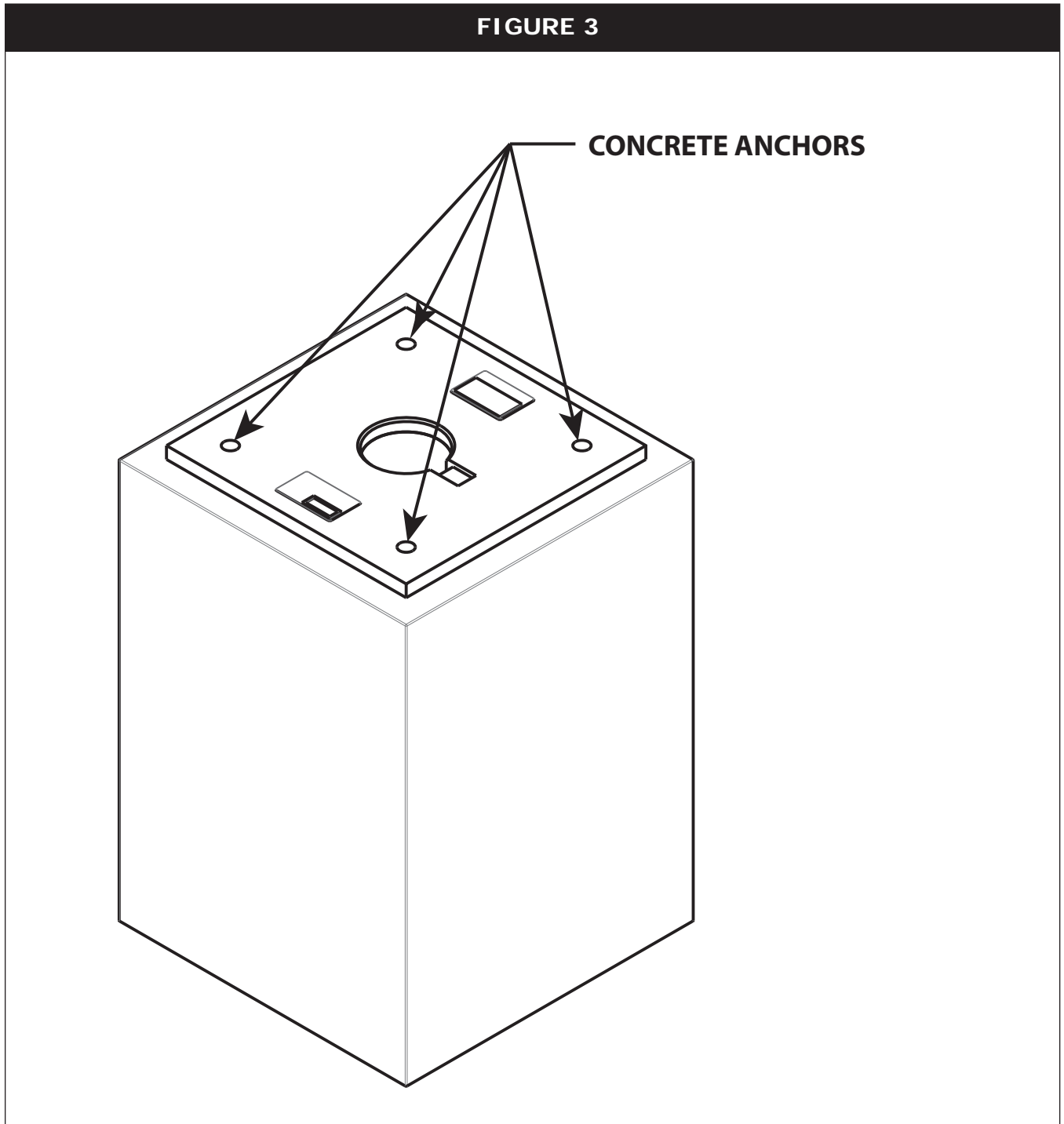

STEP 3- INSTALLING THE JIB MAST INTO THE JIB BASE:

- Secure a lifting device (crane, forklift, or etc.) to the Lifting Ring on the Jib Mast, insert the Jib Mast into the Jib Base.
- Lower the Jib Mast until the Rotation Block is resting in the Locking Slot in the Jib Base.
- Insert the Base Cap into the Jib Base when the Jib Mast is not in the Jib Base.

SEE FIGURE 4 FOR ILLUSTRATIONS FOR STEP 3.

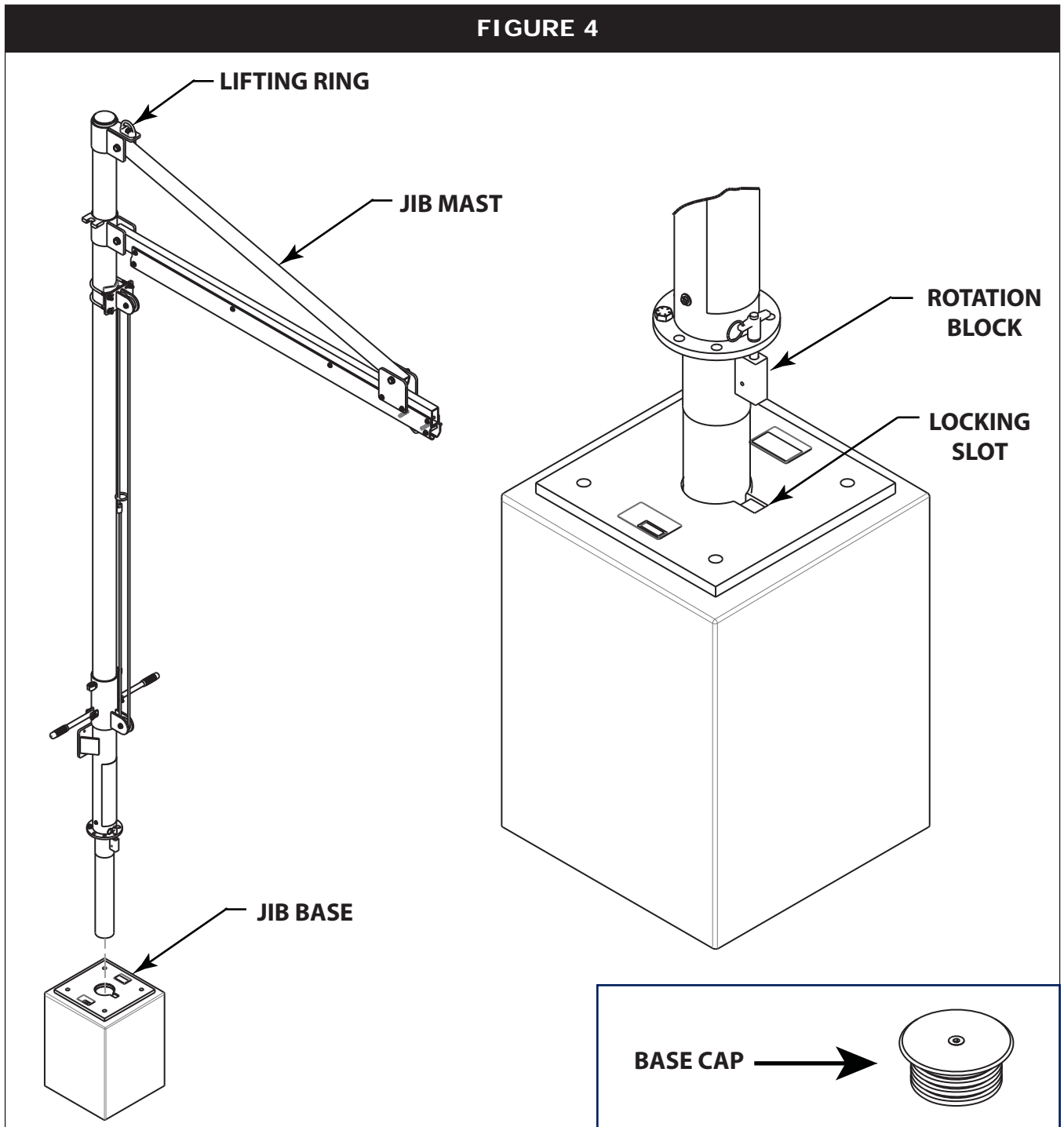

General Specifications:

General Construction	Welded Steel
Structural Material	A36 Steel
Finish	Zinc Plate Per ASTM B633, Type II
Hitch Pin Material	A36 Steel
Hitch Pin Finish	Zinc Plate
Weight of System	90 lbs (41 kg)

Inspection:

Before Every Use:

- *All fasteners must be tight, secure and not damaged.
- *Inspect for corrosion or rust.
- *All labels must be present and fully legible.
- *Inspect for cracks in the concrete around the Jib Base.
- *Record results of inspection in the inspection and maintenance log provided.
- *If inspection reveals an unsafe or defective condition, Concrete Mounted Jib Base from service and destroy, or contact Capital Safety Group for repair or replacement.

Monthly:

- *A formal inspection should be done by a competent person other than the user.
Record results of inspection in the inspection and maintenance log provided.

IMPORTANT: Extreme working conditions (harsh environments, prolonged use) may require increasing the frequency of inspections.

WARNING: If the system has been damaged do to fall arrest, it must be immediately removed from service, inspected, or contact Capital Safety Group for repair or replacement.

LABELING

The following labels must be present and fully legible:

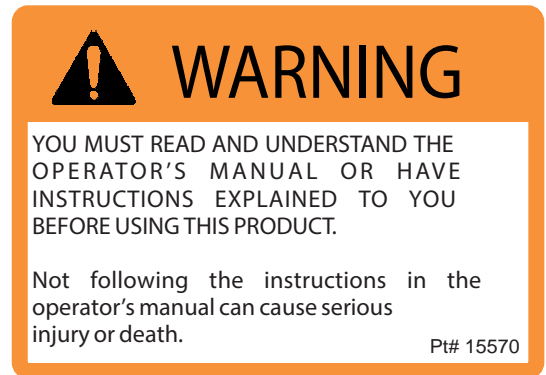

SERIAL NUMBER:			
MODEL NUMBER:			
DATE PURCHASED:			DATE OF FIRST USE:

INSPECTION DATE	INSPECTION ITEMS NOTED	CORRECTIVE ACTION	MAINTENANCE PERFORMED
Approved By:			
Approved By:			
Approved By:			
Approved By:			
Approved By:			
Approved By:			
Approved By:			
Approved By:			
Approved By:			
Approved By:			
Approved By:			
Approved By:			
Approved By:			
Approved By:			
Approved By:			
Approved By:			
Approved By:			
Approved By:			
Approved By:			

LIMITED LIFETIME WARRANTY

Warranty to End User: D B Industries, Inc., dba CAPITAL SAFETY USA ("CAPITAL SAFETY") warrants to the original end user ("End User") that its products are free from defects in materials and workmanship under normal use and service. This warranty extends for the lifetime of the product from the date the product is purchased by the End User, in new and unused condition, from a CAPITAL SAFETY authorized distributor. CAPITAL SAFETY'S entire liability to End User and End User's exclusive remedy under this warranty is limited to the repair or replacement in kind of any defective product within its lifetime (as CAPITAL SAFETY in its sole discretion determines and deems appropriate). No oral or written information or advice given by CAPITAL SAFETY, its distributors, directors, officers, agents or employees shall create any different or additional warranties or in any way increase the scope of this warranty. CAPITAL SAFETY will not accept liability for defects that are the result of product abuse, misuse, alteration or modification, or for defects that are due to a failure to install, maintain, or use the product in accordance with the manufacturer's instructions.

CAPITAL SAFETY'S WARRANTY APPLIES ONLY TO THE END USER. THIS WARRANTY IS THE ONLY WARRANTY APPLICABLE TO OUR PRODUCTS AND IS IN LIEU OF ALL OTHER WARRANTIES AND LIABILITIES, EXPRESSED OR IMPLIED. CAPITAL SAFETY EXPRESSLY EXCLUDES AND DISCLAIMS ANY IMPLIED WARRANTIES OF MERCHANTABILITY OR FITNESS FOR A PARTICULAR PURPOSE, AND SHALL NOT BE LIABLE FOR INCIDENTAL, PUNITIVE OR CONSEQUENTIAL DAMAGES OF ANY NATURE, INCLUDING WITHOUT LIMITATION, LOST PROFITS, REVENUES, OR PRODUCTIVITY, OR FOR BODILY INJURY OR DEATH OR LOSS OR DAMAGE TO PROPERTY, UNDER ANY THEORY OF LIABILITY, INCLUDING WITHOUT LIMITATION, CONTRACT, WARRANTY, STRICT LIABILITY, TORT (INCLUDING NEGLIGENCE) OR OTHER LEGAL OR EQUITABLE THEORY.



The Ultimate in Fall Protection

CSG USA & Latin America

3833 SALA Way
Red Wing, MN 55066-5005
Toll Free: 800.328.6146
Phone: 651.388.8282
Fax: 651.388.5065
solutions@capitalsafety.com

CSG Canada

260 Export Boulevard
Mississauga, ON L5S 1Y9
Phone: 905.795.9333
Toll-Free: 800.387.7484
Fax: 888.387.7484
info.ca@capitalsafety.com

CSG Northern Europe

5a Merse Road
North Moons, Moat
Reditch, Worcestershire, UK
B98 9HL
Phone: + 44 (0)1527 548 000
Fax: + 44 (0)1527 591 000
csgne@capitalsafety.com

CSG EMEA (Europe, Middle East, Africa)

Le Broc Center
Z.I. 1ère Avenue
5600 M B.P. 15 06511
Carros
Le Broc Cedex
France
Phone: + 33 4 97 10 00 10
Fax: + 33 4 93 08 79 70
information@capitalsafety.com

CSG Australia & New Zealand

95 Derby Street
Silverwater
Sydney NSW 2128
AUSTRALIA
Phone: +(61) 2 8753 7600
Toll-Free : 1 800 245 002 (AUS)
Toll-Free : 0800 212 505 (NZ)
Fax: +(61) 2 87853 7603
sales@capitalsafety.com.au

CSG Asia

Singapore:
16S, Enterprise Road
Singapore 627666
Phone: +65 - 65587758
Fax: +65 - 65587058
inquiry@capitalsafety.com

Shanghai:

Rm 1406, China Venturetech Plaza
819 Nan Jing Xi Rd,
Shanghai 200041, P R China
Phone: +86 21 62539050
Fax: +86 21 62539060

www.capitalsafety.com



Certificate No. FM 39709