

 **Speedglas™**



Adflo PAPR



9100



9100-Air



9100 FX



9100 FX-Air



9100 MP



Fresh-air III SAR



SL



100 Series



3M Welding Helmet 10



3M Headgear L-Series SG



3M Faceshield ClearVisor

PRODUCT OVERVIEW

# 3M Welding PPE Presentation



Product overview

Welding Helmet Options

Options	3M™ Speedglas™ Welding Helmet 9100 Series and 3M™ Headgear L-Series SG					3M™ Speedglas™ Welding Helmet SL	3M™ Speedglas™ Welding Helmet 100 series			3M™ Welding Helmet 10
Welding Filters	 9100XXi	 9100XX	 9100X	 9100V	 9100 Passive	 SL	 100V	 100S-10	 100S-11	 10V
Welding Helmets										

Options	With Hard Hat (Non-Air)			With 3M™ Adflo™ Powered Air Purifying Respirator			With 3M™ Speedglas™ Fresh Air III Supplied Air Regulator		
Welding Helmet Systems									

## 3M™ Speedglas™ Welding Helmet 9100-Air

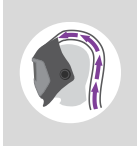

3M™ Speedglas™ Welding Filter Series 9100 with superior optical performance for continuous viewing comfort.

Meets the requirements of CSA Z94.3 and the high impact requirements of ANSI Z87.1 – 2010.

The face seal readily follows the contours of both the helmet and your face.



An airduct that is an integral part of the helmet, providing a refreshing airflow across your entire breathing zone.

Side windows: Shade 5 filters that increase your field of view.

Ergonomically designed head suspension.

## 3M™ Speedglas™ Welding Helmet 9100

Welding filter options	9100XXi Filter	9100XX Filter	9100X Filter	9100V Filter
Viewing area welding filter (approx.)	2.8 x 4.2 in. (72 x 107 mm)	2.8 x 4.2 in. (72 x 107 mm)	2.1 x 4.2 in. (54 x 107 mm)	1.8 x 3.7 in. (45 x 93 mm)
Battery lifetime (approx.)	1800 hours	2000 hours	2500 hours	2800 hours
Solar cell	NO	NO	YES	YES
Hard hat options	YES (Non air version)	YES (Non air version)		
Classification (per EN 379)*	1 / 1 / 1 / 2	1 / 1 / 1 / 2		
Dark state	Shade 5, 8, 9-13	Shade 5, 8, 9-13		
Light state	Shade 3	Shade 3		
UV/IR Protection	Shade 13 (permanent)	Shade 13 (permanent)		
Auto ON	Yes	NO		
Switching time, light–dark (approx.)	0.1 ms (+23°C)	0.1 ms (+23°C)		
Delay, switching time dark-light (approx.)	40–1 300 ms	40–1 300 ms		
Side windows option	YES	YES		
Exhaust vents	YES (Non-air version)	YES (Non-air version)		
Number of sensors (arc detection)	3	3		
<b>Approvals Head, Eye and Face protection</b> Welding helmet, welding filter, protection plates	ANSI Z87.1–2010 / CSA Z94.3	ANSI Z87.1–2010 / CSA Z94.3		

\* Per European Standard EN 379, auto-darkening welding filters have a four-part classification: optical class / diffusion of light / variation on luminous transmittance / angle dependence. Classifications range from 1 to 3, with 1 being the best.

## 3M™ Speedglas™ Welding Helmet 9100-Air

### Airflow pattern

The middle channel keeps the filter virtually fog-free, while two side channels help provide uniformly distributed air to the breathing zone.





## 3M™ Speedglas™ Auto-Darkening Filter Series 9100

### Excellent Optics, Wider Views

Magnification made easy. The magnifying lens holder is built into the welding filter, making lens installation easier and more secure.

The Speedglas welding filter series 9100 include three auto-darkening filters: regular, large and extra-large viewing area.



The tack welding comfort mode uses an intermediate shade 5 light state to help minimize eye strain during extended tack welding applications.

You can adjust the sensitivity of the arc detection for switching reliability.



New 9100XXi

The Delay function allows you to set the dark-to-light switching time.

Seven user selectable dark shades for most types of arc welding.

FEATURES

TECHNICAL FACTS

FUNCTIONS

CARE & MAINTENANCE

ACCESSORIES

PARTS LIST

## 3M™ Speedglas™ Welding Helmet 9100-Air



**06-0500-52**  
Extended coverage, ear and neck



**06-0700-83**  
Full hood



**06-0500-53**  
Side window cover plates



**06-0500-56 – 06-0500-59**  
Magnification plates 1.5X, 2.0X, 2.5X and 3.0X



**H505B**  
3M™ Peltor™ Welding Earmuff



**35-5401-01**  
3M™ Adflo™ Turbo Assembly



**35-3499-01**  
3M™ Adflo™ Turbo Assembly with High Altitude Compensation



**V-100** Vortex cooling assembly  
**V-200** Vortemp heating assembly  
**V-300** Air-regulating valve  
**V-400** Low pressure connector assembly

## 3M™ Speedglas™ Welding Helmet 9100-Air

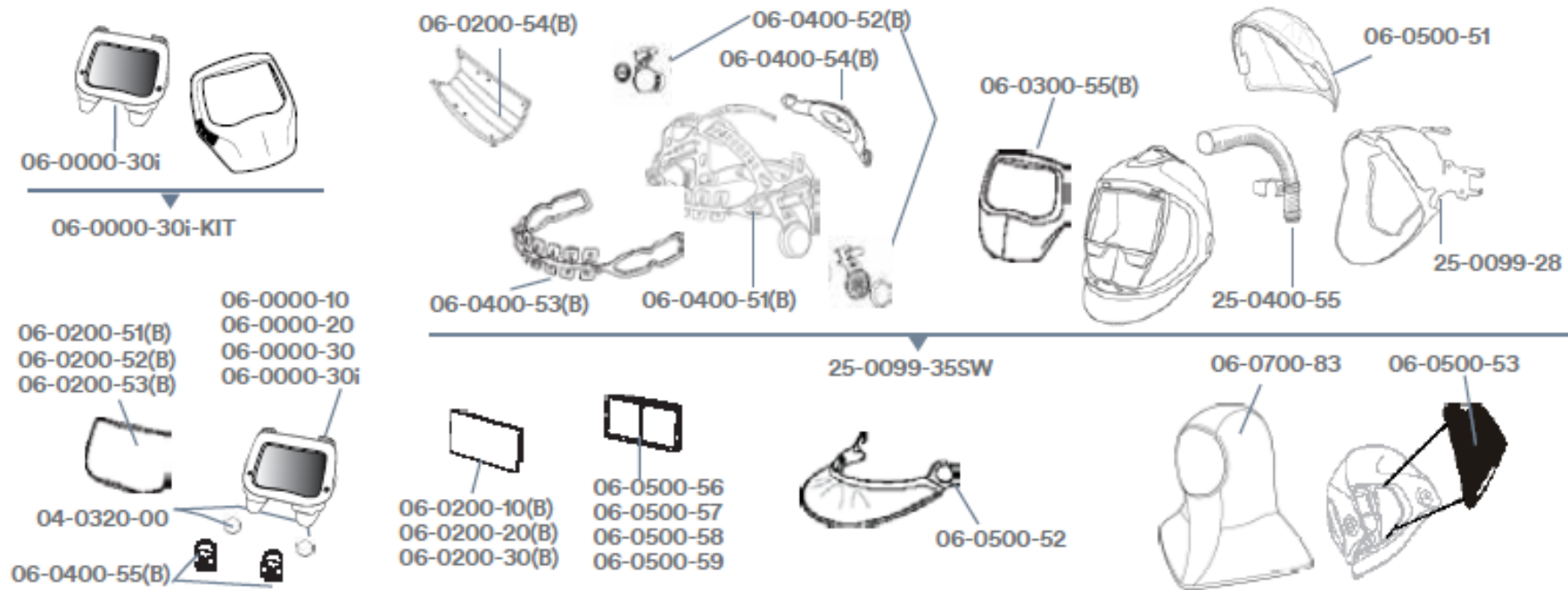



## 3M™ Speedglas™ Welding Helmet 9100-Air



Part No	Description
35-1101-10SW	Speedglas welding helmet 9100-Air with Adflo PAPR with HE filter, lithium ion battery, and welding filter 9100V
35-1101-20SW	Speedglas welding helmet 9100-Air with Adflo PAPR with HE filter, lithium ion battery, and welding filter 9100X
35-1101-30iSW	Speedglas welding helmet 9100-Air with Adflo PAPR with HE filter, lithium ion battery, and welding filter 9100XXi
35-3301-10SW	Speedglas welding helmet 9100-Air with Adflo PAPR with HE filter and OV/SD/CL/HC cartridge, lithium ion battery, and welding filter 9100V
35-3301-20SW	Speedglas welding helmet 9100-Air with Adflo PAPR with HE filter and OV/SD/CL/HC cartridge, lithium ion battery, and welding filter 9100X
35-3301-30SW	Speedglas welding helmet 9100-Air with Adflo PAPR with HE filter and OV/SD/CL/HC cartridge, lithium ion battery, and welding filter 9100XX



Part No	Description
25-5702-10SW	Speedglas welding helmet 9100-Air with welding filter 9100V and Fresh-air III SAR, V-100 cooling valve
25-5702-20SW	Speedglas welding helmet 9100-Air with welding filter 9100X and Fresh-air III SAR, V-100 cooling valve
25-5702-30SW	Speedglas welding helmet 9100-Air with welding filter 9100XX and Fresh-air III SAR, V-100 cooling valve
25-5802-10SW	Speedglas welding helmet 9100-Air with welding filter 9100V and Fresh-air III SAR, V-200 heating valve
25-5802-20SW	Speedglas welding helmet 9100-Air with welding filter 9100X and Fresh-air III SAR, V-200 heating valve
25-5802-30SW	Speedglas welding helmet 9100-Air with welding filter 9100XX and Fresh-air III SAR, V-200 heating valve



### Personal Safety Division

3M Center, Building 235-2W-70  
St. Paul, MN 55144-1000  
USA

Phone 1-800-328-1667

Web [www.3M.com/workersafety](http://www.3M.com/workersafety)

3M PSD products are occupational use only.

3M Personal Safety  
Service & Technical Support Center

1-800-243-4630 or visit [www.3M.com/workersafety](http://www.3M.com/workersafety)

**For a complete listing of parts, visit us at:**  
**[www.3M.com/weldingsafety](http://www.3M.com/weldingsafety)**

**Note:** Welding can create a variety of harmful fumes and gases. When engineering controls are impractical, respirators may be required to help reduce exposures to these airborne welding contaminants.

3M, Speedglas and Adflo are trademarks of 3M.  
Used under license in Canada.

Please recycle. Printed in U.S.A. © 3M 2016.



### **⚠ WARNING**

These respirators help protect against certain airborne contaminants. Before use, the wearer must read and understand the User Instructions provided as a part of the product packaging. A written respiratory protection program must be implemented meeting all the requirements of OSHA 1910.134 including training, fit testing and medical evaluation. In Canada, CSA standards Z94.4 requirements must be met and/or requirements of the applicable jurisdiction, as appropriate. Misuse may result in sickness or death. For proper use, see packaging instructions, supervisor, or call 3M OH&ESD Technical Service in USA at 1-800-243-4630 and in Canada at 1-800-267-4414.

### **⚠ WARNING**

This product is designed to help protect the wearer's eyes and face from harmful radiation including visible light, ultra-violet radiation (UV), infra-red radiation (IR), sparks and spatter resulting from welding processes. These products must be used only by qualified persons who are properly trained in their use and maintenance. Misuse may result in permanent eye injury and vision loss. Always wear ANSI Z87.1 compliant safety spectacles in addition to any welding helmet. For proper use, see supervisor, or User Instructions or call 3M in U.S.A. 1-800-243-4630. In Canada, call Technical Service at 1-800-267-4414.