

3M™ TEXTTOOL™ RECEPTACLES FOR DIP SOCKETS

| RECEPTACLE PART NUMBER | DIM. "A" | DIM. "B" | DIM. "C" | DIM. "D" | DIM. "E" | DIM. "F" | DIM. "G" | DIM. "H" |
|---------------------------|---------------|---------------|----------------|-----------------|----------------|-----------------|---------------|--------------|
| 214-3339-XX | 1.00 [25.4] | .60 [15.2] | 1.28 [32.5] | .820 [20.83] | .300 [7.62] | .600 [15.26] | .100 [2.54] | .40 [10.2] |
| 216-3340-XX | .96 [24.4] | .56 [14.2] | 1.37 [34.8] | .773 [19.63] | .300 [7.62] | .700 [17.78] | | |
| 218-3341-XX | .95 [24.1] | .55 [14.0] | 1.49 [37.8] | .770 [19.56] | | .804 [20.42] | | |
| 220-3342-XX | 1.00 [25.4] | .60 [15.2] | 1.58 [40.1] | .820 [20.83] | | .900 [22.86] | | |
| 222-3343-XX | 1.06 [26.9] | .65 [16.5] | 1.69 [42.9] | .870 [22.09] | .400 [10.16] | 1.005 [25.53] | | |
| 224-1275-XX | 1.26 [32.0] | .86 [21.8] | 1.77 [45.0] | 1.080 [27.43] | .600 [15.24] | 1.100 [27.94] | | |
| 224-5248-XX | .96 [24.4] | .56 [14.2] | | .773 [19.63] | .300 [7.62] | | | |
| 228-1277-XX | 1.26 [32.0] | .86 [21.8] | 1.98 [50.3] | 1.085 [27.56] | .600 [15.24] | 1.300 [33.02] | | |
| 228-4817-XX | 1.06 [26.9] | .66 [16.8] | | .887 [22.53] | .400 [10.16] | 1.301 [33.05] | | |
| 228-1290-XX | 1.09 [27.9] | .70 [17.8] | | .92 [23.4] | | .970 [24.74] | | |
| 232-1285-XX | 1.25 [32.0] | .86 [21.9] | 2.17 [55.2] | 1.08 [27.5] | .600 [15.24] | 1.500 [38.10] | .100 [2.54] | .40 [10.2] |
| 240-3639-XX | 1.66 [42.2] | 1.26 [32.0] | 2.58 [65.5] | 1.480 [37.59] | 1.000 [25.4] | 1.900 [48.26] | | |
| 240-1280-XX | 1.27 [32.3] | .86 [21.8] | | 1.085 [27.56] | .600 [15.24] | 1.900 [48.26] | | |
| 242-1293-XX | 1.30 [33.0] | .90 [22.9] | 2.08 [52.9] | 1.12 [28.5] | .600 [15.24] | 1.460 [37.08] | .070 [1.78] | .41 [10.4] |
| 242-1281-XX | 1.26 [32.0] | .86 [21.8] | 2.68 [68.1] | 1.080 [27.43] | .600 [15.24] | 2.00 [50.80] | .100 [2.54] | .40 [10.2] |
| 248-1282-XX | 1.25 [31.8] | | 2.98 [75.8] | 1.070 [27.18] | .600 [15.24] | 2.500 [63.50] | | .50 [12.7] |
| 264-1300-XX | 1.52 [38.5] | 1.11 [28.3] | 2.85 [72.5] | 1.34 [34.0] | .800 [20.32] | 2.230 [56.64] | .070 [1.78] | .41 [10.4] |
| 264-4493-XX | 1.70 [43.2] | 1.30 [33.0] | 3.95 [100.3] | 1.520 [38.61] | .900 [22.86] | 3.243 [82.37] | .100 [2.54] | .50 [12.7] |
| 290-1294-XX | 1.61 [40.8] | 1.19 [30.2] | 3.77 [95.7] | 1.42 [36.0] | | 3.150 [80.01] | .070 [1.78] | .41 [10.4] |

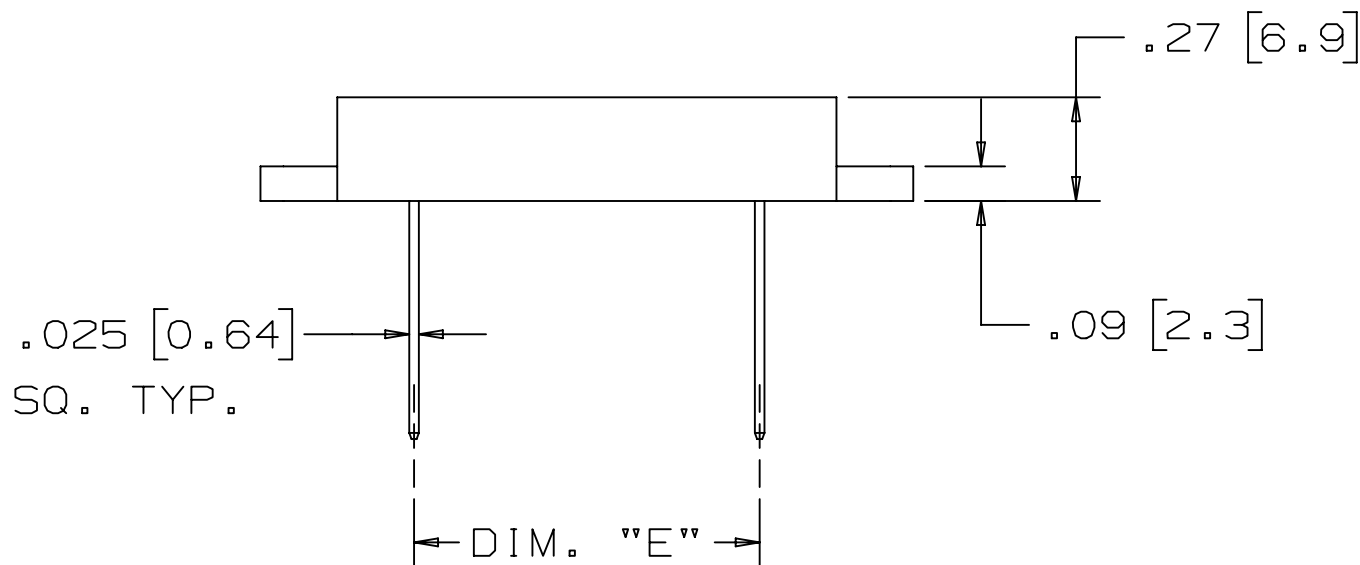
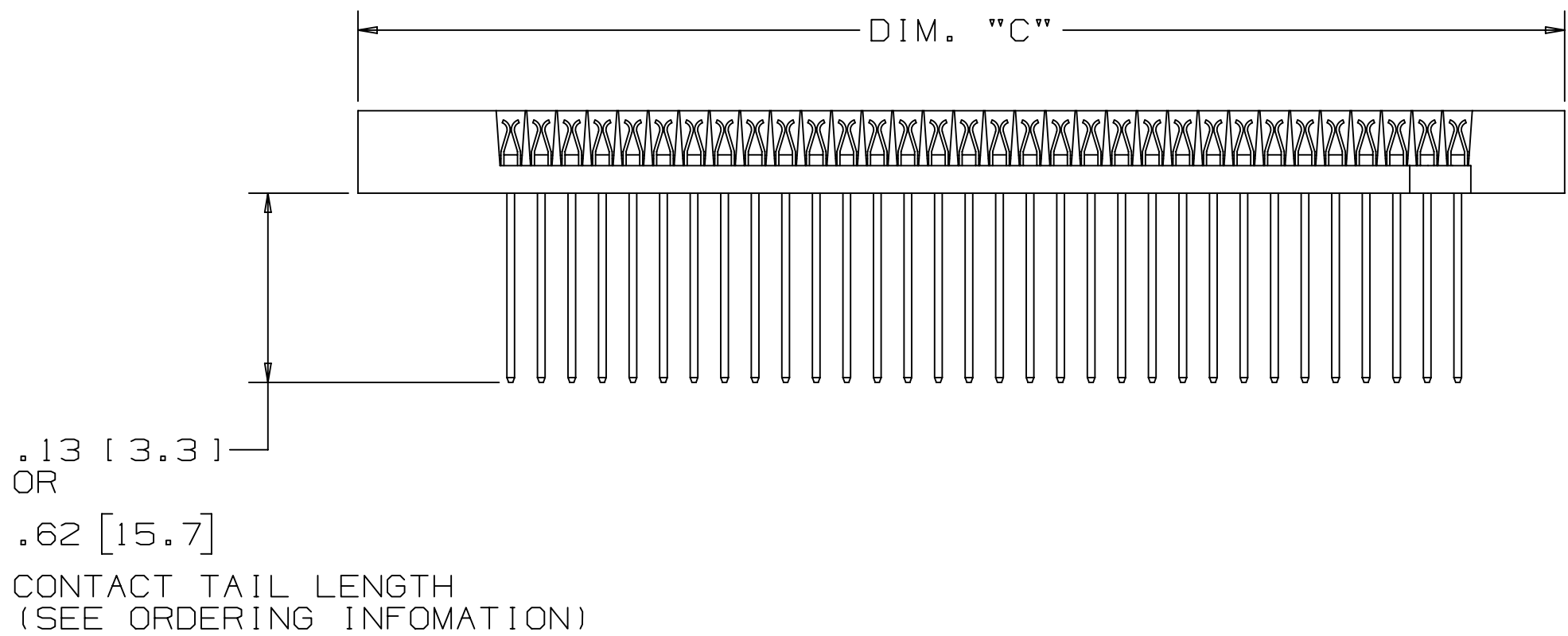
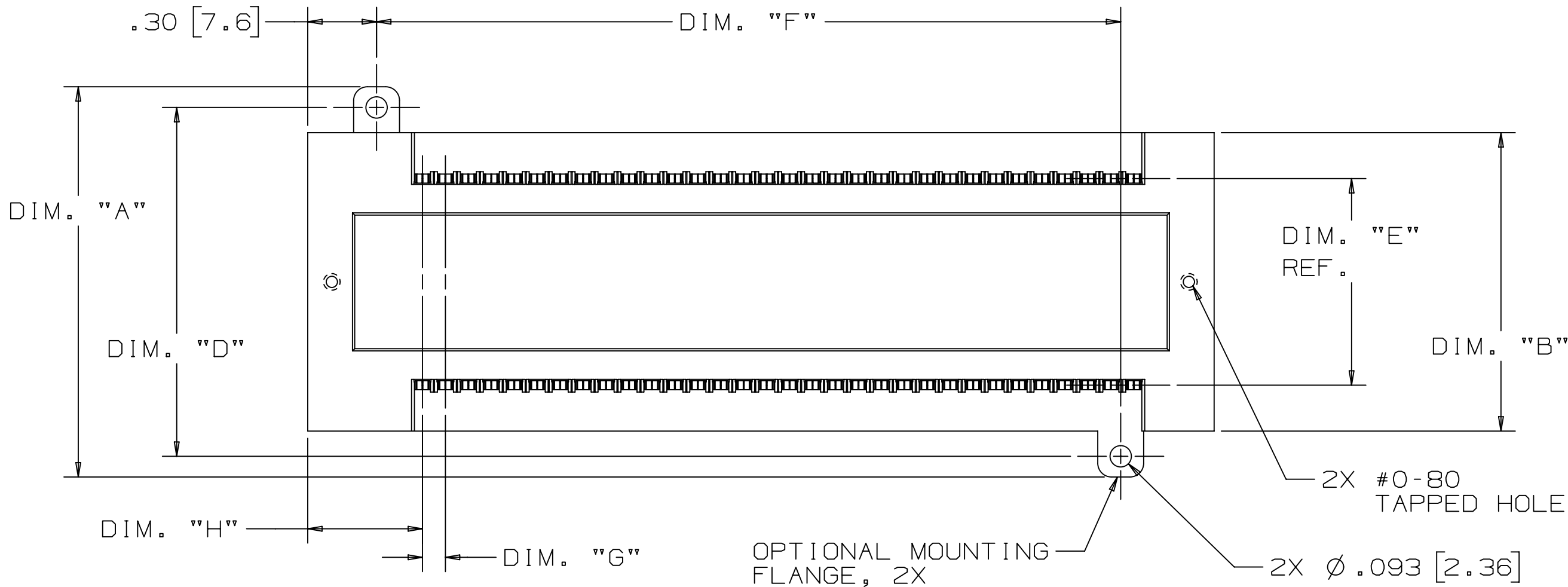

3M ELECTRONICS MATERIALS SOLUTIONS DIVISION
INTERCONNECT SOLUTIONS
<http://www.3M.com/interconnect>

3M IS A TRADEMARK OF 3M COMPANY.
FOR TECHNICAL, SALES OR ORDERING
INFORMATION CALL 800-225-5373

| | | | |
|---------------------------------|-------------|----------------------------|-------------|
| DESIGN REFERENCE | | NEXT ASSEMBLY | |
| APPROVED | DATE | APPROVED | DATE |
| CHD | CASTIGLIONE | CHD | CASTIGLIONE |
| DIVISION | | DIVISION CODE | |
| DO NOT SCALE DRAWING | | EMSD | |
| THIRD ANGLE PROJECTION | | TOLERANCES EXCEPT AS NOTED | |
| INTERPRET PER ASME Y14.5 - 2018 | | INCHES .0000 ± .0005 | |
| MAX. SURFACE ROUGHNESS | | MILLIMETERS 0 ± 2 | |
| ALL SURFACES MARKED ONLY | | CAGE NUMBER | |
| | | D 78-5100-0454-8 | |
| | | MODEL | |
| | | LISTS | |
| | | YES | |
| | | NO | |
| | | SHT 2 OF 3 | |

| | | | | |
|-----|--------|--|------|------|
| REV | ECO | ISSUE DATE AND DESCRIPTION | DRFT | CHKD |
| 1 | 111457 | FEB 12, 2024 REVISED AND REDRAWN | JNC | FJR |
| 2 | 42662 | OCT 08, 2012 REVISE OPERATING TEMP. | LDS | ARM |
| 3 | ---- | JUL 31, 2012 RELEASED TO REV A | LDS | LDS |

© 3M COPYRIGHT 2024
This document and the information it contains are 3M property and may not be reproduced or further distributed without 3M permission, or used or disclosed other than for 3M authorized purposes. All rights reserved.

3M Center
St. Paul,
MN 55144

TITLE
TEXTTOOL RECEPTACLES
FOR DIP SOCKETS

8

7

6

5

4

3

2

1

3M™ TEXT TOOL™ RECEPTACLES FOR DIP SOCKETS

Regulatory: For regulatory information about this product, visit 3M.com/regs or contact your 3M representative.

Technical Information: The technical information, guidance, and other statements contained in this document or otherwise provided by 3M are based upon records, tests, or experience that 3M believes to be reliable, but the accuracy, completeness, and representative nature of such information is not guaranteed. Such information is intended for people with knowledge and technical skills sufficient to assess and apply their own informed judgment to the information. No license under any 3M or third party intellectual property rights is granted or implied with this information.

Product Use: Many factors beyond 3M's control and uniquely within user's knowledge and control can affect the use and performance of a 3M product in a particular application. As a result, customer is solely responsible for evaluating the product and determining whether it is appropriate and suitable for customer's application, including conducting a workplace hazard assessment and reviewing all applicable regulations and standards (e.g., OSHA, ANSI, etc.). Failure to properly evaluate, select, and use a 3M product in accordance with all applicable instructions and with appropriate safety equipment, or to meet all applicable safety regulations, may result in injury, sickness, death, and/or harm to property.

Warranty, Limited Remedy, and Disclaimer: Unless a different warranty is specifically stated on the applicable 3M product packaging or product literature (in which case such warranty governs), 3M warrants that each 3M product meets the applicable 3M product specification at the time 3M ships the product. 3M MAKES NO OTHER WARRANTIES OR CONDITIONS, EXPRESS OR IMPLIED, INCLUDING, BUT NOT LIMITED TO, ANY IMPLIED WARRANTY OR CONDITION OF MERCHANTABILITY, FITNESS FOR A PARTICULAR PURPOSE, OR ANY IMPLIED WARRANTY OR CONDITION ARISING OUT OF A COURSE OF DEALING, CUSTOM, OR USAGE OF TRADE. If a 3M product does not conform to this warranty, then the sole and exclusive remedy is, at 3M's option, replacement or repair of the 3M product or refund of the purchase price.

Limitation of Liability: Except for the limited remedy stated above, and except to the extent prohibited by applicable law, 3M will not be liable for any loss or damage arising from or related to the 3M product, whether direct, indirect, special, incidental, or consequential (including, but not limited to, lost profits or business opportunity), regardless of the legal or equitable theory asserted, including, but not limited to, warranty, contract, negligence, or strict liability.

Disclaimer: For industrial use only. Not intended, labeled or packaged for consumer sale or use.

3M Company
Electronics Materials Solutions Division
13011 McCallen Pass, Bldg. C
Austin, TX 78753-5380
1-800-225-5373
www.3M.com/interconnect

8

7

6

5

4

3

2

1

3M ELECTRONICS MATERIALS SOLUTIONS DIVISION
INTERCONNECT SOLUTIONS
http://www.3M.com/interconnect

3M IS A TRADEMARK OF 3M COMPANY.
FOR TECHNICAL, SALES OR ORDERING
INFORMATION CALL 800-225-5373

DESIGN REFERENCE
NEXT ASSEMBLY

DO NOT SCALE DRAWING

THIRD ANGLE PROJECTION

MAX. SURFACE ROUGHNESS
ALL SURFACES
MARKED ONLY

SCALE
2
1

TOLERANCES EXCEPT AS NOTED

INCHES
±.1
±.01
±.005
±.0002

MILLIMETERS
±2
±.25
±0.13
±.005

REV. ECO

ISSUE DATE AND DESCRIPTION

DRFT

CHKD

3M Center
St. Paul,
MN 55144

© 3M COPYRIGHT 2024
This document and the information it contains are 3M property and may not be reproduced or further distributed without 3M permission, or used or disclosed other than for 3M authorized purposes. All rights reserved.

TITLE
TEXT TOOL RECEPTACLES FOR DIP SOCKETS

CAGE NUMBER
D78-5100-0454-8

SIZE

DRAWING NO.

REV. C

MODEL

DET
LISTS

YES

NO

SHT 3 OF 3