

PART NUMBER	TYPE	MINI D RIBBON (MDR) CONN'S	D SUB CONN'S	D RIBBON CONN'S	SHRUNK D RIBBON (SDR) CONN'S	LATCH / EJECT HEADERS, 3000 SERIES	SHEET No.
3341-1L ²	JACK SOCKET SCREW		X	X			2
3341-1S ²	JACK SOCKET SCREW		X	X			
3341-2	JACK SOCKET SCREW			X			
3341-3	JACK SOCKET SCREW			X			
3341-4 ²	JACK SOCKET SCREW		X	X			
3341-5	PAN HD THREAD CUTTING SCR					X	3
3341-10	JACK SOCKET SCREW	X					
3341-13	JACK SOCKET SCREW	X					
3341-16	JACK SOCKET SCREW	X					
3341-17	JACK SOCKET SCREW	X					
3341-25	JACK SOCKET SCREW	X					
3341-30	JACK SOCKET SCREW	X					
3341-31	JACK SOCKET SCREW	X					
3341-32	JACK SOCKET SCREW	X					
3341-35	JACK SOCKET SCREW	X					
3341-36	JACK SOCKET SCREW	X					4
3342-1 ²	JACK SCREW KITS		X				
3342-2 ²	JACK SCREW KITS		X				
3342-3 ²	JACK SCREW KITS		X	X			
3342-4 ²	JACK SCREW KITS		X	X			5
3344-3	BOARD LOCK SCREW	X					
3344-4	BOARD LOCK SCREW	X					
3344-26	PANEL MOUNT SCREW	X					
3344-38	PANEL MOUNT SCREW	X					
3344-44	PANEL MOUNT SCREW	X					
3344-45	PANEL MOUNT SCREW	X					
3344-46	BOARD LOCK SCREW				X		6
3475-1	BAIL MOUNT KITS			X			
3475-4	BAIL MOUNT KITS			X			
3475-5	BAIL MOUNT KITS			X			7
12600-S-08	JACK SOCKET SCREW				X		
12600-S-10	JACK SOCKET SCREW				X		
12600-S-12	JACK SOCKET SCREW				X		8
MOUNTING HARDWARE GUIDE			X				
SEE SHEET 6 FOR D-RIBBON AND PLASTIC CONNECTOR ACCESSORIES							

DIMENSIONS: INCHES [MM] [MM] IS FOR REF. ONLY				K 12448915 JUL 25, 2025 JNC FJR	
J 0046915 JUL 07, 2013 DFC ARM				REVISED AND REDRAWN	
REMOVE QTY & PKG				JUL 07, 2013	
DESIGN REFERENCE		NEXT ASSEMBLY		REV ECO	
ACCESS CODES		DIVISION CODE		ISSUE DATE AND DESCRIPTION	
				DATE MFG DATE	
DIVISION		DEPT		DATE	
DO NOT SCALE DRAWING		TOLERANCES EXCEPT AS NOTED		DATE	
		INCHES		DATE	
THIRD ANGLE PROJECTION		MILLIMETERS		DATE	
INTERPRET PER ASME Y14.5 - 2018		0.0 ± 0.00 ± 0.00 ± 0.000 ±		DATE	
MAX SURFACE ROUGHNESS		0 ± 0.0 ± 0.00 ± 0.00 ±		DATE	
TYPICAL SURFACES		0 ± 0.0 ± 0.00 ± 0.00 ±		DATE	
MARKED ONLY		ANGLES ±		DATE	
3M Center St. Paul, MN 55144				© 3M COPYRIGHT 2025 This document and the information it contains are 3M property and may not be reproduced or further distributed without 3M permission, or used or disclosed other than for 3M authorized purposes. All rights reserved.	
TITLE				I/O CONNECTOR MTG OPTIONS & HARDWARE, TS-0142	
CAGE NUMBER		SIZE		DRAWING NO.	
D		5100-0142-9		REV. K	
MODEL		DET.		SHT 1 OF	
1		1		1	

3M™ Display and Electronics Product Platform, (DEPP)
Transportation and Electronics Business Group (TEBG)
<http://www.3M.com/interconnect>

3M IS A TRADEMARK OF 3M COMPANY.
FOR TECHNICAL, SALES OR ORDERING
INFORMATION CALL 800-225-5373

3M™ I/O CONNECTOR MOUNTING OPTIONS AND HARDWARE

JACK SOCKET SCREWS

3M PART NUMBER: 3341-1L

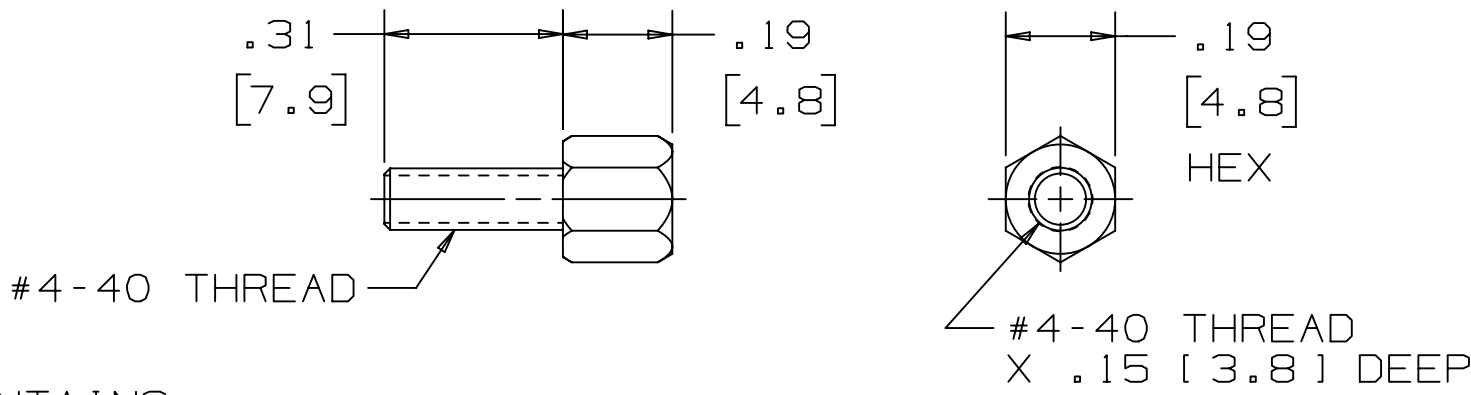

KIT CONTAINS:
2 - JACK SOCKETS
4 - SPACERS .031 [0.79] THICK
2 - LOCK WASHERS
2 - #4-40 NUTS

MATERIAL: STEEL
FINISH: ZINC WITH CLEAR CHROMATE
SCREW / SOCKET THREAD SIZE: #4-40/#4-40
RECOMMENDED MAX. TORQUE: 7.0 INCH-lbs [0.8 N-m]

3M PART NUMBER: 3341-1S

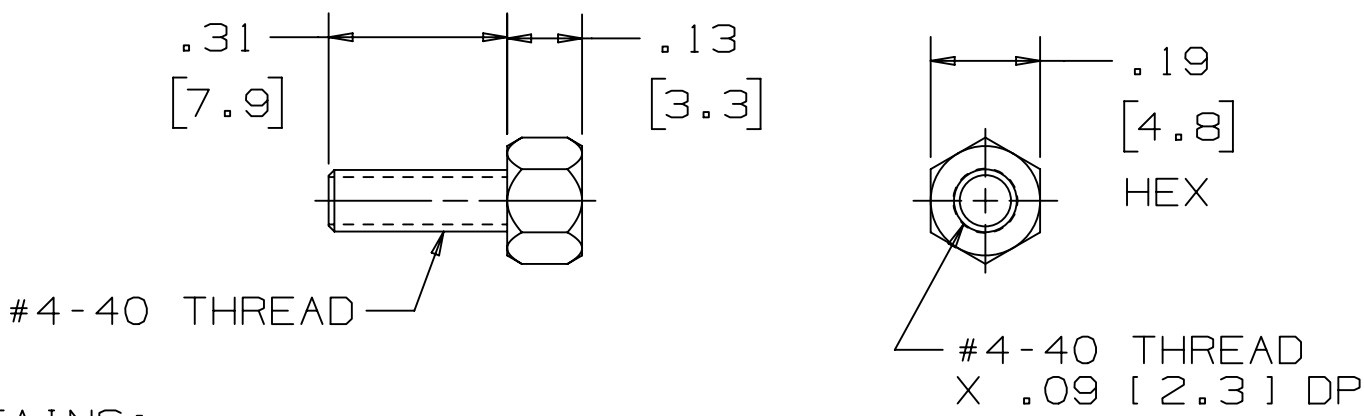

KIT CONTAINS:
2 - JACK SOCKETS
4 - SPACERS .031 [0.79] THICK
2 - LOCK WASHERS
2 - #4-40 NUTS

MATERIAL: STEEL
FINISH: ZINC WITH CLEAR CHROMATE
SCREW / SOCKET THREAD SIZE: #4-40/#4-40
RECOMMENDED MAX. TORQUE: 7.0 INCH-lbs [0.8 N-m]

3M PART NUMBER: 3341-2

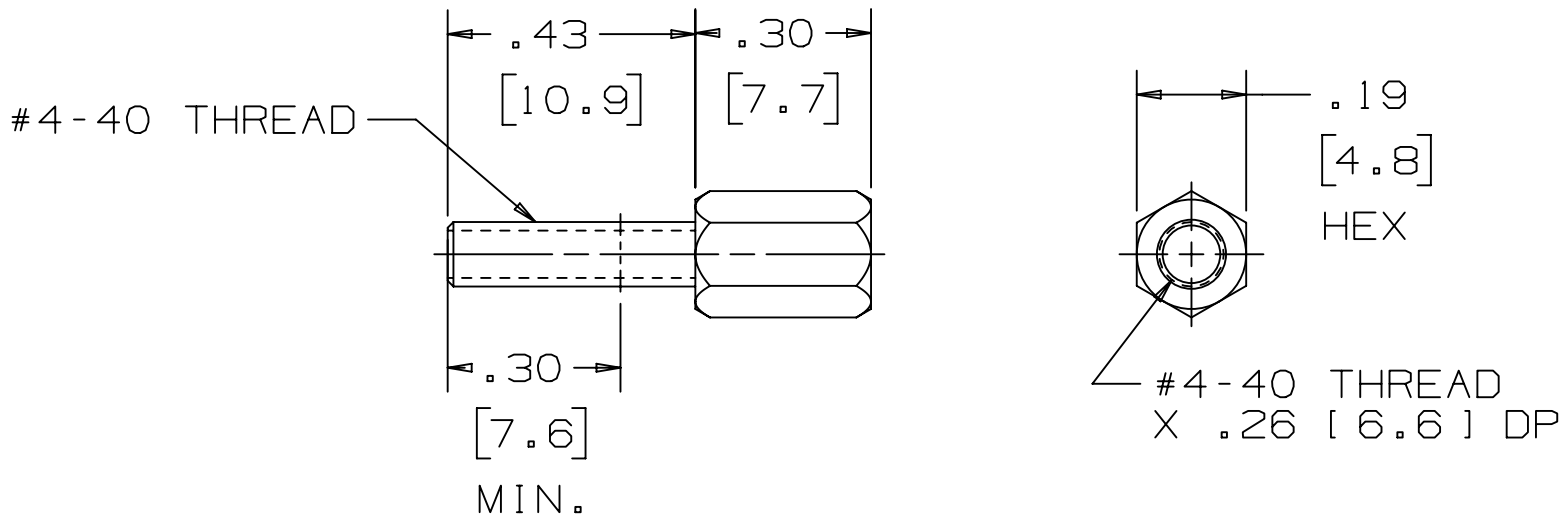

KIT CONTAINS:
2 - JACK SOCKETS
2 - LOCK WASHERS
2 - #4-40 NUTS

MATERIAL: STEEL
FINISH: ZINC WITH CLEAR CHROMATE
SCREW / SOCKET THREAD SIZE: #4-40/#4-40
RECOMMENDED MAX. TORQUE: 7.0 INCH-lbs [0.8 N-m]

3M PART NUMBER: 3341-3
IEEE-488-TYPE

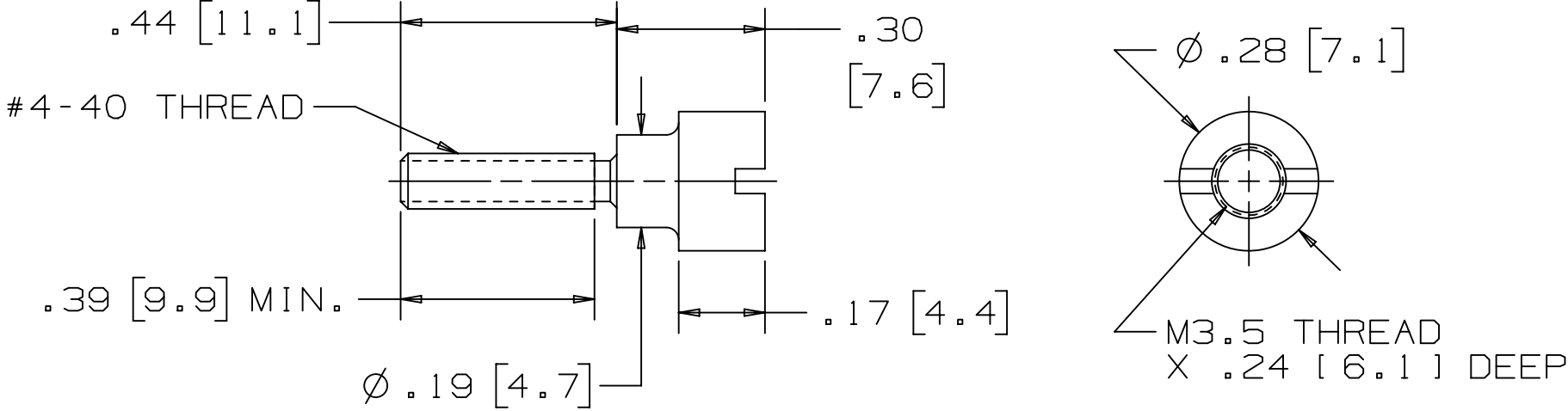

KIT CONTAINS:
2 - JACK SOCKETS
4 - SPACERS .031 [0.79] THICK
2 - LOCK WASHERS
2 - #4-40 NUTS

MATERIAL: STEEL
FINISH: BLACK OXIDE
SCREW / SOCKET THREAD SIZE: #4-40/M3.5
RECOMMENDED MAX. TORQUE: 7.0 INCH-lbs [0.8 N-m]

3M PART NUMBER: 3341-4

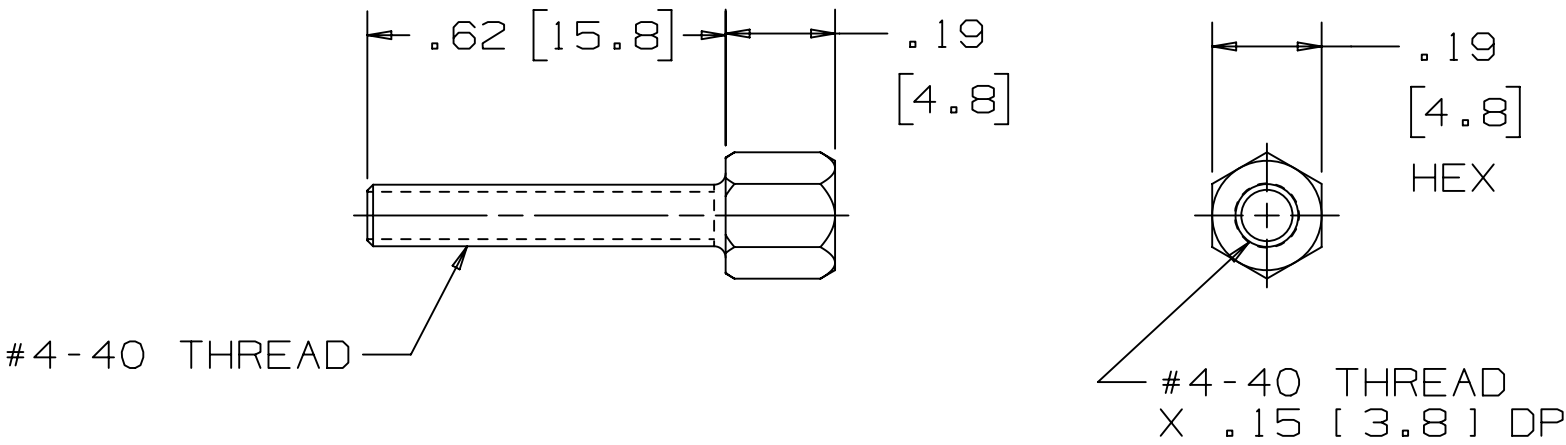

KIT CONTAINS:
2 - JACK SOCKETS
4 - SPACERS .031 [0.79] THICK
2 - LOCK WASHERS
2 - #4-40 NUTS

MATERIAL: STEEL
FINISH: ZINC WITH CLEAR CHROMATE
SCREW / SOCKET THREAD SIZE: #4-40/#4-40
RECOMMENDED MAX. TORQUE: 7.0 INCH-lbs [0.8 N-m]

3M PART NUMBER: 3341-5

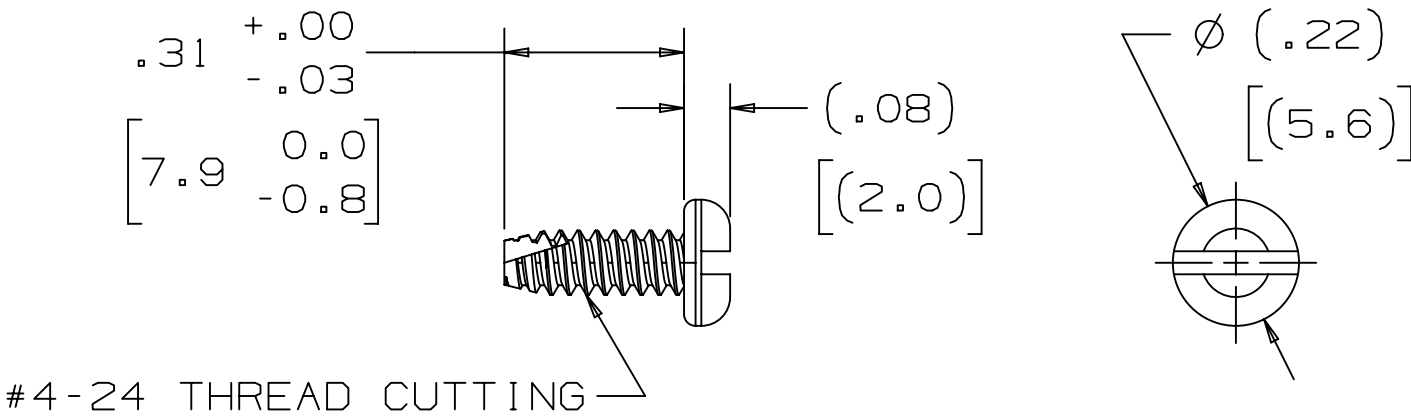

MATERIAL: STAINLESS STEEL
FINISH: ZINC WITH CLEAR CHROMATE
SCREW THREAD SIZE: #4-24
TYPE: USA STD BT, FEDERAL BG

3M™ Display and Electronics Product Platform, (DEPP)
Transportation and Electronics Business Group (TEBG)
<http://www.3M.com/interconnect>

3M IS A TRADEMARK OF 3M COMPANY.
FOR TECHNICAL, SALES OR ORDERING
INFORMATION CALL 800-225-5373

DESIGN REFERENCE		NEXT ASSEMBLY		REV	ECO	ISSUE DATE AND DESCRIPTION		DRFT	CHKD
XREF		XREF		DRFT	CASTIGLIONE	DATE	JUL 25, 2025	MFG	DATE
DIVISION		DIVISION CODE		CHKD	DATE	DATE	APPL	DATE	DATE
DO NOT SCALE DRAWING		SCALE		TOLERANCES EXCEPT AS NOTED		INCHES			
THIRD ANGLE PROJECTION		INTERPRET PER ASME Y14.5 - 2018		MILLIMETERS		0 ±			
MAX. SURFACE ROUGHNESS		ALL SURFACES		MARKED ONLY		0 ±			
3M		3M Center St. Paul, MN 55144		© 3M COPYRIGHT 2025		This document and the information it contains are 3M property and may not be reproduced or further distributed without 3M permission, or used or disclosed other than for 3M authorized purposes. All rights reserved.			
TITLE		I/O CONNECTOR MTG OPTIONS & HARDWARE, TS-0142		CAGE NUMBER		SIZE	DRAWING NO.	REV.	DATE
MODEL		D78-5100-0142-9		LISTS		YES	NO	SHT 2 OF 9	DATE

3M™ I/O CONNECTOR MOUNTING OPTIONS AND HARDWARE

JACK SOCKET SCREWS

3M PART NUMBER: 3341-10

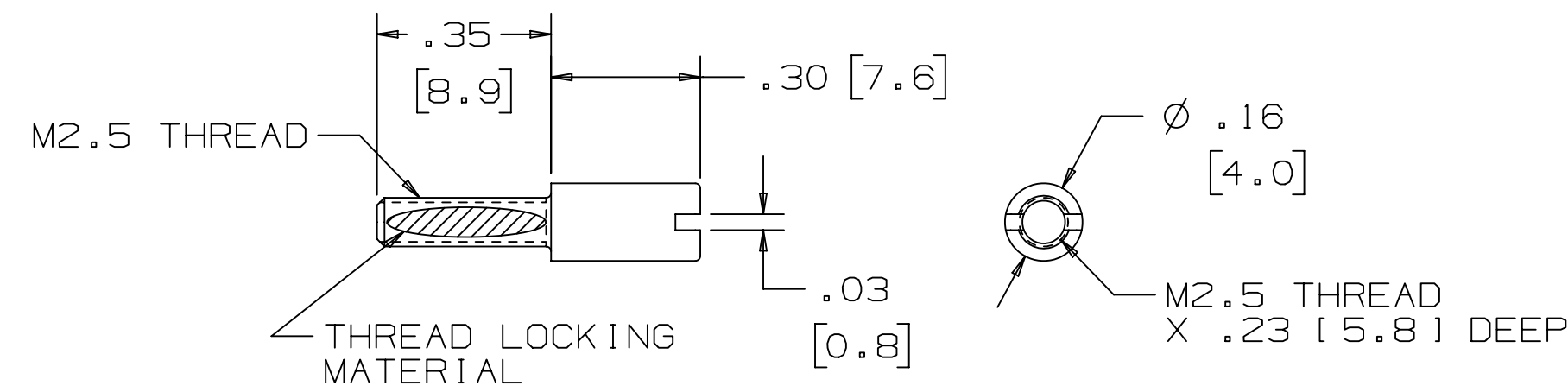

MATERIAL: STAINLESS STEEL
SCREW / SOCKET THREAD SIZE: M2.5/M2.5
RECOMMENDED MAX. TORQUE: 2.5 INCH-lbs [0.3 N-m]

3M PART NUMBER: 3341-13

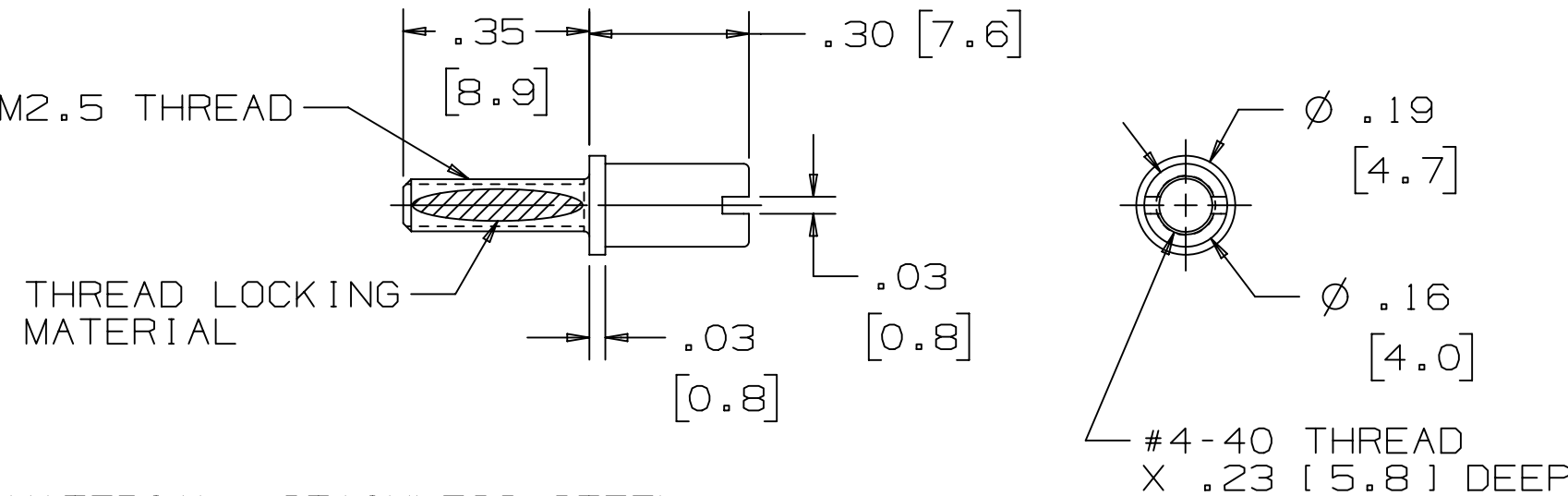

MATERIAL: STAINLESS STEEL
SCREW / SOCKET THREAD SIZE: M2.5/#4-40
RECOMMENDED MAX. TORQUE: 2.5 INCH-lbs [0.3 N-m]

3M PART NUMBER: 3341-16

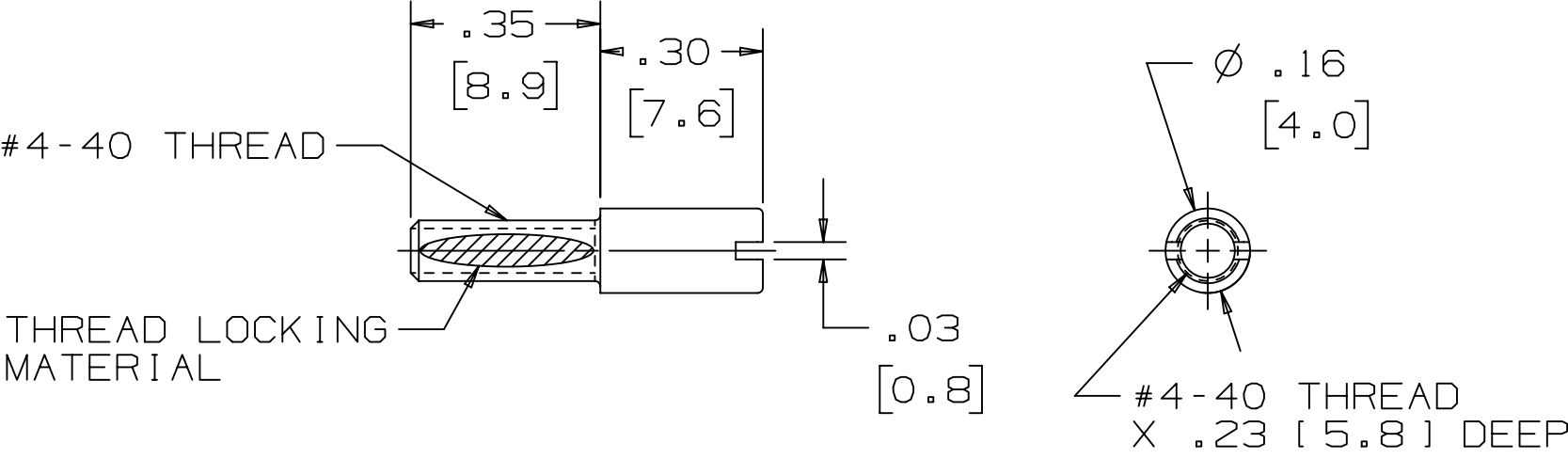

MATERIAL: STAINLESS STEEL
SCREW / SOCKET THREAD SIZE: #4-40/#4-40
RECOMMENDED MAX. TORQUE: 3.5 INCH-lbs [0.4 N-m]

3M PART NUMBER: 3341-17

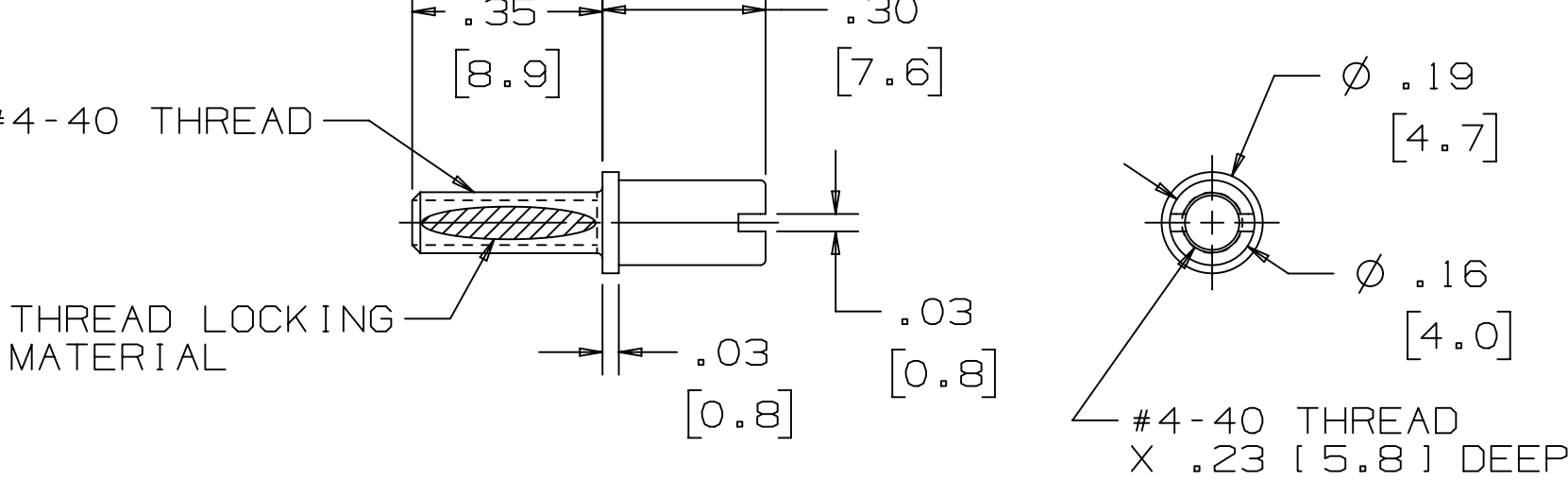

MATERIAL: STAINLESS STEEL
SCREW / SOCKET THREAD SIZE: #4-40/#4-40
RECOMMENDED MAX. TORQUE: 3.5 INCH-lbs [0.4 N-m]

3M PART NUMBER: 3341-25

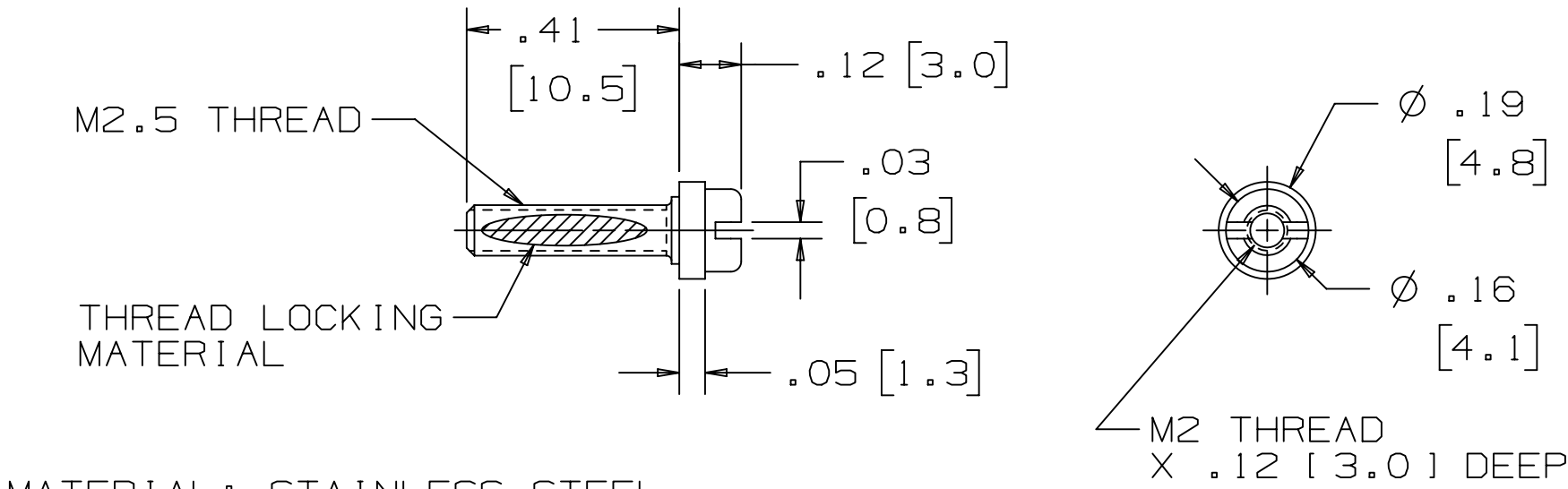

MATERIAL: STAINLESS STEEL
SCREW / SOCKET THREAD SIZE: M2.5/M2
RECOMMENDED MAX. TORQUE: 2.5 INCH-lbs [0.3 N-m]

3M PART NUMBER: 3341-30

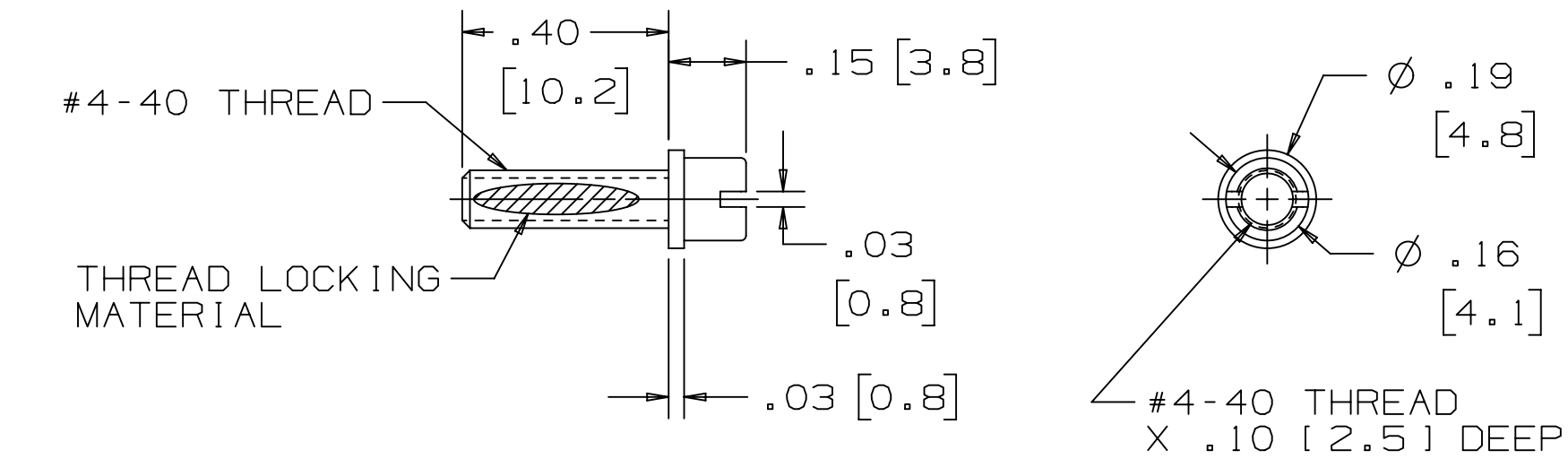

MATERIAL: STAINLESS STEEL
SCREW / SOCKET THREAD SIZE: #4-40/#4-40
RECOMMENDED MAX. TORQUE: 3.5 INCH-lbs [0.4 N-m]

3M PART NUMBER: 3341-31

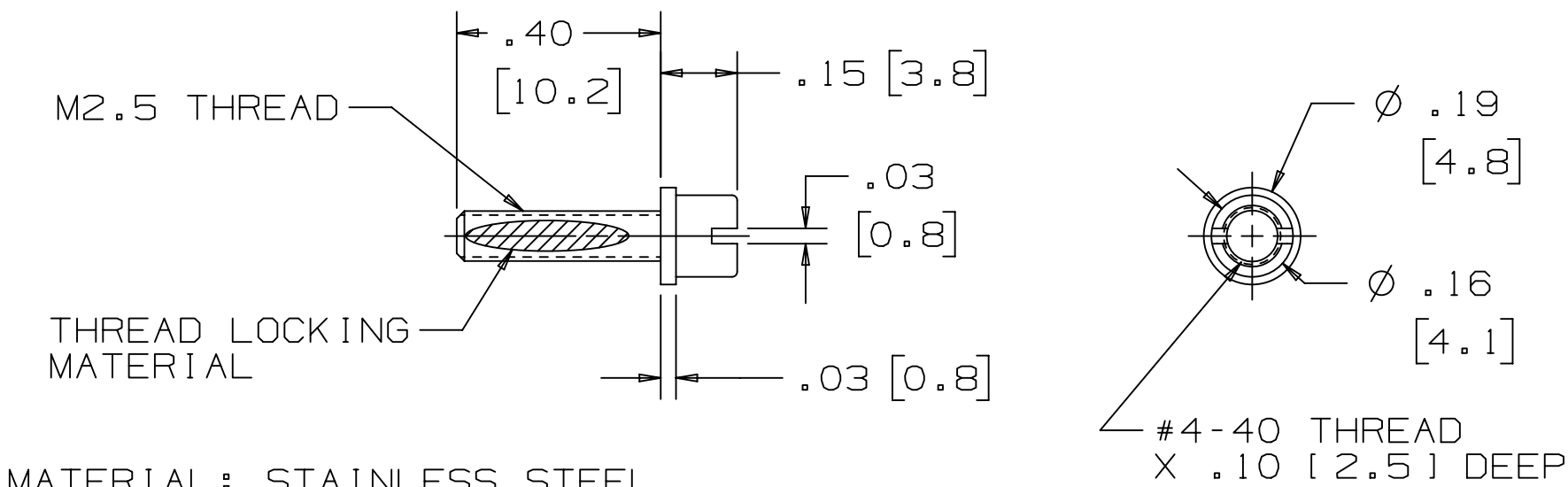

MATERIAL: STAINLESS STEEL
SCREW / SOCKET THREAD SIZE: M2.5/#4-40
RECOMMENDED MAX. TORQUE: 2.5 INCH-lbs [0.3 N-m]

3M PART NUMBER: 3341-32

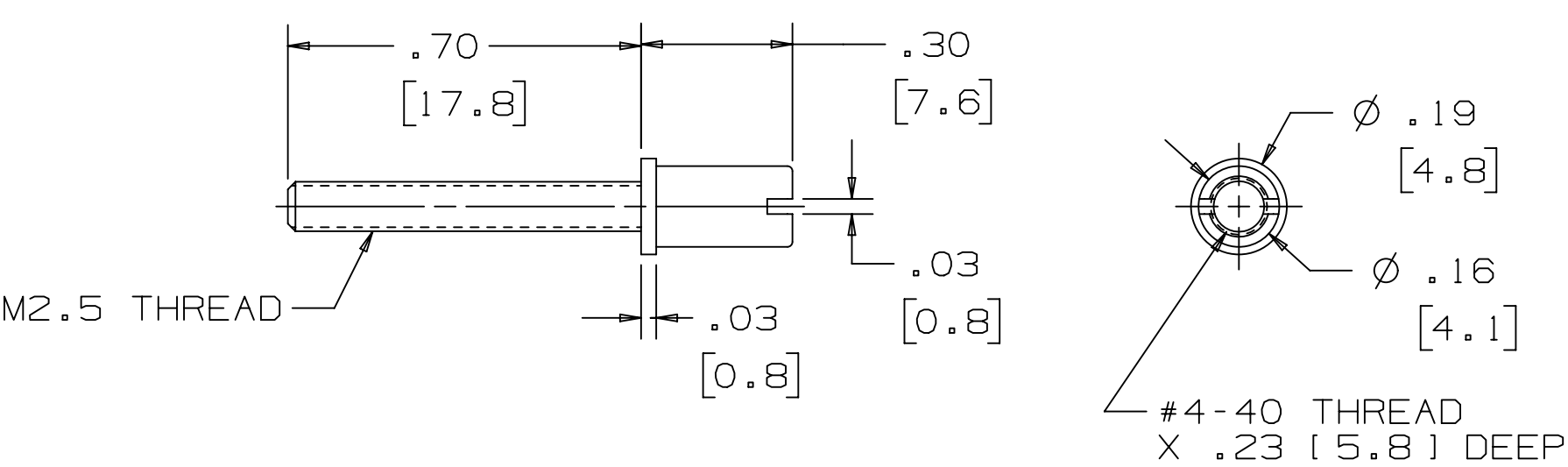

MATERIAL: STAINLESS STEEL
SCREW / SOCKET THREAD SIZE: M2.5/#4-40
RECOMMENDED MAX. TORQUE: 2.5 INCH-lbs [0.3 N-m]

3M PART NUMBER: 3341-35

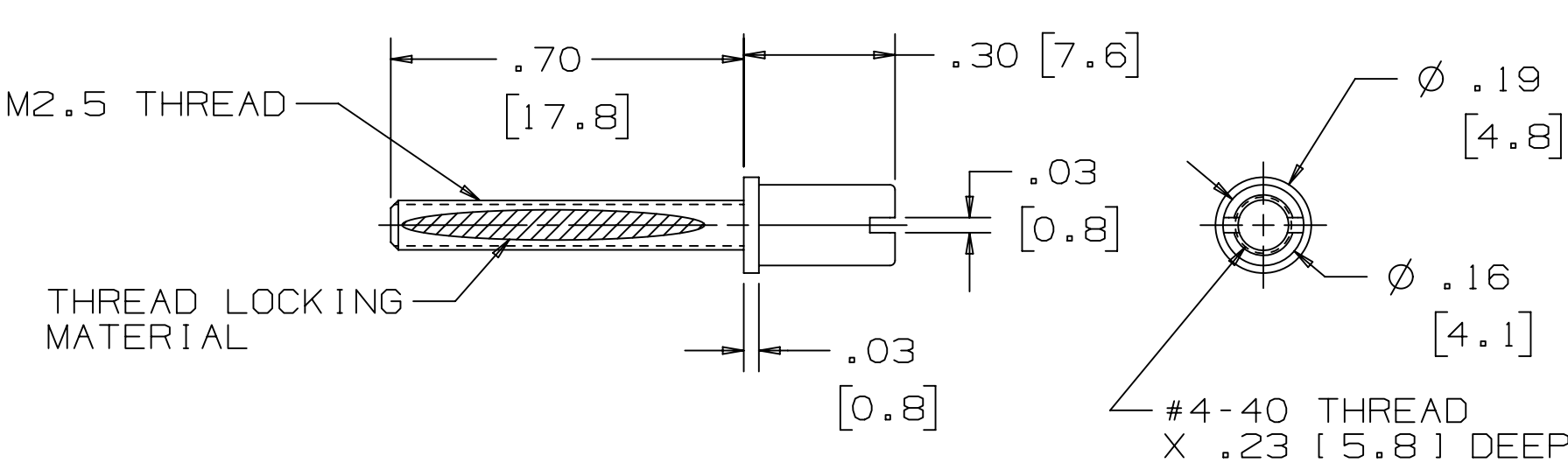

MATERIAL: STAINLESS STEEL
SCREW / SOCKET THREAD SIZE: M2.5/#4-40
RECOMMENDED MAX. TORQUE: 2.5 INCH-lbs [0.3 N-m]

3M PART NUMBER: 3341-36

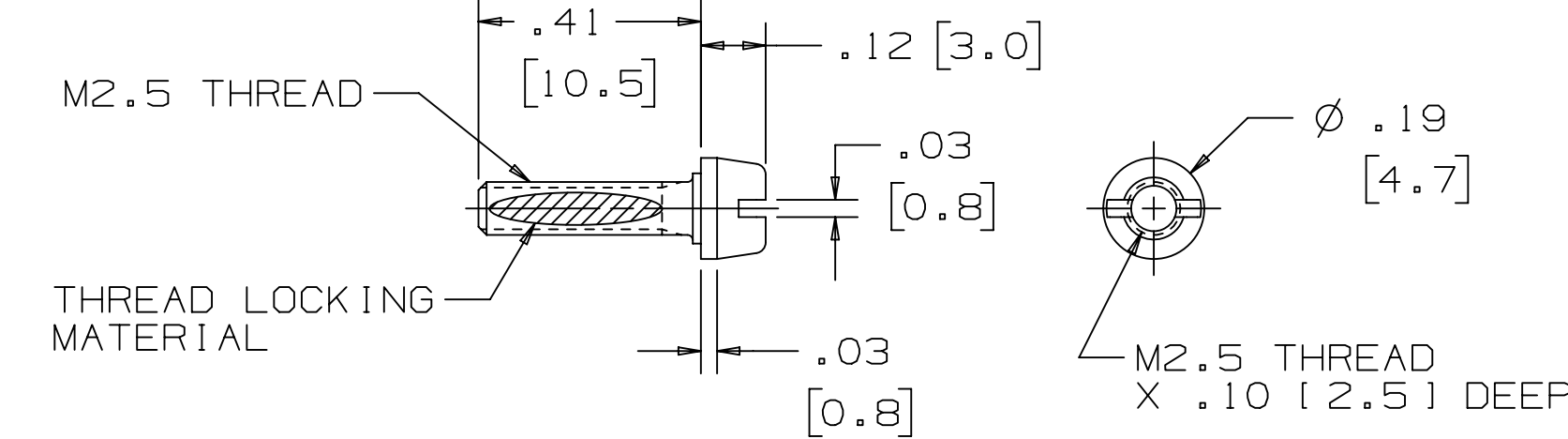

MATERIAL: STAINLESS STEEL
SCREW / SOCKET THREAD SIZE: M2.5/M2.5
RECOMMENDED MAX. TORQUE: 2.5 INCH-lbs [0.3 N-m]

3M™ Display and Electronics Product Platform, (DEPP)
Transportation and Electronics Business Group (TEBG)
<http://www.3M.com/interconnect>

3M IS A TRADEMARK OF 3M COMPANY.
FOR TECHNICAL, SALES OR ORDERING
INFORMATION CALL 800-225-5373

DESIGN REFERENCE		NEXT ASSEMBLY		REV		ISSUE DATE AND DESCRIPTION		DRFT		CHKD	
XREF		XREF		ECO		JUL 25, 2025		JNC		FJR	
DIVISION		DIVISION CODE		J 0046915		JUL 07, 2013		DFC		ARM	
DO NOT SCALE DRAWING		SCALE		TOLERANCES EXCEPT AS NOTED		REMOVE QTY & PKG		DATE		DATE	
THIRD ANGLE PROJECTION		INTERPRET PER ASME Y14.5 - 2018		MILLIMETERS		DATE		APPL		DATE	
MAX SURFACE ROUGHNESS		TOTAL SURFACES		INCHES		DATE		DATE		DATE	
MARKED ONLY		MARKED ONLY		MARKED ONLY		MARKED ONLY		MARKED ONLY		MARKED ONLY	
3M		3M Center St. Paul, MN 55144		© 3M COPYRIGHT 2025		3M property and may not be reproduced or further distributed without 3M permission, or used or disclosed other than for 3M authorized purposes. All rights reserved.		TITLE		I/O CONNECTOR MTG OPTIONS & HARDWARE, TS-0142	
CAGE NUMBER		SIZE		DRAWING NO.		REV.		MODEL		LISTS	
D		78-5100-0142-9		K		YES		NO		SHT 3 OF 9	

3M™ I/O CONNECTOR MOUNTING OPTIONS AND HARDWARE

3M PART NUMBER: 3342-1

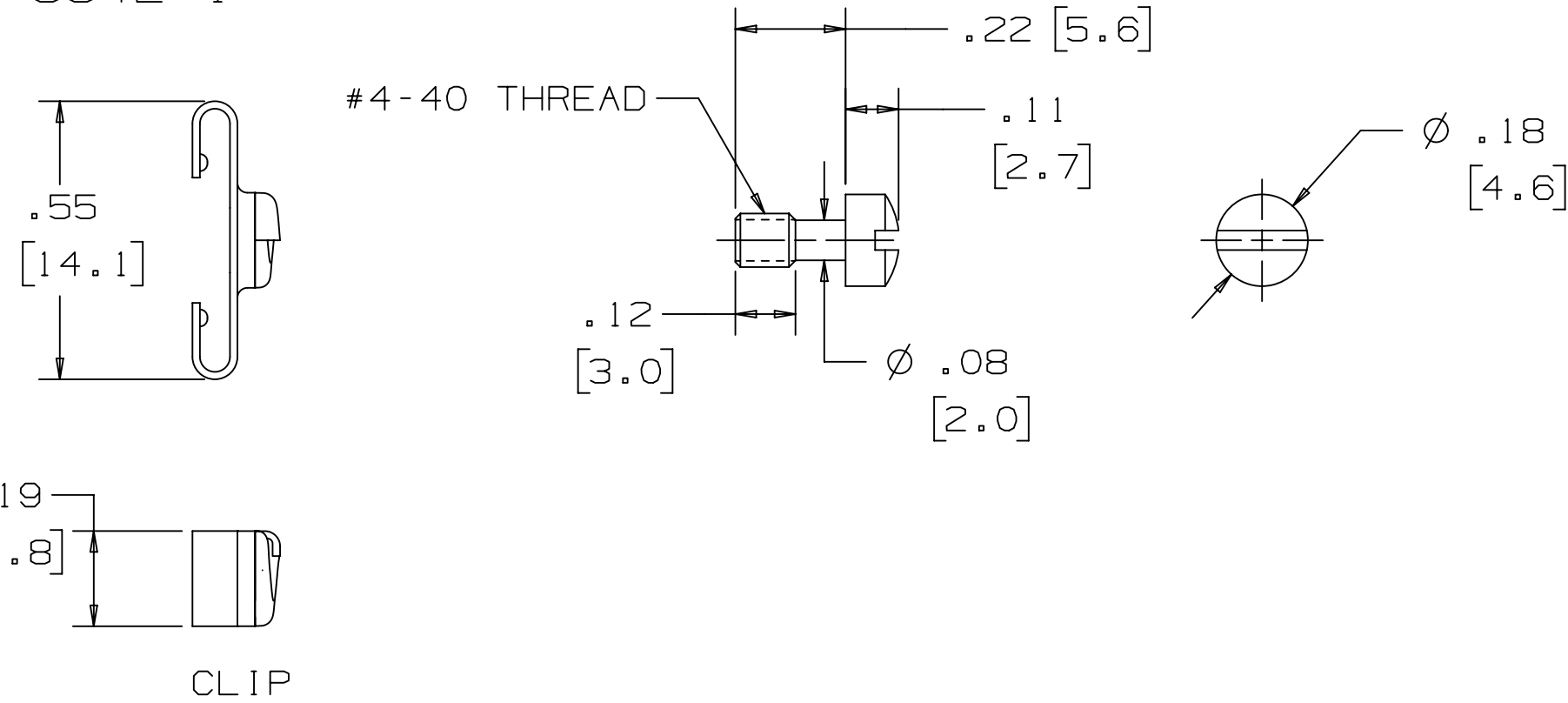

KIT CONTAINS:
2 - CLIPS
2 - JACK SCREWS

MATERIAL: STEEL
FINISH: ZINC WITH CLEAR CHROMATE
THREAD SIZE: #4-40
RECOMMENDED MAX. TORQUE: 7.0 INCH-lbs [0.8 N-m]

3M PART NUMBER: 3342-2

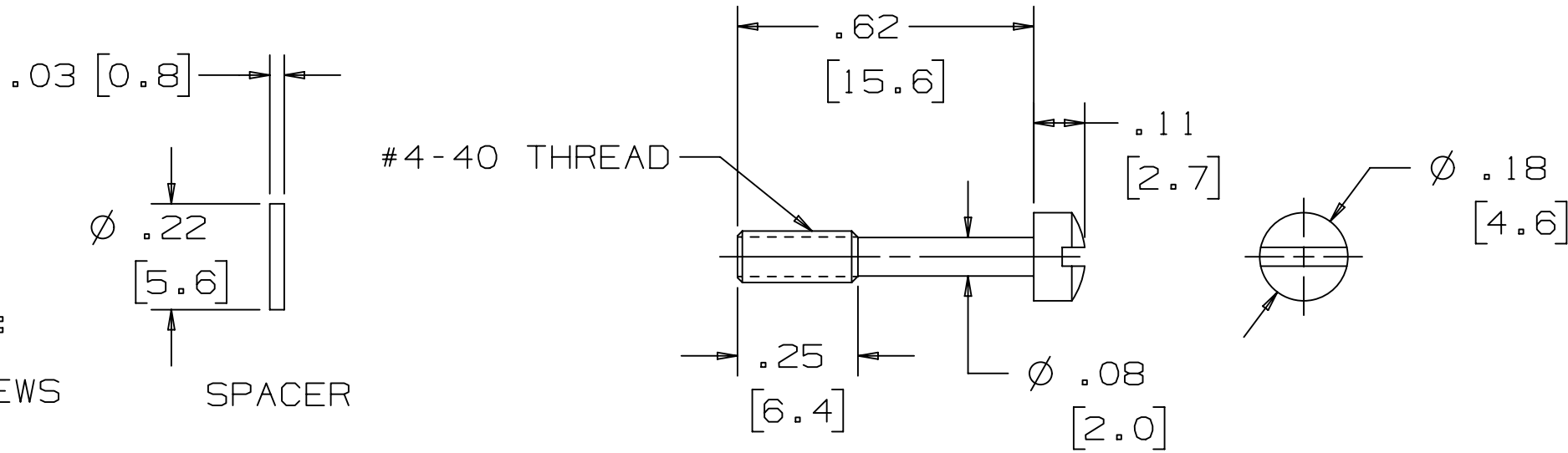

KIT CONTAINS:
2 - SPACERS
2 - JACK SCREWS

MATERIAL: STEEL
FINISH: ZINC WITH CLEAR CHROMATE
THREAD SIZE: #4-40
RECOMMENDED MAX. TORQUE: 7.0 INCH-lbs [0.8 N-m]

3M PART NUMBER: 3342-3

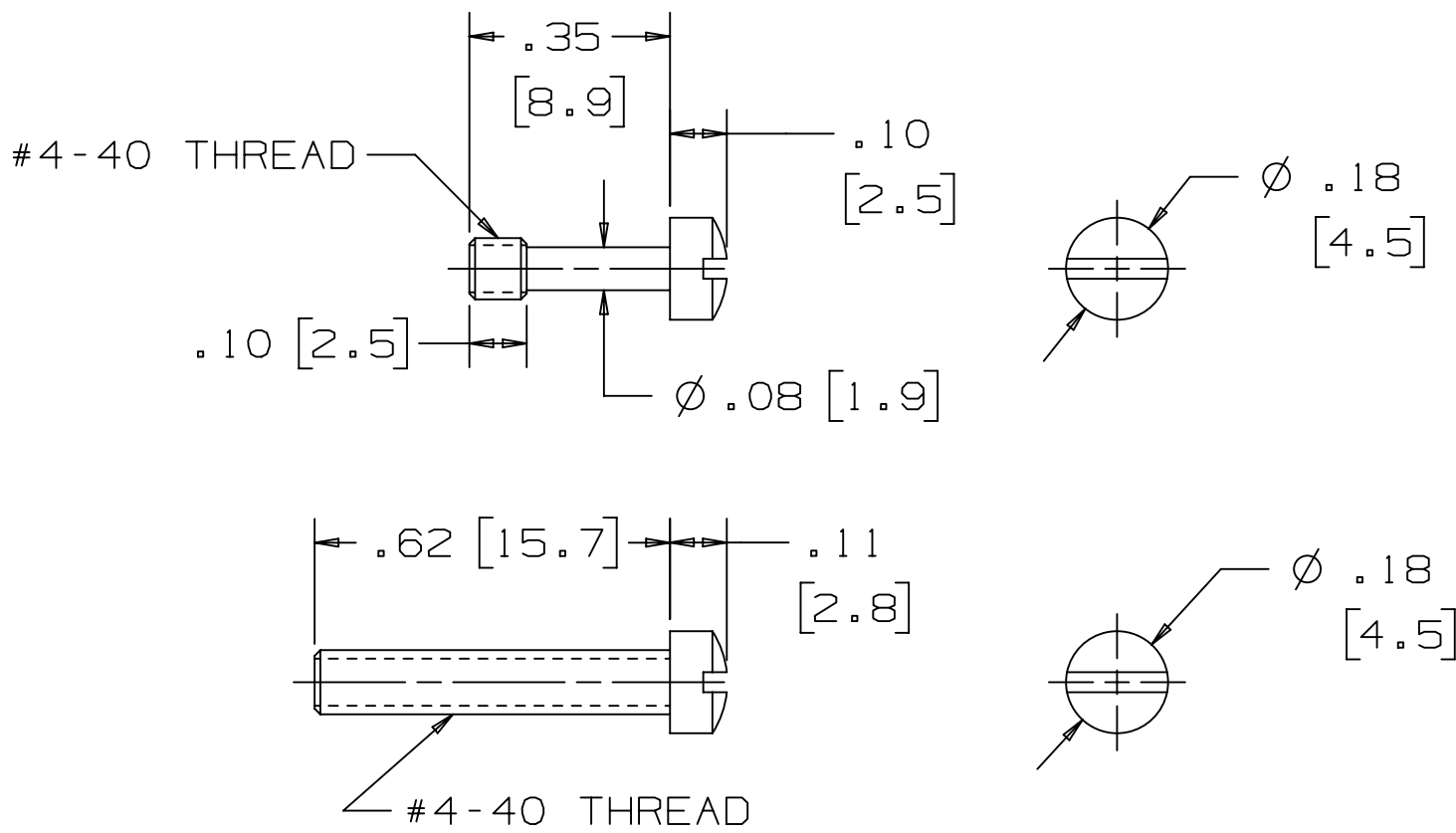

KIT CONTAINS:
2 - SCREWS
2 - JACK SCREWS

MATERIAL: STEEL
FINISH: ZINC WITH CLEAR CHROMATE
THREAD SIZE: #4-40
RECOMMENDED MAX. TORQUE: 7.0 INCH-lbs [0.8 N-m]

3M™ Display and Electronics Product Platform, (DEPP)
Transportation and Electronics Business Group (TEBG)
<http://www.3M.com/interconnect>

3M IS A TRADEMARK OF 3M COMPANY.
FOR TECHNICAL, SALES OR ORDERING
INFORMATION CALL 800-225-5373

JACK SCREW KITS

3M PART NUMBER: 3342-4

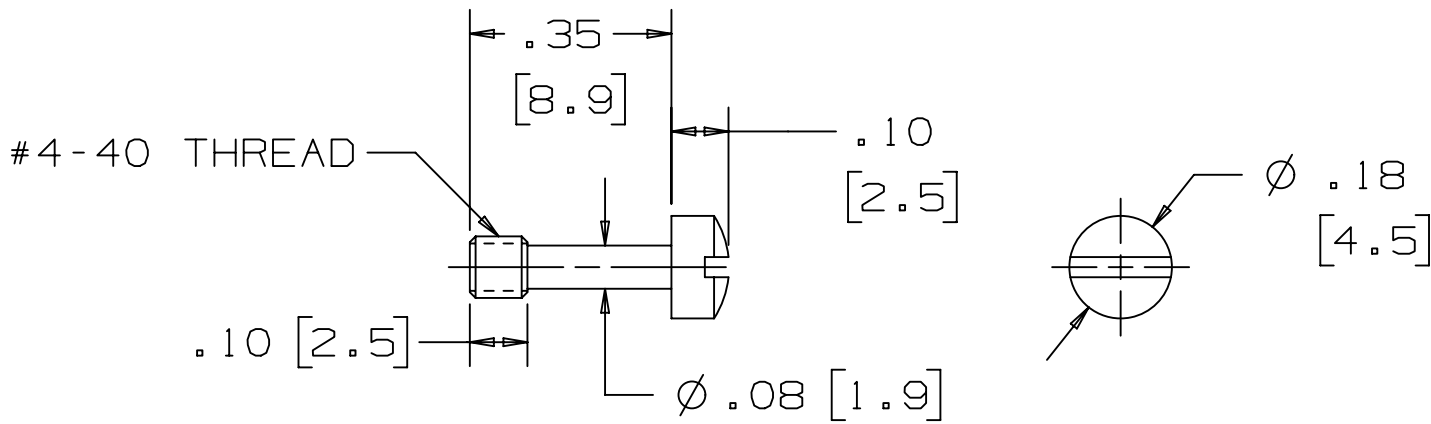

MATERIAL: STEEL
FINISH: ZINC WITH CLEAR CHROMATE
THREAD SIZE: #4-40
RECOMMENDED MAX. TORQUE: 7.0 INCH-lbs [0.8 N-m]

DESIGN REFERENCE		NEXT ASSEMBLY		REV	ECO	ISSUE DATE AND DESCRIPTION		DRFT	CHKD
XREFS		DIVISION CODE		DRFT	CAST	GLIONE	DATE	DATE	DATE
DIVISION		DEPP		CHKD	DATE	APPL	DATE	DATE	DATE
DO NOT SCALE DRAWING		TOLERANCES EXCEPT AS NOTED		3M		© 3M COPYRIGHT 2025 3M property and may not be reproduced or further distributed without 3M permission, or used or disclosed other than for 3M authorized purposes. All rights reserved.			
THIRD ANGLE PROJECTION		INCHES		TITLE		I/O CONNECTOR MTG OPTIONS & HARDWARE, TS-0142			
INTERPRET PER ASME Y14.5 - 2018		MILLIMETERS		CAGE NUMBER		DRAWING NO.		REV.	
MAX SURFACE ROUGHNESS		ALL SURFACES		D		78-5100-0142-9		K	
MARKED ONLY		ANGLES		MODEL		DET		SHT 4 OF 9	

3M™ I/O CONNECTOR MOUNTING OPTIONS AND HARDWARE

BOARD LOCK SCREWS

USE TO ATTACH CONNECTOR TO PRINTED CIRCUIT BOARD.
NOT FOR USE FOR PANEL MOUNTING.

3M PART NUMBER: 3344-3

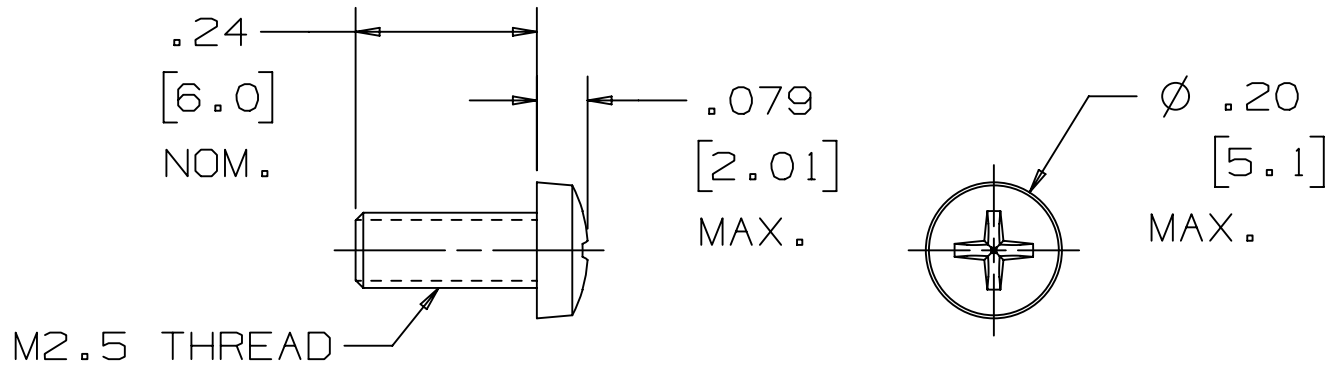

MATERIAL: STEEL
FINISH: NICKEL PLATED
THREAD SIZE: M2.5
RECOMMENDED MAX. TORQUE: 2.5 INCH-lbs [0.3 N-m]

3M PART NUMBER: 3344-4

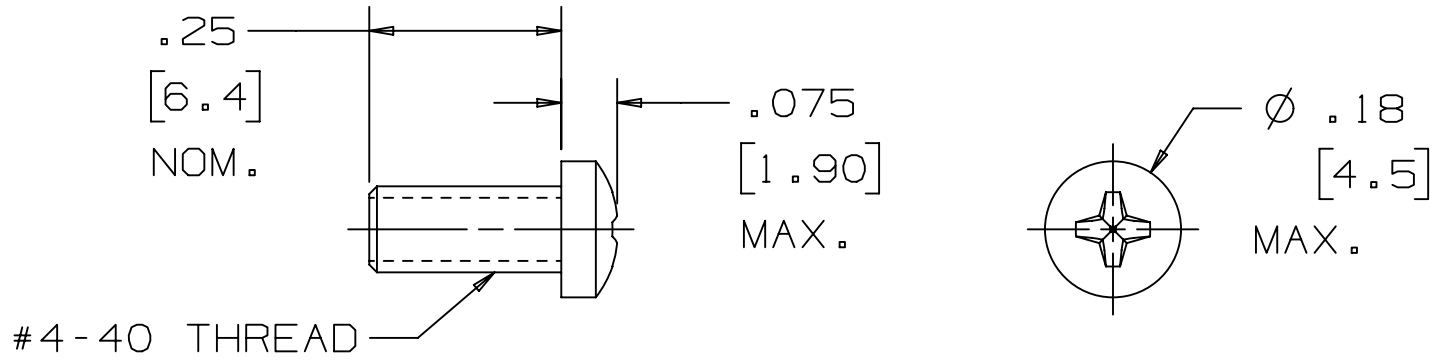

MATERIAL: STEEL
FINISH: NICKEL PLATED
THREAD SIZE: #4-40
RECOMMENDED MAX. TORQUE: 3.5 INCH-lbs [0.4 N-m]

3M PART NUMBER: 3344-26

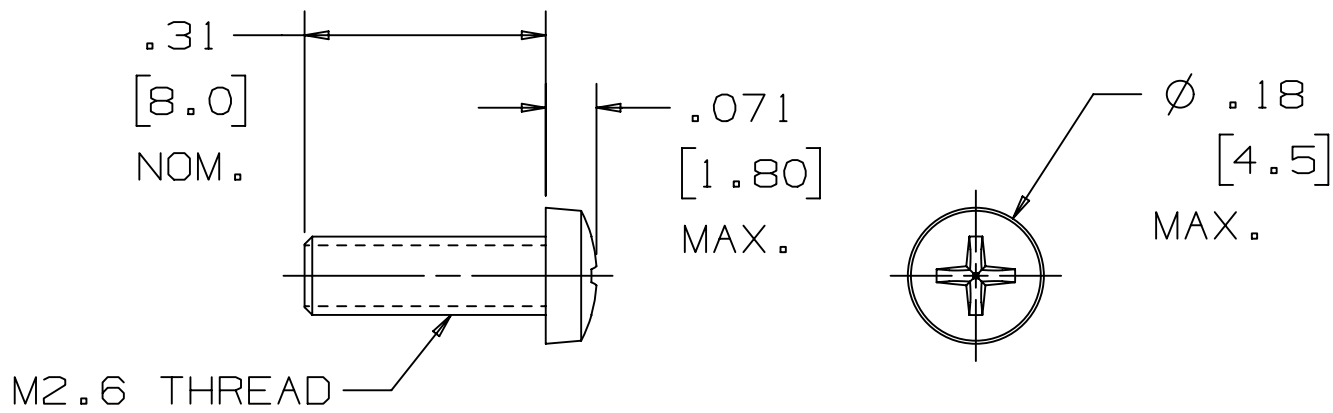

MATERIAL: STEEL
FINISH: ZINC
THREAD SIZE: M2.6
RECOMMENDED MAX. TORQUE: 2.5 INCH-lbs [0.3 N-m]

3M PART NUMBER: 3344-38

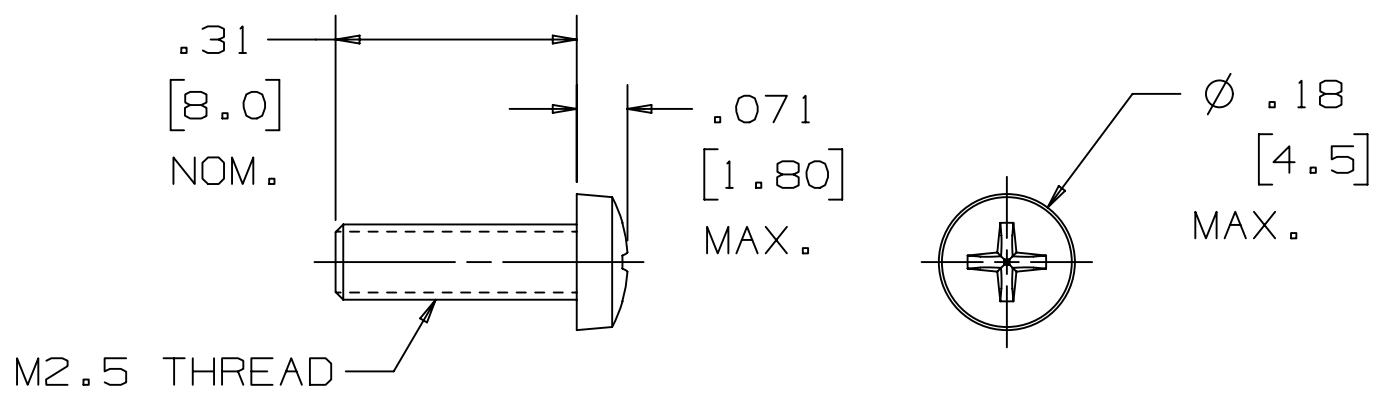

MATERIAL: STEEL
FINISH: ZINC
THREAD SIZE: M2.5
RECOMMENDED MAX. TORQUE: 2.5 INCH-lbs [0.3 N-m]

3M PART NUMBER: 3344-44

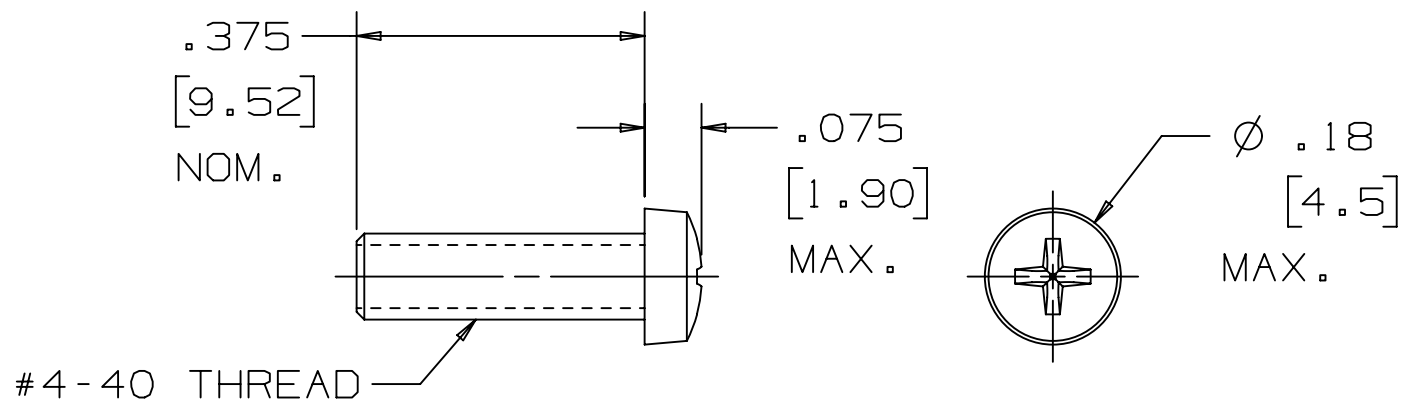

MATERIAL: STEEL
FINISH: ZINC
THREAD SIZE: #4-40
RECOMMENDED MAX. TORQUE: 3.5 INCH-lbs [0.4 N-m]

PANEL MOUNT SCREWS

USE TO ATTACH CONNECTOR TO PANEL OR CHASSIS.
NOT FOR USE FOR PCB MOUNTING.

3M PART NUMBER: 3344-45

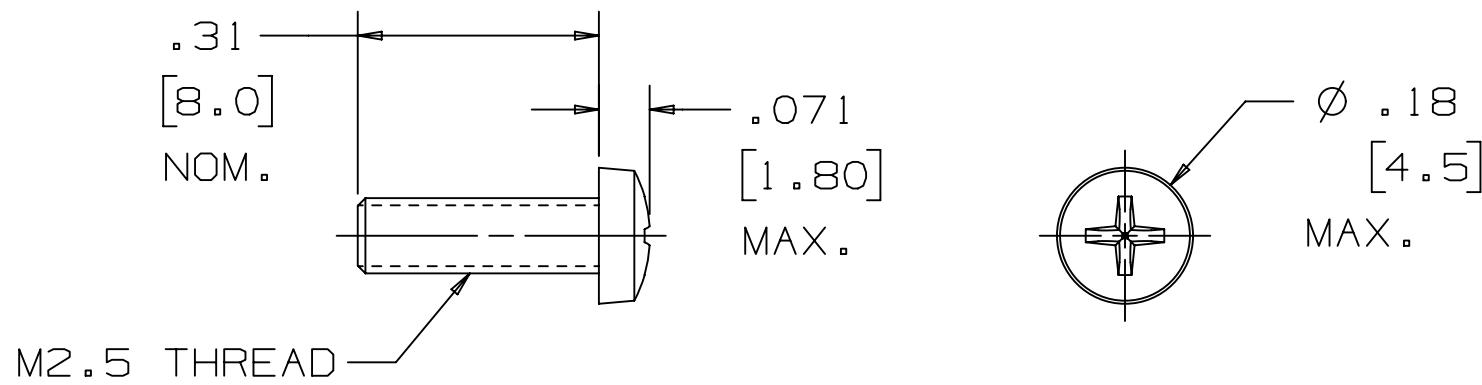

MATERIAL: STAINLESS STEEL
THREAD SIZE: M2.5
RECOMMENDED MAX. TORQUE: 2.5 INCH-lbs [0.3 N-m]

BOARD LOCK SCREW

USE TO ATTACH CONNECTOR TO PRINTED CIRCUIT BOARD.
NOT FOR USE FOR PANEL MOUNTING.

3M PART NUMBER: 3344-46

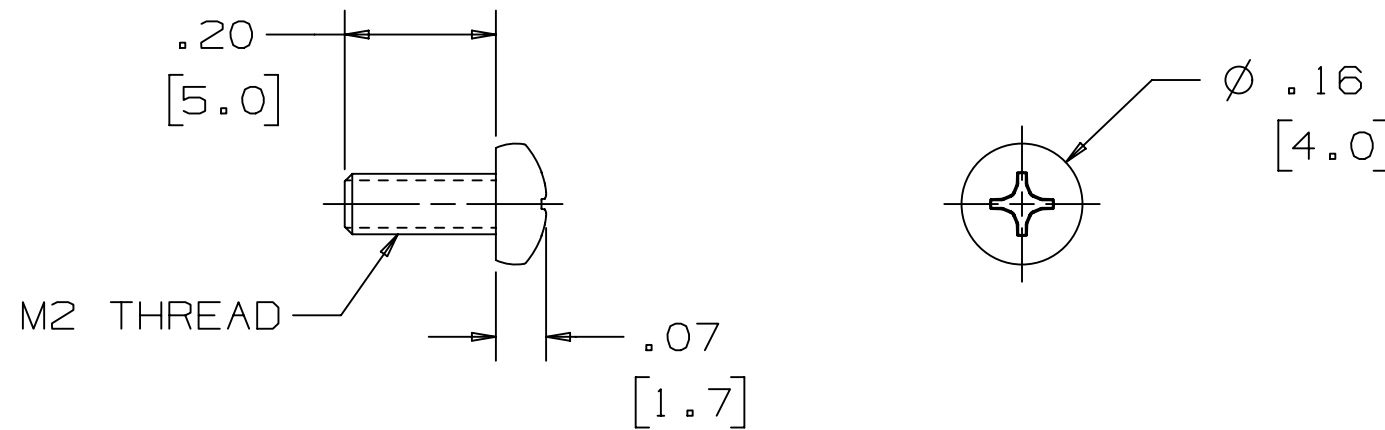

MATERIAL: STAINLESS STEEL
THREAD SIZE: M2
RECOMMENDED MAX. TORQUE: 2.5 INCH-lbs [0.3 N-m]

3M™ Display and Electronics Product Platform, (DEPP)
Transportation and Electronics Business Group (TEBG)
<http://www.3M.com/interconnect>

3M IS A TRADEMARK OF 3M COMPANY.
FOR TECHNICAL, SALES OR ORDERING
INFORMATION CALL 800-225-5373

DESIGN REFERENCE		NEXT ASSEMBLY		REV	ECO	ISSUE DATE AND DESCRIPTION		DRFT	CHKD
XREFS		XREFS		DRFT	CST	GL	ONE	DATE	DATE
DIVISION		DIVISION CODE		CHKD	DATE	DATE	APPL	DATE	DATE
DO NOT SCALE DRAWING		SCALE		TOLERANCES EXCEPT AS NOTED		INCHES			
THIRD ANGLE PROJECTION		INTERPRET PER ASME Y14.5 - 2018		MILLIMETERS		0 ±			
MAX SURFACE ROUGHNESS		ALL SURFACES		0 ±		0 ±			
MARKED ONLY		ANGLES		0 ±		0 ±			
3M		3M Center St. Paul, MN 55144		© 3M COPYRIGHT 2025		This document and the information it contains are 3M property and may not be reproduced or further distributed without 3M permission, or used or disclosed other than for 3M authorized purposes. All rights reserved.			
TITLE		I/O CONNECTOR MTG OPTIONS & HARDWARE, TS-0142		CAGE NUMBER		DRAWING NO.		REV.	
MODEL		D78-5100-0142-9		K		SHT 5 OF 9		REV.	
LISTS		YES		NO		SHT 5 OF 9		REV.	

3M™ I/O CONNECTOR MOUNTING OPTIONS AND HARDWARE

BAIL MOUNT KITS FOR D-RIBBON CONNECTORS

3M PART NUMBER: 3475-1

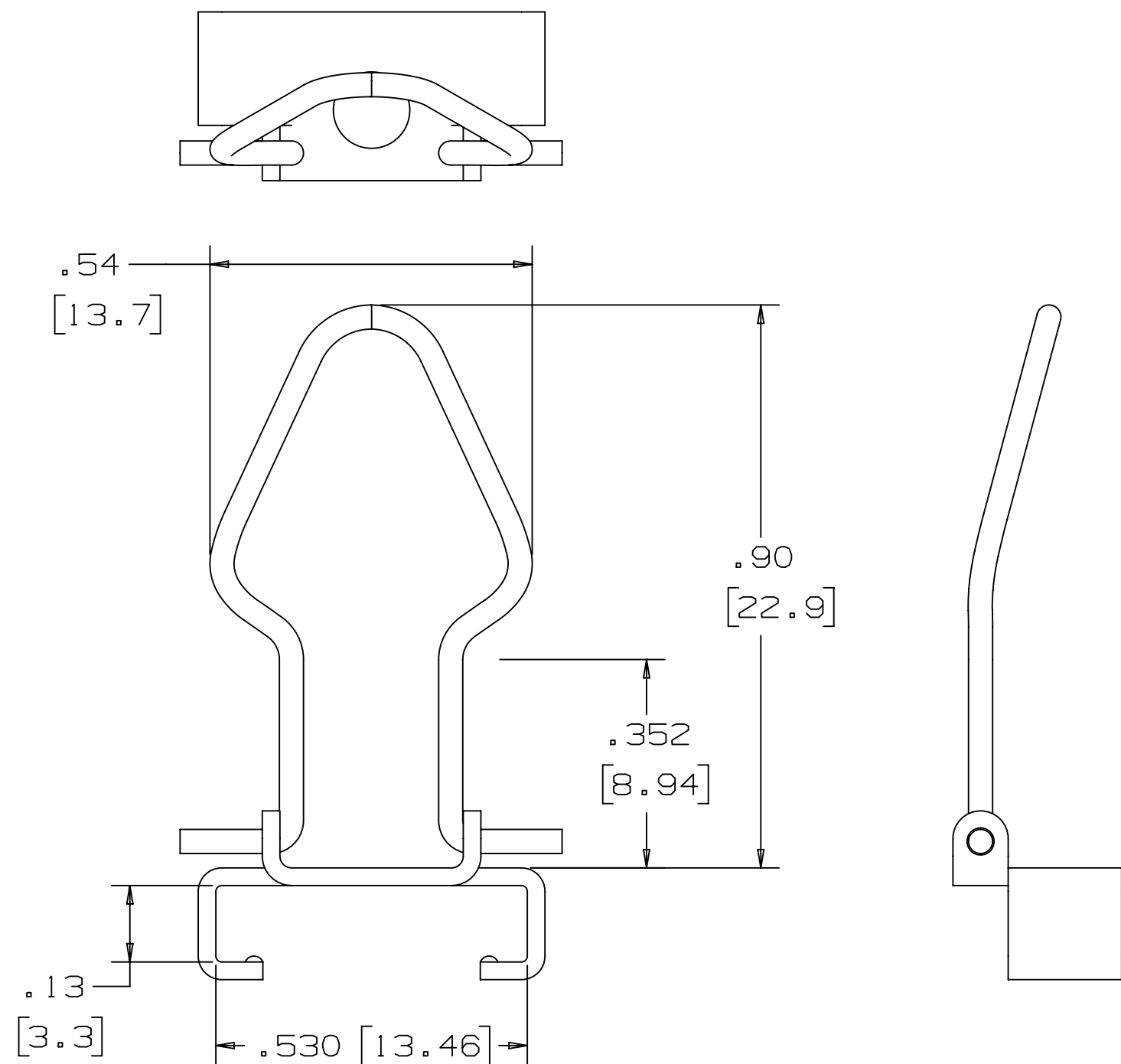

PLASTIC CONNECTORS
MOUNTED TO FRONT OF PANEL

3M PART NUMBER: 3475-4

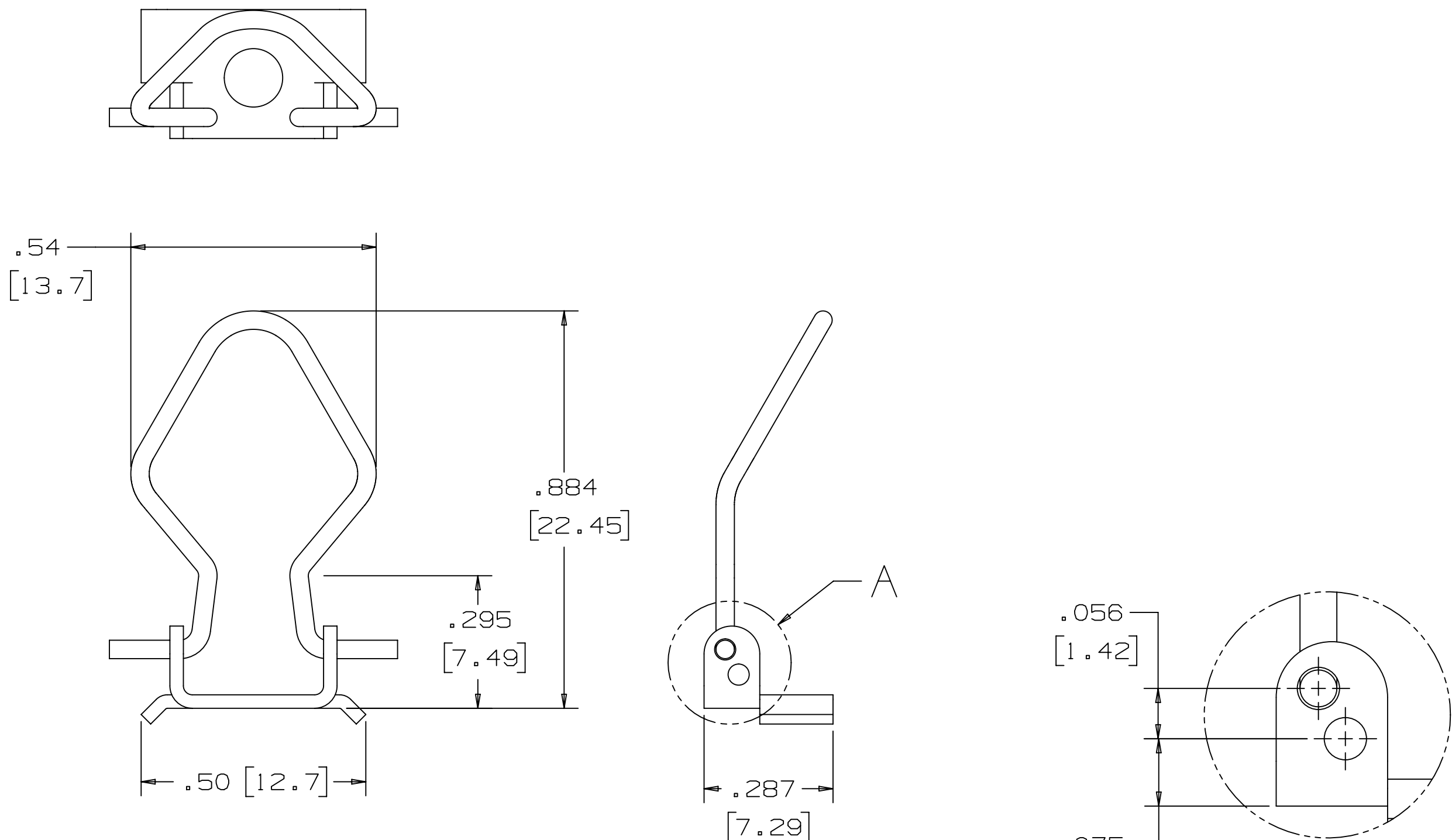

PLASTIC AND METAL FACED CONNECTORS
MOUNTED TO REAR OF
.0625, .075, .125 PANELS.

3M PART NUMBER: 3475-5

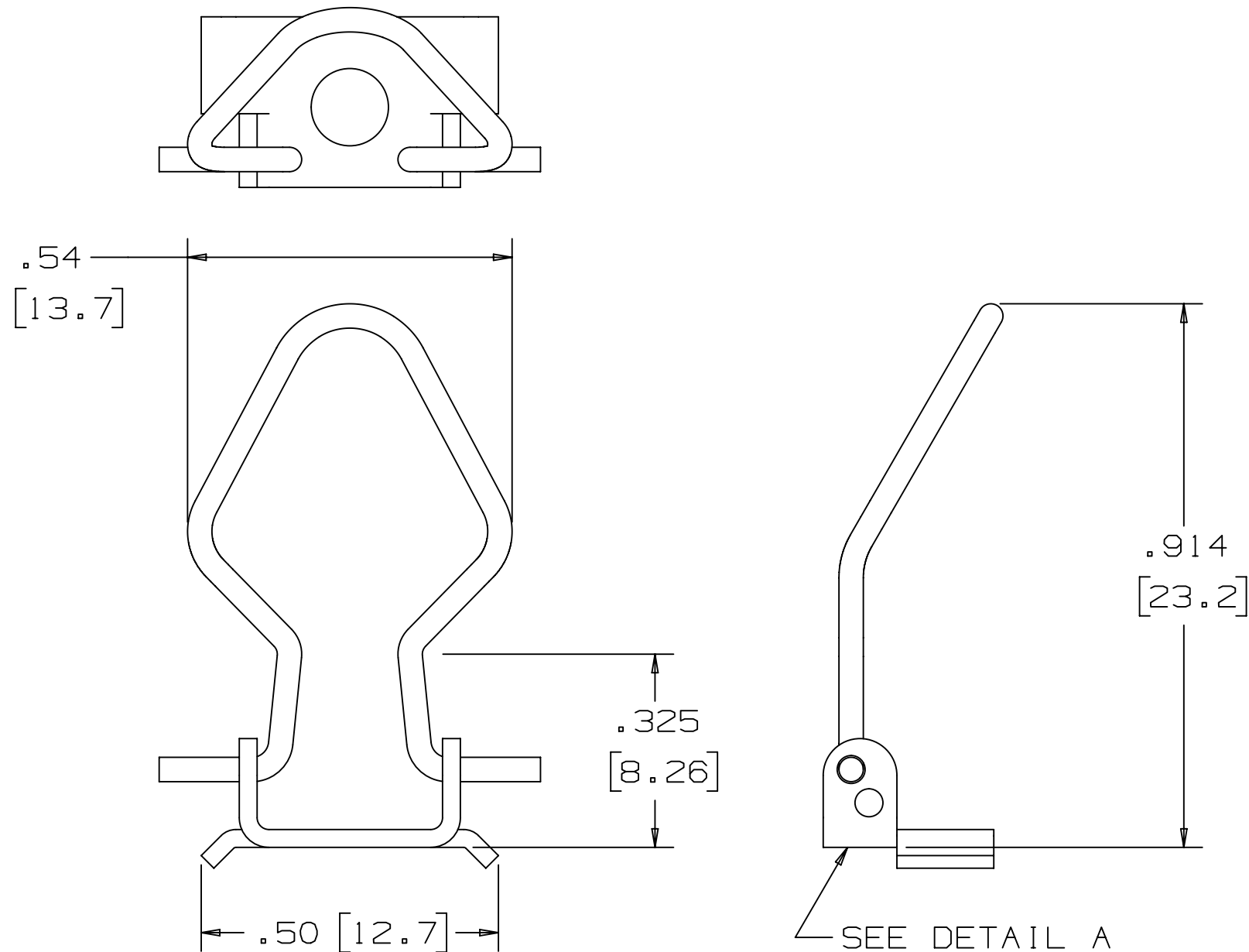

PLASTIC AND METAL FACED CONNECTORS
MOUNTED TO REAR OF
.035, .042, .094 PANELS.

- KITS CONTAIN, 2 EACH:
- * BAIL ASSEMBLY
 - * SCREW - #4-40 X .50 LG ROUND HEAD SLOTTED
 - * NUT - #4-40 UNC
 - * WASHER-LOCK-SPLIT

MATERIAL - TABLE 2	
BAIL ASSEMBLY	STEEL, ZINC PLATED
SCREW	STEEL, ZINC PLATED
NUT	STEEL, ZINC PLATED
WASHER	STEEL, ZINC PLATED

D-RIBBON & PLASTIC CONNECTORS - TABLE 3					
CONTACT QTY.	MATING CONNECTORS		JUNCTION SHELL	STRAIN RELIEF	PULL-TAB
	PLUG	SOCKET	PLASTIC		
14	3572-100X	3573-100X	3485-1800Y	3448-60	3490-2
24	3548-100X	3549-100X	3485-1700Y	3448-61	3490-2
36	3366-100X	3367-100X	3485-2800Y	3448-62	3490-3
50	3564-100X	3565-100X	3485-2500Y	3448-63	3490-5

OPTIONS FOR TABLE 3:
X = MOUNTING STYLE
Y = "F" FOR FLAT CABLE, "R" FOR ROUND CABLE

INCH [MM]		
TOLERANCE - UNLESS NOTED		
	.X	.XX
	.XXX	
INCH	±.1	±.01
	±.005	
[] = DIM. FOR REFERENCE ONLY		

TOLERANCE BOX APPLIES TO THIS SHEET ONLY FOR BAIL MOUNT KITS

DESIGN REFERENCE	NEXT ASSEMBLY	REV	ECO	ISSUE DATE AND DESCRIPTION	DRFT	CHKD
CODES		DRFT	CST	GLT	ONE	DATE
		CHKD		DATE	APPR	DATE
DIVISION	DIVISION CODE	DEPP				
DO NOT SCALE DRAWING	SCALE	TOLERANCES EXCEPT AS NOTED				
THIRD ANGLE PROJECTION	INTERPRET PER ASME Y14.5 - 2018	INCHES				
MAX SURFACE ROUGHNESS	ALL SURFACES	MILLIMETERS				
MARKED ONLY	ANGLES					
		3M				
		© 3M COPYRIGHT 2025				
		This document and the information it contains are 3M property and may not be reproduced or further distributed without 3M permission, or used or disclosed other than for 3M authorized purposes. All rights reserved.				
		TITLE				
		I/O CONNECTOR MTG OPTIONS & HARDWARE, TS-0142				
		CAGE NUMBER	SIZE	DRAWING NO.	REV.	
		D	78-5100-0142-9	K		
		MODEL	DET	ISTS	YES	NO
		SHT 6 OF 9				

3M™ Display and Electronics Product Platform, (DEPP)
Transportation and Electronics Business Group (TEBG)
<http://www.3M.com/interconnect>

3M IS A TRADEMARK OF 3M COMPANY.
FOR TECHNICAL, SALES OR ORDERING
INFORMATION CALL 800-225-5373

3M™ I/O CONNECTOR MOUNTING OPTIONS AND HARDWARE

JACK SOCKET SCREWS

USE TO ATTACH CONNECTOR TO PANEL OR CHASSIS.
NOT FOR USE FOR PC BOAED MOUNTING.

3M PART NUMBER: 12600-S-08
FOR .03" [0.8MM] PANEL THICKNESS

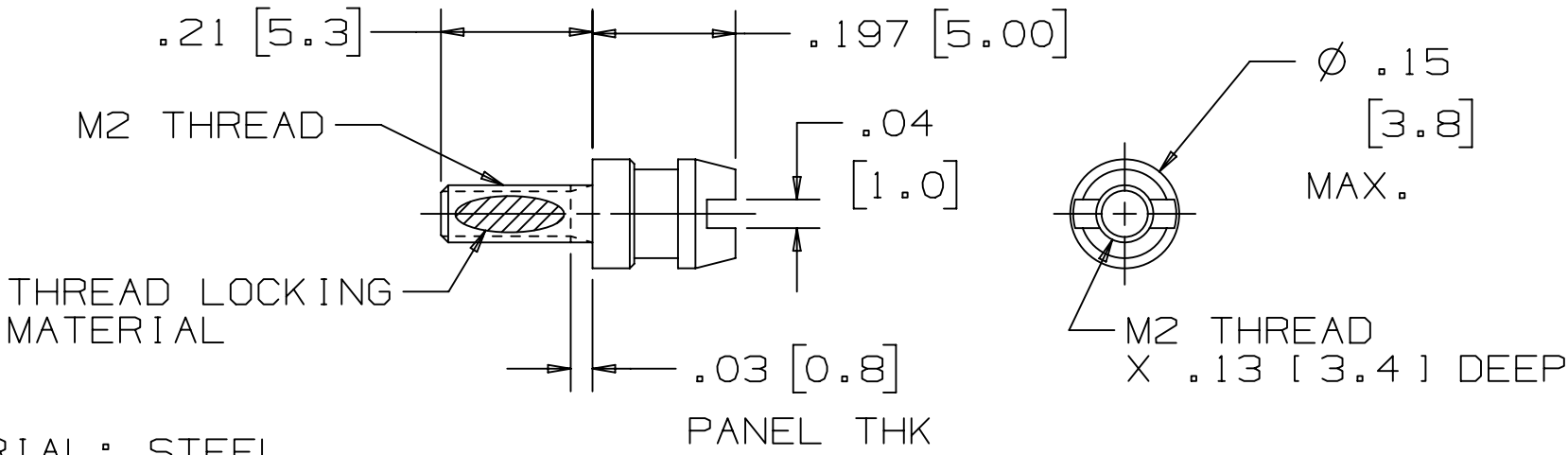

MATERIAL: STEEL
FINISH: NICKEL PLATED
SCREW / SOCKET THREAD SIZE: M2/M2
RECOMMENDED MAX. TORQUE: 2.5 INCH-lbs [0.3 N-m]

3M PART NUMBER: 12600-S-10
FOR .04" [1.0MM] PANEL THICKNESS

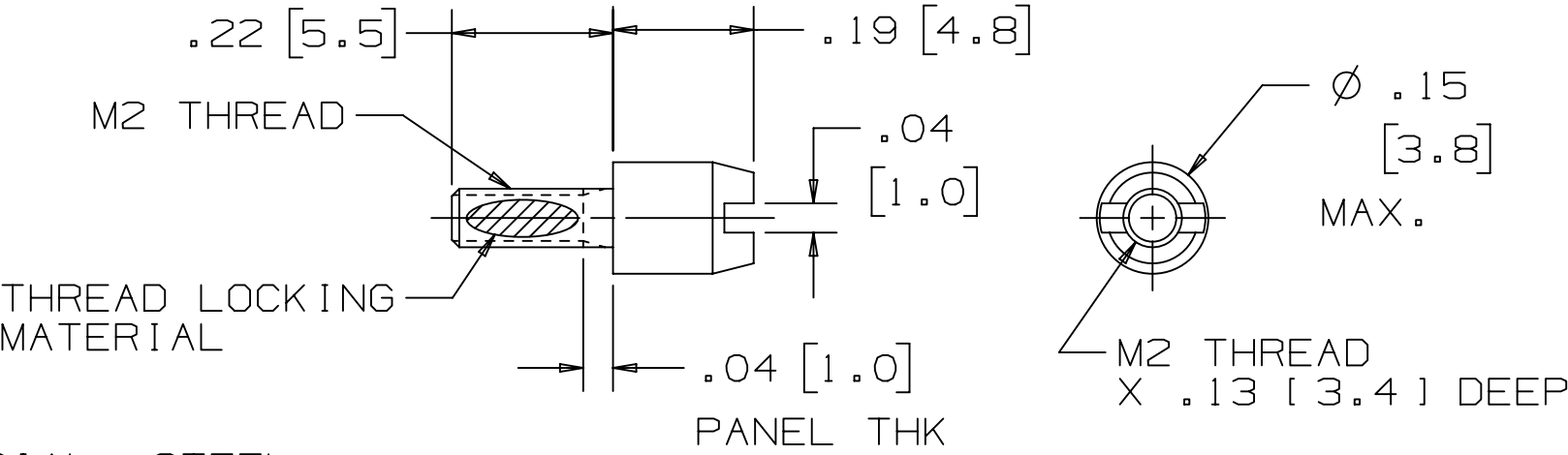

MATERIAL: STEEL
FINISH: NICKEL PLATED
SCREW / SOCKET THREAD SIZE: M2/M2
RECOMMENDED MAX. TORQUE: 2.5 INCH-lbs [0.3 N-m]

3M PART NUMBER: 12600-S-12
FOR .05" [1.2MM] PANEL THICKNESS

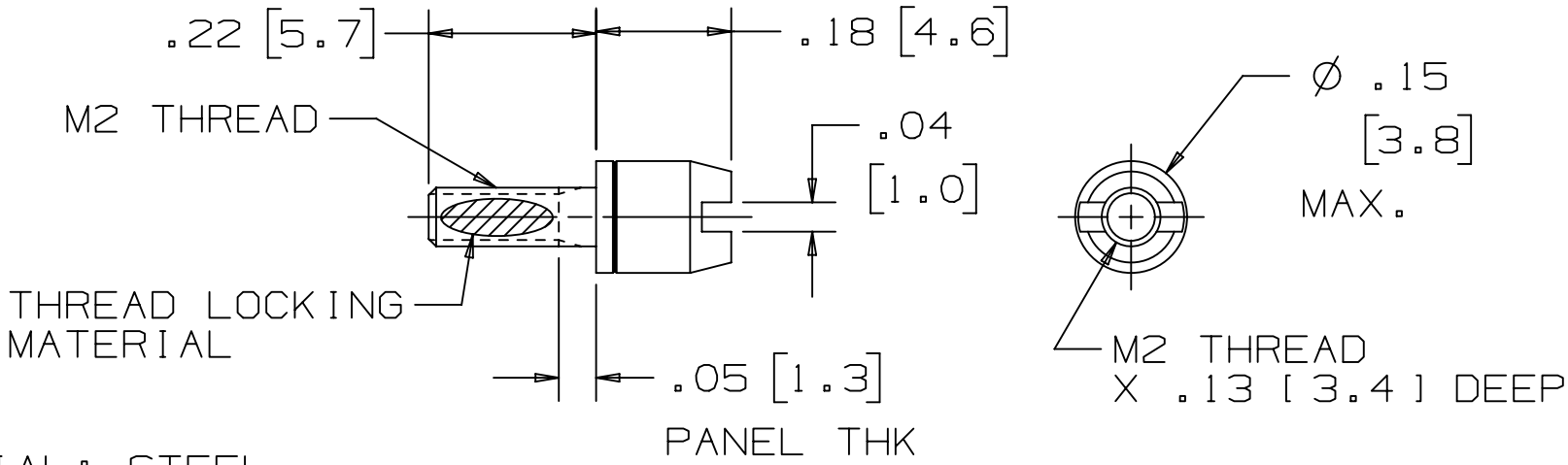

MATERIAL: STEEL
FINISH: NICKEL PLATED
SCREW / SOCKET THREAD SIZE: M2/M2
RECOMMENDED MAX. TORQUE: 2.5 INCH-lbs [0.3 N-m]

3M™ Display and Electronics Product Platform, (DEPP)
Transportation and Electronics Business Group (TEBG)
<http://www.3M.com/interconnect>

3M IS A TRADEMARK OF 3M COMPANY.
FOR TECHNICAL, SALES OR ORDERING
INFORMATION CALL 800-225-5373

				K 124489		JUL 25, 2025		JNC		FJR		
				J 0046915		REVISED AND REDRAWN						
						JUL 07, 2013		DFC		ARM		
						REMOVE QTY & PKG						
DESIGN REFERENCE				NEXT ASSEMBLY		REV ECO		ISSUE DATE AND DESCRIPTION		DRFT		CHKD
ACCESS CODES						DRFT CASTIGLIONE		DATE JUL 25, 2025		MFG		DATE
						CHKD		DATE		APPL		DATE
DIVISION				DIVISION CODE DEPP								
DO NOT SCALE DRAWING				SCALE		TOLERANCES EXCEPT AS NOTED		3M 3M Center St. Paul, MN 55144		© 3M COPYRIGHT 2025		
										This document and the information it contains are 3M property and may not be reproduced or further distributed without 3M permission, or used or disclosed other than for 3M authorized purposes. All rights reserved.		
				INCHES		MILLIMETERS		TITLE		I/O CONNECTOR MTG OPTIONS & HARDWARE , TS-0142		
THIRD ANGLE PROJECTION				0.00 ±		0 ±						
INTERPRET PER ASME Y14.5 - 2018				0.000 ±		0.00 ±		CAGE NUMBER		D78-5100-0142-9		REV. K
MAX. SURFACE ROUGHNESS				0.00 ±		0.00 ±		SIZE		DRAWING NO.		
ALL SURFACES				0.00 ±		0.00 ±		MODEL		DET. LISTS		YES <input checked="" type="checkbox"/> NO <input type="checkbox"/>
MARKED ONLY				0.00 ±		0.00 ±				SHT 7 OF 9		
				ANGLES ±								

