

Installation Instructions for Undersink Drinking Water Systems

Tools Required

Variable Speed Drill
12.5 mm (1/2") drill bit
Adjustable Spanner
Screwdriver
2 x Screws (if you intend to mount the product)

Step by Step Instructions

1. Install the Saddle Valve

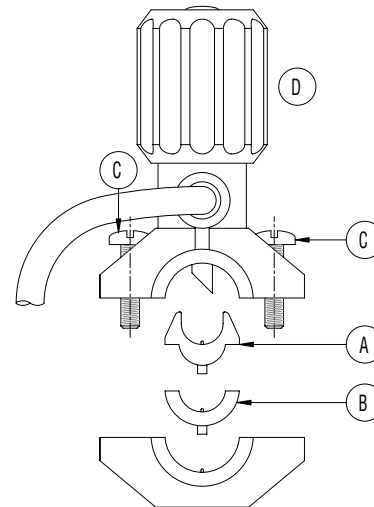

- 1.1 Locate and selection a straight section of the cold water supply line (copper)
- 1.2 Check outside diameter (O.D.) of the pipe - use saddles (A) + B for 3/8" O.D., only saddle (B) for 1/2" O.D. or No Saddles for 5/8" O.D.
- 1.3 Clamp around the pipe/water line using two damping screws (D). Tighten evenly.
- 1.4 Leave and move onto next stage.

Contents of Box

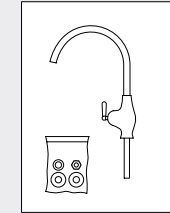

Tap Kit

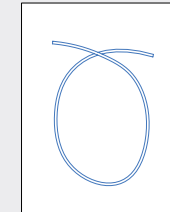

Blue Connecting Tubing

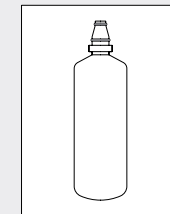

Filter Cartridge

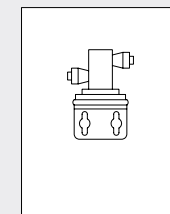

Head

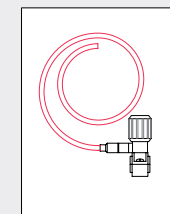

Saddle Valve Kit

3M

Cuno Filtration Products
3M United Kingdom PLC

3M Centre, Cain Road
Bracknell, Berkshire RG12 8HT
Tel: 01344 858000

Web: www.3mselect.co.uk/waterfilters

3M

Installation Instructions for Undersink Drinking Water Systems

2. Install the Tap

2.1 Using a 12.5mm (1/2") drill bit and variable speed drill make a hole in your chosen position in the work surface or sink top directly above the cupboard in which you are installing the drinking water systems. It is advisable to install so that tap dispenses over a sink or drainage area. Also try to install where easy access for tightening the compression nut under the surface is available. Size up the distance between where you are placing the tap and the saddle valve to ensure that the connecting tubing is long enough.

CAUTION: If in doubt when drilling through different surfaces like marble, stone or slate or metal please consult an expert as you may require specialist drilling techniques.

2.2 Put the end of the tap through the chrome plate and black rubber washer and then through the hole in the counter top, then secure under the top with locating washers, then the lock washer and finally the nut.

2.3 Before attaching the blue tubing, slide the brass nut and then the olive over the end of the tubing to be attached to the tap. Insert the sleeve into the end of the blue tubing. Push the blue tubing into the end of the tap and secure it by tightening the brass compression nut around the threaded tap end using adjustable spanner.

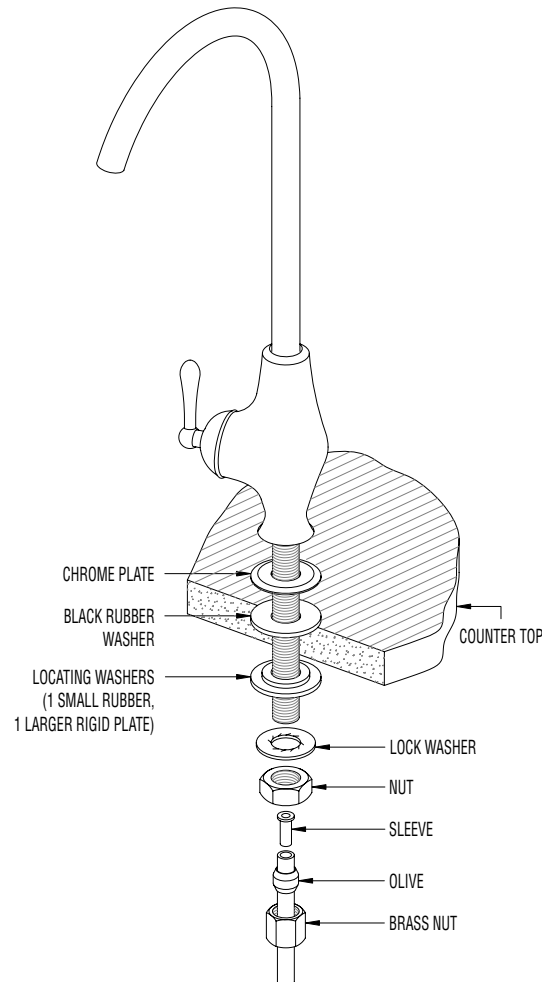

3. Install the Head

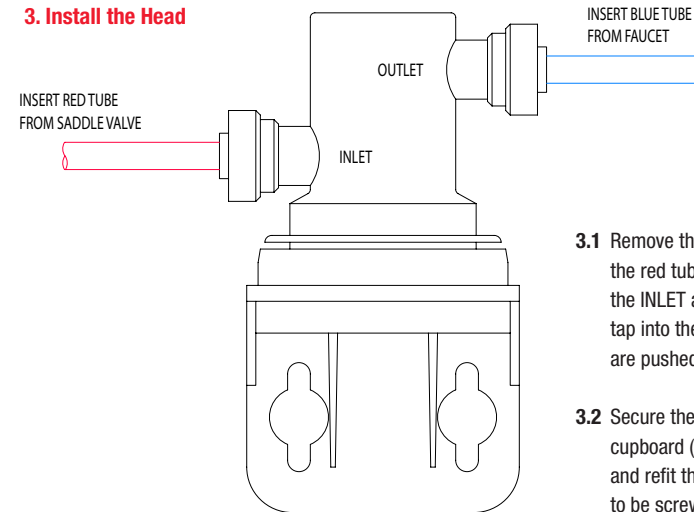

3.1 Remove the head from the filter and insert the red tubing from the saddle valve into the INLET and the blue tubing from the tap into the OUTLET making sure the tubes are pushed in as far as they can go.

3.2 Secure the head inside the under sink cupboard (using screws – not supplied) and refit the filter. The head does not need to be screwed in place and alternatively the head and filter unit can be laid down or stand unsecured in the cupboard.

4. Turning on the system

4.1 Turn the adjustment valve (D) on the saddle valve as far as it will go to pierce the water line (pipe). There may well be a 'hissing' sound when the water line is pierced.

4.2 Start the flow of water by opening (clockwise) the valve all the way. Adjust down to decrease the flow.

4.3 Turn on the tap to release any air trapped in the filter and run through the system for 2 minutes or until the water runs clear.

