



# Individually Wrapped Rolls Now Available!

## Product Specifications

### Scotch® Performance Masking Tape 233+

| PART NO. | DESCRIPTION                     | RLS/SLV | RLS/CASE |
|----------|---------------------------------|---------|----------|
| 46334    | 18mm X 55m (3/4" applicators)   | 1       | 48       |
| 46338    | 36mm X 55m (1 1/2" applicators) | 1       | 24       |

- Highly conformable
- Provides outstanding paint lines
- Improved adhesive transfer resistance

### 3M™ Masking Tape 2308

| PART NO. | DESCRIPTION                     | RLS/SLV | RLS/CASE |
|----------|---------------------------------|---------|----------|
| 46545    | 18mm X 55m (3/4" applicators)   | 1       | 48       |
| 46547    | 36mm X 55m (1 1/2" applicators) | 1       | 24       |

- Consistent adhesive coating
- Adhesive transfer resistance
- Consistent unwind
- Excellent paint edge



## Tips & Techniques

### Application Methods



**Avoid stretching tape:** Pull tape off roll a few feet at a time and press down a small area without stretching. The tape backing is designed to conform to curved surfaces. If shrinking should occur during spraying or drying, it is desirable to have as much stretch left in the tape as possible.

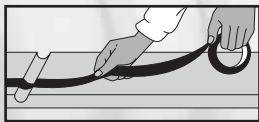

**Lay tape into surface depressions:** If it is stretched and forced down, the tape may lift up or, in some cases, break.



**Press edge of tape down firmly:** In all two-color masking, where a sharp color separation is desired, it is imperative to press the edges of the tape down firmly. This will help prevent seepage and jagged paint lines.

### Removal Methods

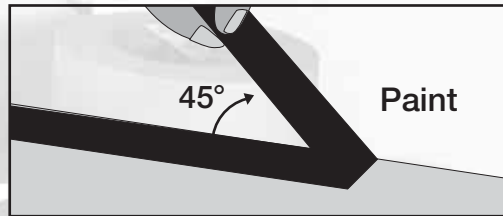

**Speed of removal:** Moderate speeds are best. Excessive rate of removal may cause tearing. Very slow rate of removal increases tendency to transfer adhesive.

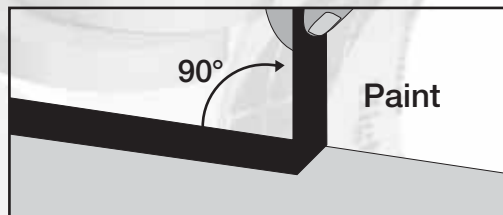

**Angle of removal:** A 45° angle works best. Remove tape back on itself as shown in illustration. If adhesive begins to transfer, remove tape at a 90° angle.



**Cool removal:** Adhesive is firm and removal is generally clean. However, excessively cold temperatures can cause the tape to become brittle and tear (<50°F).



**Normal removal:** Counteracts negative effects of hot and cold removal. The adhesive is firm enough for clean removal and yet is not so firm as to increase adhesion to a point where tearing occurs. Removal temperatures of 50°F-100°F are recommended.



**Warm removal:** Increases adhesive transfer possibilities, but less effort is required to remove tape (>100°F).

