

 **Speedglas™**



Adflo PAPR



Fresh-air III SAR



9100



9100-Air



9100 FX



9100 FX-Air



9100 MP



SL



100 Series



3M Welding Helmet 10



3M Headgear L-Series SG



3M Faceshield ClearVisor

PRODUCT OVERVIEW

3M Welding PPE Presentation



Product overview

Welding Helmet Options

Options	3M™ Speedglas™ Welding Helmet 9100 Series and 3M™ Headgear L-Series SG					3M™ Speedglas™ Welding Helmet SL	3M™ Speedglas™ Welding Helmet 100 series			3M™ Welding Helmet 10
Welding Filters	 9100XXi	 9100XX	 9100X	 9100V	 9100 Passive	 SL	 100V	 100S-10	 100S-11	 10V
Welding Helmets										

Options	With Hard Hat (Non-Air)			With 3M™ Adflo™ Powered Air Purifying Respirator			With 3M™ Speedglas™ Fresh Air III Supplied Air Regulator		
Welding Helmet Systems									

FEATURES

TECHNICAL FACTS

FUNCTIONS

CARE & MAINTENANCE

ACCESSORIES

PARTS LIST

3M™ Speedglas™ Welding Helmet 9100 FX



Side windows: Shade 5 filters that increase your field of view.

Compatible with our top-of-the-line series of 3M™ Speedglas™ Welding Filter Series 9100.

The approx. 8 x 4.25 in. (17 x 10 cm) clear protective visor is curved, increasing your peripheral vision.

Ergonomically designed head suspension.

Deflectors inside the helmet help direct exhaled air out.

Meets the requirements of CSA Z94.3 and the high impact requirements of ANSI Z87.1 – 2010.



3M™ Speedglas™ Welding Helmet 9100

Welding filter options	9100XXi Filter	9100XX Filter	9100X Filter	9100V Filter
Viewing area welding filter (approx.)	2.8 x 4.2 in. (72 x 107 mm)	2.8 x 4.2 in. (72 x 107 mm)	2.1 x 4.2 in. (54 x 107 mm)	1.8 x 3.7 in. (45 x 93 mm)
Battery lifetime (approx.)	1800 hours	2000 hours	2500 hours	2800 hours
Solar cell	NO	NO	YES	YES
Hard hat options	YES (Non air version)	YES (Non air version)		
Classification (per EN 379)*	1 / 1 / 1 / 2	1 / 1 / 1 / 2		
Dark state	Shade 5, 8, 9-13	Shade 5, 8, 9-13		
Light state	Shade 3	Shade 3		
UV/IR Protection	Shade 13 (permanent)	Shade 13 (permanent)		
Auto ON	Yes	NO		
Switching time, light–dark (approx.)	0.1 ms (+23°C)	0.1 ms (+23°C)		
Delay, switching time dark-light (approx.)	40–1 300 ms	40–1 300 ms		
Side windows option	YES	YES		
Exhaust vents	YES (Non-air version)	YES (Non-air version)		
Number of sensors (arc detection)	3	3		
Approvals Head, Eye and Face protection Welding helmet, welding filter, protection plates	ANSI Z87.1–2010 / CSA Z94.3	ANSI Z87.1–2010 / CSA Z94.3		

* Per European Standard EN 379, auto-darkening welding filters have a four-part classification: optical class / diffusion of light / variation on luminous transmittance / angle dependence. Classifications range from 1 to 3, with 1 being the best.

3M™ Speedglas™ Auto-Darkening Filter Series 9100

Excellent Optics, Wider Views

Magnification made easy. The magnifying lens holder is built into the welding filter, making lens installation easier and more secure.

The Speedglas welding filter series 9100 include three auto-darkening filters: regular, large and extra-large viewing area.



The tack welding comfort mode uses an intermediate shade 5 light state to help minimize eye strain during extended tack welding applications.

You can adjust the sensitivity of the arc detection for switching reliability.



New 9100XXi

The Delay function allows you to set the dark-to-light switching time.

Seven user selectable dark shades for most types of arc welding.

3M™ Speedglas™ Welding Helmet 9100 FX with Hard Hat



[FEATURES](#)[TECHNICAL FACTS](#)[FUNCTIONS](#)[CARE & MAINTENANCE](#)[ACCESSORIES](#)[PARTS LIST](#)

3M™ Speedglas™ Welding Helmet 9100 FX



06-0700-82
Extended headcover, head and neck



06-0500-52
Extended coverage, ear and neck



06-0700-83
Full hood



06-0500-56 – 06-0500-59
Magnification plates 1.5X, 2.0X, 2.5X and 3.0X



H505B
3M™ Peltor™ Welding Earmuff



06-0614-00NR
Hard Hat adapter with assembly parts



04-0023-02
Hard Hat, white



06-0600-10HHSW with ADF 9100V
06-0600-20HHSW with ADF 9100X
06-0600-30HHSW with ADF 9100XX
Systems with 3M™ Hard Hat H-701R (04-0023-02)

3M™ Speedglas™ Welding Helmet 9100 FX

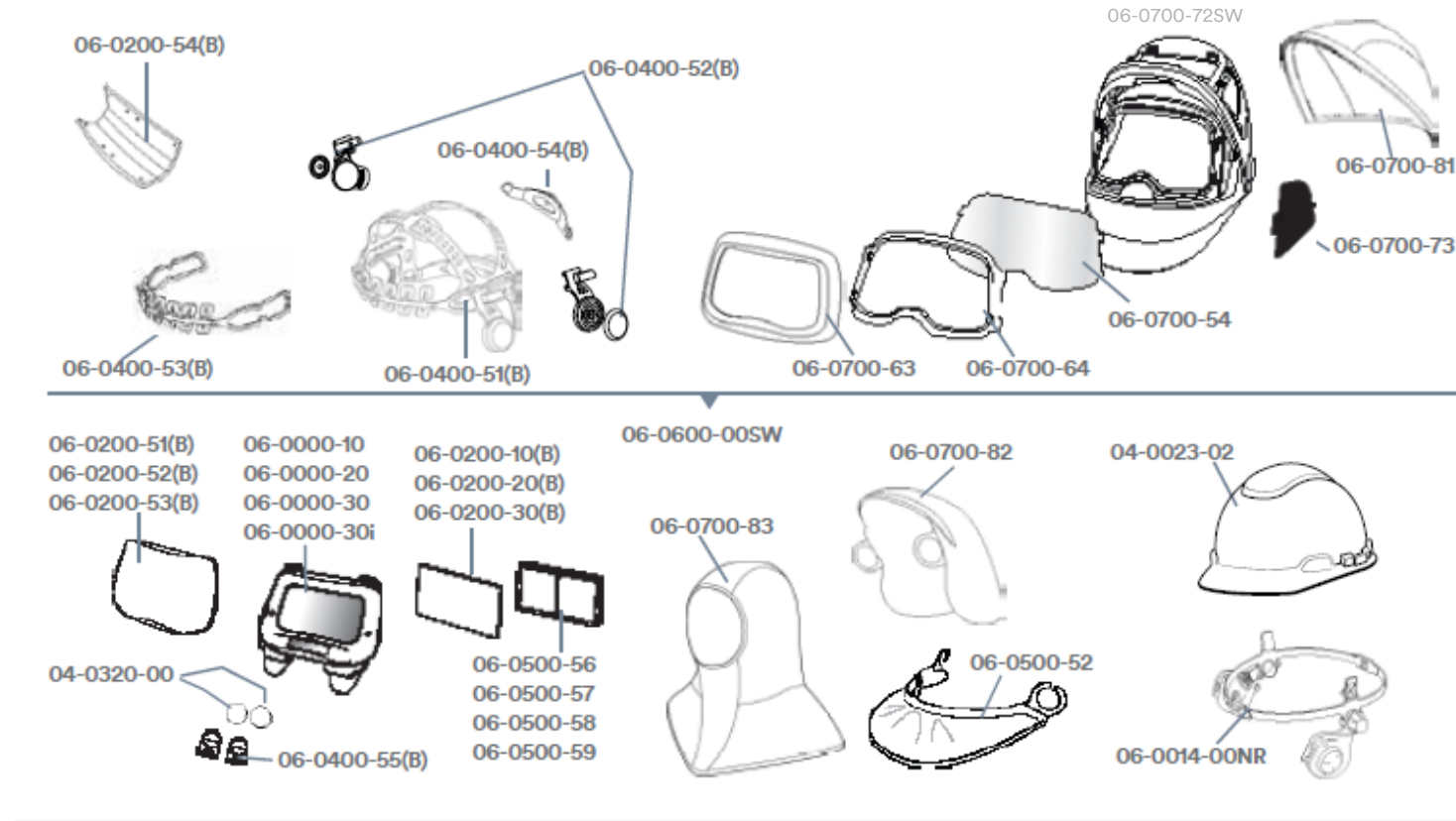



Personal Safety Division

3M Center, Building 235-2W-70
St. Paul, MN 55144-1000
USA

Phone 1-800-328-1667

Web www.3M.com/workersafety

3M PSD products are occupational use only.

3M Personal Safety
Service & Technical Support Center

1-800-243-4630 or visit www.3M.com/workersafety

For a complete listing of parts, visit us at:
www.3M.com/weldingsafety

Note: Welding can create a variety of harmful fumes and gases. When engineering controls are impractical, respirators may be required to help reduce exposures to these airborne welding contaminants.

3M, Speedglas and Adflo are trademarks of 3M.
Used under license in Canada.

Please recycle. Printed in U.S.A. © 3M 2016.



⚠ WARNING

These respirators help protect against certain airborne contaminants. Before use, the wearer must read and understand the User Instructions provided as a part of the product packaging. A written respiratory protection program must be implemented meeting all the requirements of OSHA 1910.134 including training, fit testing and medical evaluation. In Canada, CSA standards Z94.4 requirements must be met and/or requirements of the applicable jurisdiction, as appropriate. Misuse may result in sickness or death. For proper use, see packaging instructions, supervisor, or call 3M OH&ESD Technical Service in USA at 1-800-243-4630 and in Canada at 1-800-267-4414.

⚠ WARNING

This product is designed to help protect the wearer's eyes and face from harmful radiation including visible light, ultra-violet radiation (UV), infra-red radiation (IR), sparks and spatter resulting from welding processes. These products must be used only by qualified persons who are properly trained in their use and maintenance. Misuse may result in permanent eye injury and vision loss. Always wear ANSI Z87.1 compliant safety spectacles in addition to any welding helmet. For proper use, see supervisor, or User Instructions or call 3M in U.S.A. 1-800-243-4630. In Canada, call Technical Service at 1-800-267-4414.